

CITY CLERK DEPT.

2016 JAN -6 PM 2: 22

**CITY OF EL PASO, TEXAS
AGENDA ITEM
DEPARTMENT HEAD SUMMARY FORM**

DEPARTMENT: Capital Improvement Department

AGENDA DATE: January 12, 2016

CONTACT PERSON NAME AND PHONE NUMBER: Monica Lombraña, A.A.E. Capital Improvement Director 212-1831

DISTRICT(S) AFFECTED: 8

SUBJECT:

A resolution that the City Manager be authorized to sign a Multipurpose Use Agreement between the State of Texas, by and between the Texas Department of Transportation and the City of El Paso to permit the construction, maintenance and operation of a public streetcar project known as the El Paso Streetcar Project on the highway right of way of SH 20 (Texas Avenue) at the intersection of Kansas Street; on the highway right of way of SH 20 (Mesa Street) at the intersections of Baltimore Drive and Franklin Avenue; on the highway right of way of US 62 (Paisano Drive) at the intersections of Santa Fe Street and Kansas Street; on the highway right of way of US 62 (El Paso Street) at the intersection of Father Rahm Avenue, and on the highway right of way of US 85 (Stanton Street) at the intersection of Father Rahm Avenue in El Paso, Texas.

BACKGROUND / DISCUSSION:

The Texas Department of Transportation has indicated its willingness to approve the establishment of the El Paso Streetcar Project on the condition that the City will enter into Multiple Use Agreements for the purpose of determining the respective responsibilities of the City and the Texas Department of Transportation, and on the condition that such uses are in the public interest and will not damage the highway facilities, impair safety, impede maintenance or in any way restrict the operation of the highway facility. This agreement is required by the Texas Department of Transportation (TxDOT) to allow the city to construct, maintain and operate a public streetcar on TxDOT right-of-way. The agreement pertains to the following locations: on Texas Avenue at Kansas Street; on Mesa Street at Baltimore Drive and at Franklin Avenue; on Paisano Drive at Santa Fe Street and at Kansas Street; on El Paso Street at Father Rahm Avenue; and on Stanton Street at Father Rahm Avenue.

PRIOR COUNCIL ACTION:

AMOUNT AND SOURCE OF FUNDING:

BOARD / COMMISSION ACTION:

N/A

*****REQUIRED AUTHORIZATION*****

DEPARTMENT HEAD:

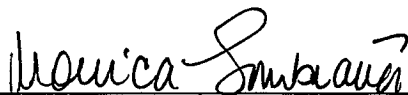

(If Department Head Summary Form is initiated by Purchasing, client department should sign also)

2016 JAN -6 PM 2:22

RESOLUTION

WHEREAS, City has requested permission from the Texas Department of Transportation to construct, maintain and operate a public streetcar project on the highway right of way of SH 20 (Texas Avenue) at the intersection of Kansas Street; on the highway right of way of SH 20 (Mesa Street) at the intersections of Baltimore Drive and Franklin Avenue; on the highway right of way of US 62 (Paisano Drive) at the intersections of Santa Fe Street and Kansas Street; on the highway right of way of US 62 (El Paso Street) at the intersection of Father Rahm Avenue, and on the highway right of way of US 85 (Stanton Street) at Father Rahm Avenue, in El Paso, Texas; and

WHEREAS, the Texas Department of Transportation has indicated its willingness to approve the establishment of the El Paso Streetcar Project on the condition that the City will enter into agreements for the purpose of determining the respective responsibilities of the City and the Texas Department of Transportation, and on the condition that such uses are in the public interest and will not damage the highway facilities, impair safety, impede maintenance or in any way restrict the operation of the highway facility.

NOW, THEREFORE, BE IT RESOLVED BY THE CITY COUNCIL OF THE CITY OF EL PASO:

That the City Manager be authorized to sign a Multipurpose Use Agreement between the State of Texas, by and between the Texas Department of Transportation and the City of El Paso to permit the construction, maintenance and operation of a public streetcar project known as the El Paso Streetcar Project on the highway right of way of SH 20 (Texas Avenue) at the intersection of Kansas Street; on the highway right of way of SH 20 (Mesa Street) at the intersections of Baltimore Drive and Franklin Avenue; on the highway right of way of US 62 (Paisano Drive) at the intersections of Santa Fe Street and Kansas Street; on the highway right of way of US 62 (El Paso Street) at the intersection of Father Rahm Avenue, and on the highway right of way of US 85 (Stanton Street) at the intersection of Father Rahm Avenue in El Paso, Texas.

APPROVED AND ADOPTED this ____ day of _____, 2016.

THE CITY OF EL PASO

Oscar Leaser
Mayor

ATTEST:

Richarda Duffy Momsen
City Clerk

APPROVED AS TO FORM:

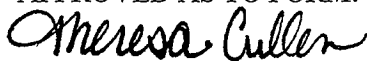

Theresa Cullen
Deputy City Attorney

APPROVED AS TO CONTENT:

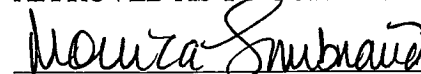

Monica Lombraña, Director
Capital Improvement Department

APPROVED AS TO CONTENT:

Jay Banasiak, Director
Mass Transit Department

CITY CLERK DEPT.

MULTIPLE USE AGREEMENT 2016 JAN -6 PM 2: 22

STATE OF TEXAS §

COUNTY OF TRAVIS §

THIS AGREEMENT made by the State of Texas by and between the Texas Department of Transportation, hereinafter referred to as "State", party of the first part, and The City of El Paso hereinafter called the "City", party of the second part, is to become effective when fully executed by both parties.

WITNESSETH

WHEREAS, on the ____ day of _____, 20____, the governing body for the City, entered into Resolution, hereinafter identified by reference, authorizing the City's participation in this agreement with the State; and

WHEREAS, the City has requested the State to permit the construction, maintenance and operation of a public streetcar project on the highway right of way of **SH 20 (Texas Avenue)** at the intersection of **Kansas Street; SH 20 (Mesa Street)** at the intersections of **Baltimore Drive** and **Franklin Avenue**; on the highway right of way of **US 62 (Paisano Drive)** at the intersections of **Santa Fe Street** and **Kansas Street**; on the highway right of way of **US 62 (El Paso Street)** at the intersection of **Father Rahm Avenue**, and on the highway right of way of **US 85 (Stanton Street)** at the intersection of **Father Rahm Avenue** in El Paso, Texas, referred to as the El Paso Streetcar Project. shown graphically by the preliminary conceptual site plan in Exhibit "A" and being more depicted on Exhibit "B", which are attached and made a part hereof; and

WHEREAS, the State has indicated its willingness to approve the establishment of the Streetcar Project conditioned that the City will enter into agreements with the state for the purpose of determining the respective responsibilities of the City and the State with reference thereto, and conditioned that such uses are in the public interest and will not damage the highway facilities, impair safety, impede maintenance or in any way restrict the operation of the highway facility, all as determined from engineering and traffic investigations conducted by the state.

AGREEMENT

NOW, THEREFORE, in consideration of the premises and of the mutual covenants and agreements of the parties hereto to be by them respectively kept and performed as hereinafter set forth, it is agreed as follows:

1. DESIGN AND CONSTRUCTION

The City has provided the construction plans for the streetcar facility, and will provide for the construction work of the Streetcar Project as required by said plans. Said plans shall include the design of the access control, necessary horizontal and vertical clearances for highway structures, rail facilities, adequate landscape treatment, adequate detail to ensure compliance with applicable structural design standards, sufficient traffic control provisions, and general layout. The plans shall also delineate and define the construction and maintenance responsibilities of both parties hereto. Completed plans will be submitted to State for review and approval and when approved shall be attached to the agreement and made a part thereof in all respects. Construction shall not commence until plans have been approved by the State. Any future revisions or additions shall be made after prior written approval of the State. Any sidewalks, curb ramps, and other pedestrian elements to be constructed, either on or off site, by the City shall be in accordance with the requirements of Title II of the Americans With Disabilities Act (ADA) and with the Texas Accessibility Standards (TAS). Elements constructed by the City and found not to comply with ADA or TAS shall be corrected at the entire expense of the City.

2. INSPECTION

Ingress and egress shall be allowed at all times to such streetcar facility for Federal Highway Administration personnel and State Forces and equipment when highway maintenance operations are necessary, and for inspection purposes; and upon request, all parking or other activities for periods required for such operations will be prohibited.

3. PARKING REGULATIONS

Parking regulations shall be established limiting parking to single unit motor vehicles of size and capacity no greater than prescribed for 1¹/₂ ton trucks, such vehicles to conform in size and use to governing laws. Parking shall be permitted only in marked spaces.

Parking shall be prohibited when a security threat, as determined by TxDOT, exists.

4. PROHIBITION/SIGNS

Regulations shall be established prohibiting the parking of vehicles transporting flammable or explosive loads and prohibiting use of the area in any manner for peddling, advertising or other purposes not in keeping with the objective of a public facility. The erection of signs other than those

required for proper use of the area will be prohibited. All signs shall be approved by the State prior to the actual erection.

5. RESPONSIBILITIES

Timely maintenance, repair and operation of the streetcar facility shall be entirely the responsibility of the City. Such responsibility shall not be transferred, assigned or conveyed to a third party without the advanced written approval of the State, provided that nothing herein prohibits the City from obtaining the services of a contractor for the operation or for the maintenance of the streetcar facility after written notice thereof to the State. These responsibilities expressly include the timely maintenance and repair of any portion of the streetcar facility necessary to comply with the Americans with Disabilities Act. Further, such responsibility shall include picking up trash, mowing and otherwise keeping the streetcar facility in a clean and sanitary condition, and surveillance by police patrol to eliminate the possible creation of a nuisance or hazard to the public. Hazardous or unreasonably objectionable smoke, fumes, vapor or odors shall not be permitted to rise above the grade line of the highway, nor shall the streetcar facility subject the highway to hazardous or unreasonably objectionable dripping, droppings or discharge of any kind, including rain or snow.

If the State determines that City has failed to comply with these responsibilities, it will perform the necessary work and charge City the actual cost of the work.

6. FEES

Any fees levied by the City for use of the streetcar facilities, other than streetcar fares, in the area shall be nominal and no more than are sufficient to defray the cost of construction, maintenance and operations thereof, and shall be subject to State approval.

A. Retention Period. The City shall maintain all books, documents, papers, accounting records and other evidence pertaining to fees, other than the streetcar fares collected and costs (hereinafter called the Records). The City shall make the records available during the term of the Agreement and for four years from the date the Agreement is terminated, until completion of all audits, or until pending litigation has been completely and fully resolved, whichever occurs last.

B. Audit Report. If fees, other than the streetcar fares are collected by the City for the use of the streetcar facility under this agreement, the City will provide the State an annual audit report detailing the fees collected for the use of the streetcar facility and the costs associated with constructing, maintaining, and operating the streetcar facility within the same period. If the report shows more fees, other than the streetcar fares collected than expenses for the construction, operation, or maintenance of the streetcar facility the City must provide a multiple year plan detailing how the additional revenue will be used for construction, operation, or maintenance of the streetcar facility.

C. Availability. The State or any of its duly authorized representatives, the Federal Highway Administration, the United States Department of Transportation, Office of Inspector General, and the Comptroller General shall have access to the City's records that are directly pertinent to this Agreement for the purpose of making audits and examinations.

7. TERMINATION UPON NOTICE

This provision is expressly made subject to the rights herein granted to both parties to terminate this agreement upon written notice, and upon the exercise of any such right by either party, all obligations herein to make improvements to said streetcar facility shall immediately cease and terminate and City shall be responsible for the streetcar facility's timely removal at no cost to the State. If the State determines that City has not complied with the plan approved under Paragraph 10 to remove the streetcar facility, it will perform the necessary work and charge City the actual cost of the work.

8. MODIFICATION/TERMINATION OF AGREEMENT

If in the sole judgment of the State it is found at any future time that traffic conditions have so changed that the existence or use of the streetcar facility is impeding maintenance, damaging the highway facility, impairing safety or that the streetcar facility is not being properly operated, that it constitutes a nuisance, is abandoned, or if for any other reason it is the State's judgment that such streetcar facility is not in the public interest, this agreement under which the streetcar facility was constructed may be : (1) modified if corrective measures acceptable to both parties can be applied to eliminate the objectionable features of the streetcar facility; or (2) terminated and the use of the area as proposed herein discontinued.

9. PROHIBITION OF STORAGE OF FLAMMABLE MATERIALS

All structures located or constructed within the area covered by the agreement shall be fire resistant. The storage of flammable, explosive or hazardous materials is prohibited. Operations deemed to be a potential fire hazard shall be subject to regulation by the State.

10. RESTORATION OF AREA

The City shall provide written notification to the State that such streetcar facility will be discontinued for the purpose defined herein. The City shall, within thirty (30) days from the date of said notification or notification from the State of the termination of this agreement, provide a plan to clear the area of all streetcar facilities that were its construction responsibility under this agreement. Upon approval of the plan, the City must comply with the approved plan and restore the area **within thirty (30) months of the approved plan** to a condition satisfactory to the State.

11. PREVIOUS AGREEMENTS

It is understood that this agreement in no way modifies or supersedes the terms and provisions of any existing agreements between the parties hereto.

12. INDEMNIFICATION

No party to this agreement intends to waive, relinquish, limit or condition its general governmental immunity from liability in any way.

Each party agrees and acknowledges that it is not an agent, servant, or employee of the other party. Each party is responsible only for its own acts and for those of its agents, servants, independent contractors or employees. Such responsibility includes, but is not limited to any claims or amounts arising or recovered under the "Workers Compensation Law," the Texas Tort Claims Act, Chapter 101, Texas Civil Practice and Remedies Code; or any other applicable laws or regulations, all as time to time may be amended.

Nothing in this agreement shall be construed as creating any liability in favor of any third party against the State and the City. Additionally, this agreement shall not ever be construed as relieving any third party from any liability in favor of the State and the City. Furthermore, the City shall become subrogated to the State's rights of recovery. Both, however, shall be entitled to maintain any action over and against any third party who may be liable for damages. Both parties agree to cooperate in the pursuit of any claims on behalf of the State or the City and to execute and deliver instruments and papers and to otherwise do that which is necessary to secure such rights.

13. INSURANCE

The City shall provide necessary safeguards to protect the public on State maintained highways including adequate insurance for payment of any damages which might result during the construction, maintenance, repair and operation of the streetcar facility. Prior to beginning work on the State's right of way, the construction contractor of the City or the Camino Real Regional Mobility Authority shall submit to the State a completed insurance form (TxDOT Form No. 1560) or appropriate certificate of self-insurance and shall maintain the required coverage during the construction of the streetcar facility.

14. USE OF RIGHT OF WAY

It is understood that the State by execution of this agreement does not impair or relinquish the State's right to use such land for highway purposes when it is required for the construction or re-construction of the traffic facility for which it was acquired, nor shall use of the land under such agreement ever be construed as abandonment by the State of such land acquired for highway purposes, and the State does not purport to grant any interest in the land described herein but merely consents to such use to the extent its authority and title permits.

15. ADDITIONAL CONSENT REQUIRED

The State asserts only that it has sufficient title for highway purposes. The City shall be responsible for obtaining such additional consent, permits or agreement as may be necessary due to this agreement. This includes, but is not limited to, appropriate permits and clearances for environmental, ADA and public utilities.

16. FHWA ADDITIONAL REQUIREMENTS

If the Facility is located on the Federal-Aid Highway System, "ATTACHMENT A", which states additional requirements as set forth in the Federal Highway Administration's Title 23, Code of Federal Regulations, § 710, shall be attached to and become a part of this agreement.

17. CIVIL RIGHTS ASSURANCES

The City, for itself, its personal representatives, successors and interests and assigns, as part of the consideration hereof, does hereby covenant and agree as a covenant running with the land that: (1) no persons, on the grounds of race, color, sex, age, national origin, religion or disabling condition, shall be excluded from participation in, be denied the benefits of, or be otherwise subjected to discrimination in the use of said streetcar facility; (2) that in the construction of any improvements on, over or under such land and the furnishing of services thereon, no person on the ground of race, color, sex, age, national origin, religion or disabling condition, shall be excluded from participation in, denied the benefits of, or otherwise be subjected to discrimination; (3) that the City shall use the premises in compliance with all other requirements imposed by or pursuant to Title 49, Code of Federal Regulations, Department of Transportation, Subtitle A, Office of the Secretary, Part 21, Non-discrimination in Federally-Assisted programs of the Department of Transportation - Effectuation of Title VI of the Civil Rights Act of 1964, and as said Regulations may be amended.

That if in the event of any breach of the above non-discrimination covenants, the State shall have the right to terminate the agreement and reenter and repossess said land and the streetcar facilities thereon, and hold the same as if said agreement had never been made or issued.

18. AMENDMENTS

Any changes in the time frame, character or responsibilities of the parties hereto shall be enacted by a written amendment executed by both parties hereto.

19. LEGAL CONSTRUCTION

In case one or more of the provisions contained in this agreement shall for any reason be held invalid, illegal or unenforceable in any respect, such invalidity, illegality or unenforceability shall not affect any provision hereof and this agreement shall be construed as if such invalid, illegal, or unenforceable provision had never been contained in this agreement.

20. AUDIT

The State may conduct an audit or investigation of any aspect of this agreement. The City must provide the State with access to any information the State considers relevant to the investigation or audit. The audit can include, but is not limited to, any contract for construction or maintenance of any facility or structure authorized by this agreement or any contract to provide a service to the City if that service is authorized by this agreement.

21. AUTHORITY OF STATE AUDITOR

The state auditor may conduct an audit or investigation of any entity receiving funds from the state directly under the contract or indirectly through a subcontract under the contract. Acceptance of funds directly under the contract or indirectly through a subcontract under this contract acts as acceptance of the authority of the state auditor, under the direction of the legislative audit committee, to conduct an audit or investigation in connection with those funds. An entity that is the subject of an audit or investigation must provide the state auditor with access to any information the state auditor considers relevant to the investigation or audit.

22. NOTICES

All notices required under this agreement shall be mailed or hand delivered to the following respective addresses:

STATE

Texas Department of Transportation
Maintenance Division
125 East 11th Street
Austin, Texas 78701-2483

City of El Paso

City of El Paso
Attn: City Manager
P. O. Box 1890
El Paso, Texas 79950-1890

23. TIMELY PAYMENT

When required by any provision of this agreement requires a payment to be made to the State, the other party hereto shall within **ninety (90) days** from receipt of the State's written notification pay the State for the full cost of repairing any damages to the highway facility which may result from the other party's construction, maintenance, repair or operation of the facility.

24. WARRANTS

The signatories to this agreement warrant that each has the authority to enter into this agreement on behalf of the party represented.

List of Attached Exhibits:

Exhibit A – General Layout
Exhibit B – Control Sheet and Plan and Profile Sheets
Exhibit C – Approved Construction Plans
Exhibit D – Certificate of Insurance (TxDOT Form 1560)
Exhibit E – Attachment A (FHWA Additional Requirements)

CITY CLERK DEPT.

2016 JAN -6 PM 2: 22

IN WITNESS WHEREOF, the parties have hereunto affixed their signature, the _____
_____ on the _____ day of _____, 20_____, and the State
_____ on the _____ day of _____, 20_____.

STATE OF TEXAS

Executed and approved for the Texas
Transportation Commission for the purpose
and effect of activating and/or carrying out
the orders, and established policies or work
programs heretofore approved and
authorized by the Texas Transportation
Commission.

City of El Paso, Texas
(Name of other party)

By: _____
Title

Printed Name

Date

Contact Office and Telephone No.

By: _____ Michael Lee, P.E.
Director, Maintenance Division

Printed Name

Date

APPROVED AS TO FORM:

Theresa Cullen
Signature

Theresa Cullen
Printed Name

APPROVED AS TO CONTENT:

Signature

Signature

APPROVAL RECOMMENDED

District Engineer

Robert Bielek, DPA, P.E.
Printed Name

Date

EXHIBIT A
GENERAL LAYOUT

INDEX OF SHEETS

SHEET NO.	DESCRIPTION
1	TITLE SHEET
2-10	INDEX OF SHEETS

TxDOT MUA - Exhibit A
 SH 20 (Texas Ave.) at Kansas St.
 SH 20 (Mesa St.) at Baltimore Dr
 SH 20 (Mesa St.) at Franklin Ave.
 US 62 (Paisano Dr.) at Santa Fe St.
 US 62 (Paisano Dr.) at Kansas St.
 US 62 (El Paso St.) at Father Rahm Ave.
 US 85 (Stanton St.) at Father Rahm Ave.

REGISTERED ACCESSIBILITY SPECIALIST (RAS)
 INSPECTION REQUIRED
 TDLR No. EABPRJB5819210

REQUIRED SIGNS SHALL BE IN ACCORDANCE WITH
 BC (11)- 14 THRU BC (12)- 14 AND THE "TEXAS
 MANUAL ON UNIFORM TRAFFIC CONTROL DEVICES".

CAMINO REAL REGIONAL MOBILITY AUTHORITY

PLANS OF PROPOSED URBAN STREETCAR

PROJECT NO. ()

CITY OF EL PASO STREETCAR EL PASO COUNTY

VOLUME 1 OF 4 - CIVIL/TRACK

FOR THE CONSTRUCTION OF AN URBAN STREETCAR SYSTEM CONSISTING OF
 GRADING, STRUCTURES, SURFACE AND SUBSURFACE IMPROVEMENTS,
 TRACKWORK, AND MAINTENANCE/STORAGE FACILITY

STATE PROJECT NO.			
CON	SECT	JOB	HIGHWAY
092406	446	VARIOUS	
DIST	COUNTY	SHEET NO.	
EL PASO	EL PASO	1	

FINAL PLANS

LETTING DATE: _____
 DATE CONTRACTOR BEGAN WORK: _____
 DATE WORK WAS COMPLETED & ACCEPTED: _____
 FINAL CONTRACT COST: \$ _____
 CONTRACTOR: _____

URS

2829 Montana Suite 206
 El Paso, Texas 79903
 (915) 493-6468

TBPE REGISTRATION NO. F-3162



SUBMITTED FOR LETTING: _____

PROJECT MANAGER
 CAMINO REAL REGIONAL MOBILITY AUTHORITY

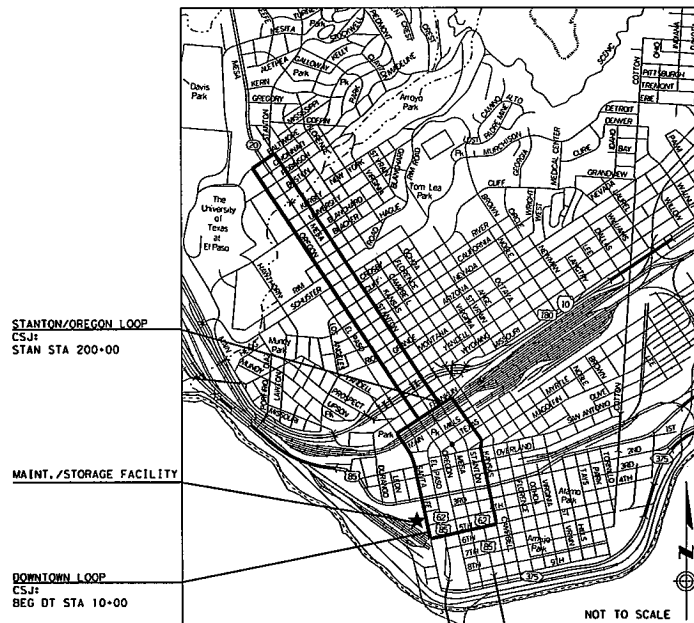

LIMITS:

DOWNTOWN LOOP LIMITS:

FROM INTERSECTION OF FATHER RAHM AVE AND SANTA FE ST. ALONG
 SANTA FE ST TO FRANKLIN AVE, ALONG FRANKLIN AVE TO KANSAS ST,
 ALONG KANSAS ST TO FATHER RAHM AVE, ALONG FATHER RAHM AVE TO
 SANTA FE ST.

STANTON/OREGON LOOP LIMITS:

FROM INTERSECTION OF STANTON ST AND FRANKLIN AVE, ALONG
 STANTON TO BALTIMORE DR, ALONG BALTIMORE DR TO OREGON ST,
 ALONG OREGON ST TO FRANKLIN AVE.

COUNTY: _____ PROJ. NO.: _____
 DATE: _____ LETTING DATE: _____
 DATE ACCEPTED: _____

142

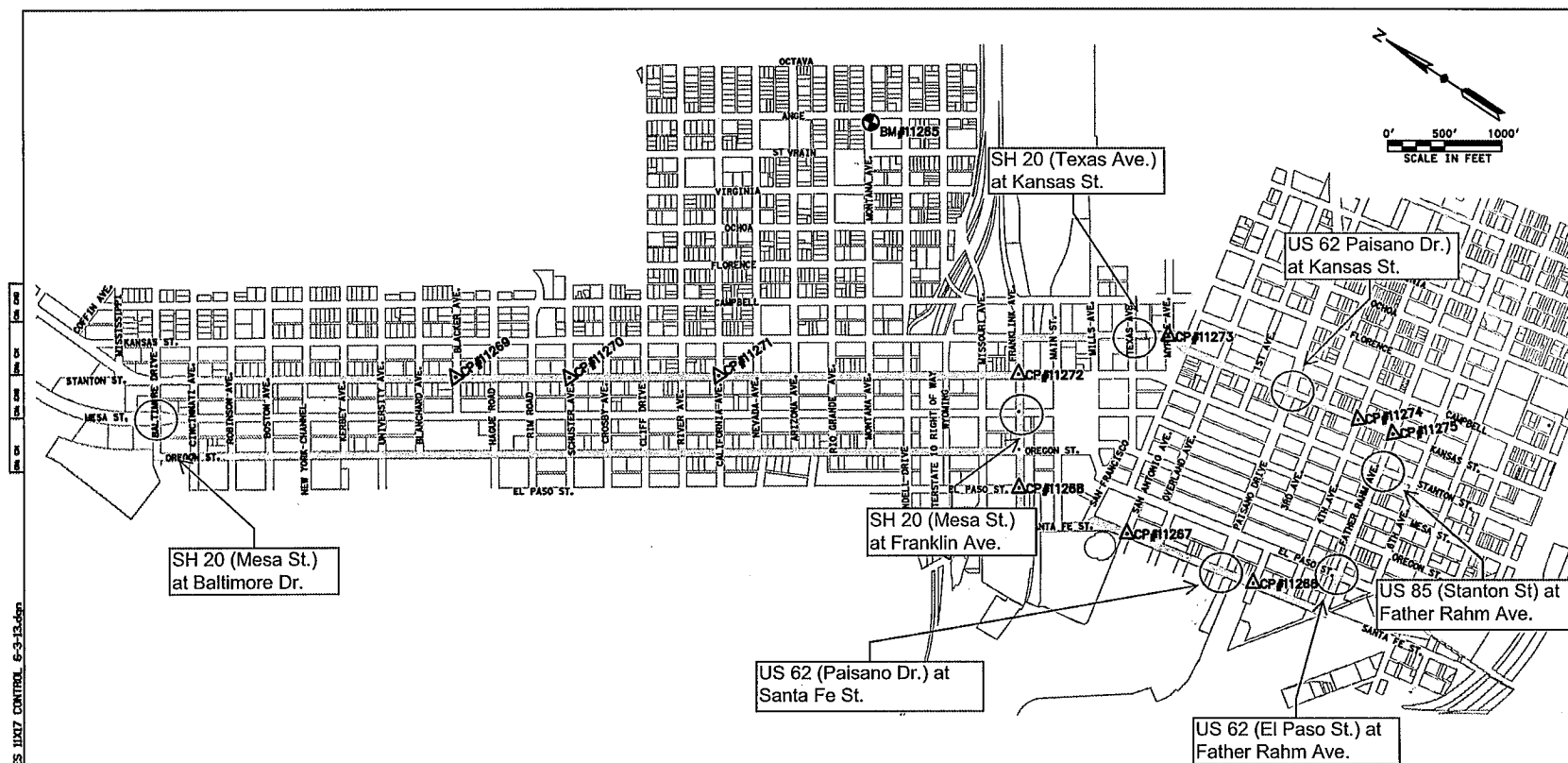

EXHIBIT B
CONTROL SHEET AND PLAN AND
PROFILE SHEET

INDEX OF SHEETS

SHEET NO.	DESCRIPTION
1	TITLE SHEET
2-10	INDEX OF SHEETS

TxDOT MUA no. _____ - Exhibit B
SH 20 (Texas Avenue) at Kansas Street

REGISTERED ACCESSIBILITY SPECIALIST (RAS)
INSPECTION REQUIRED
TDLR No. EABPRJB5819210

REQUIRED SIGNS SHALL BE IN ACCORDANCE WITH
BC (11)- 14 THRU BC (12)- 14 AND THE "TEXAS
MANUAL ON UNIFORM TRAFFIC CONTROL DEVICES".

CAMINO REAL REGIONAL MOBILITY AUTHORITY

PLANS OF PROPOSED URBAN STREETCAR

PROJECT NO. ()

CITY OF EL PASO STREETCAR EL PASO COUNTY

VOLUME 1 OF 4 - CIVIL/TRACK

FOR THE CONSTRUCTION OF AN URBAN STREETCAR SYSTEM CONSISTING OF
GRADING, STRUCTURES, SURFACE AND SUBSURFACE IMPROVEMENTS,
TRACKWORK, AND MAINTENANCE/STORAGE FACILITY

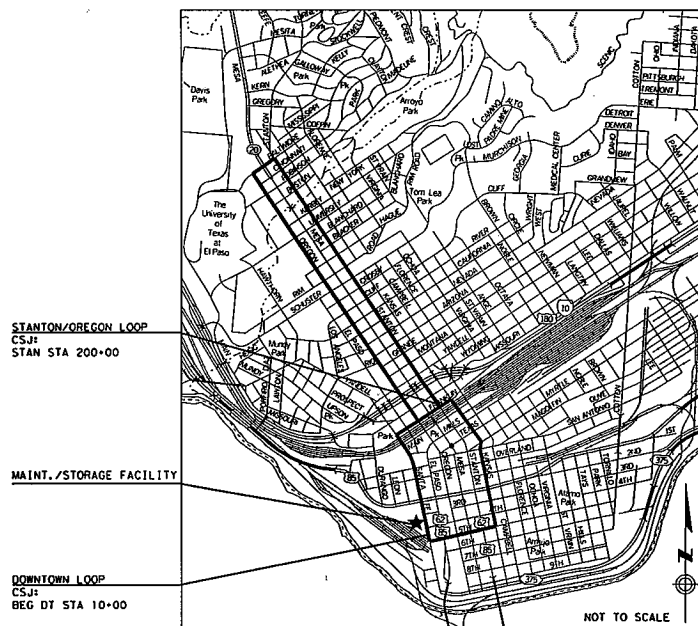

LIMITS:

DOWNTOWN LOOP LIMITS:

FROM INTERSECTION OF FATHER RAHM AVE AND SANTA FE ST, ALONG
SANTA FE ST TO FRANKLIN AVE, ALONG FRANKLIN AVE TO KANSAS ST,
ALONG KANSAS ST TO FATHER RAHM AVE, ALONG FATHER RAHM AVE TO
SANTA FE ST.

STANTON/OREGON LOOP LIMITS:

FROM INTERSECTION OF STANTON ST AND FRANKLIN AVE, ALONG
STANTON TO BALTIMORE DR, ALONG BALTIMORE DR TO OREGON ST,
ALONG OREGON ST TO FRANKLIN AVE.

STATE PROJECT NO.			
()			
CONT	SECT	JOB	HIGHWAY
0924	06	446	VARIOUS
DIST	COUNTY	SHEET NO.	
EL PASO	EL PASO	1	

FINAL PLANS

LETTING DATE: _____
DATE CONTRACTOR BEGAN WORK: _____
DATE WORK WAS COMPLETED & ACCEPTED: _____
FINAL CONTRACT COST: \$ _____
CONTRACTOR: _____

URS

2829 Montana Suite 206
El Paso, Texas 79903
(915) 493-6468

TBPE REGISTRATION NO. F-3162



SUBMITTED FOR LETTING: _____

PROJECT MANAGER
CAMINO REAL REGIONAL MOBILITY AUTHORITY

COUNTY: _____ PROJ. NO. _____
DATE ACCEPTED: _____ LETTING DATE: _____

10/28

DATE: 06-03-03 EGM
 FILE: KA 00242002-URS-EL PASO-CAR-STREET-28-1-4 Final PLAT UTILITIES 1117 CONTROL 6-3-13.dgn

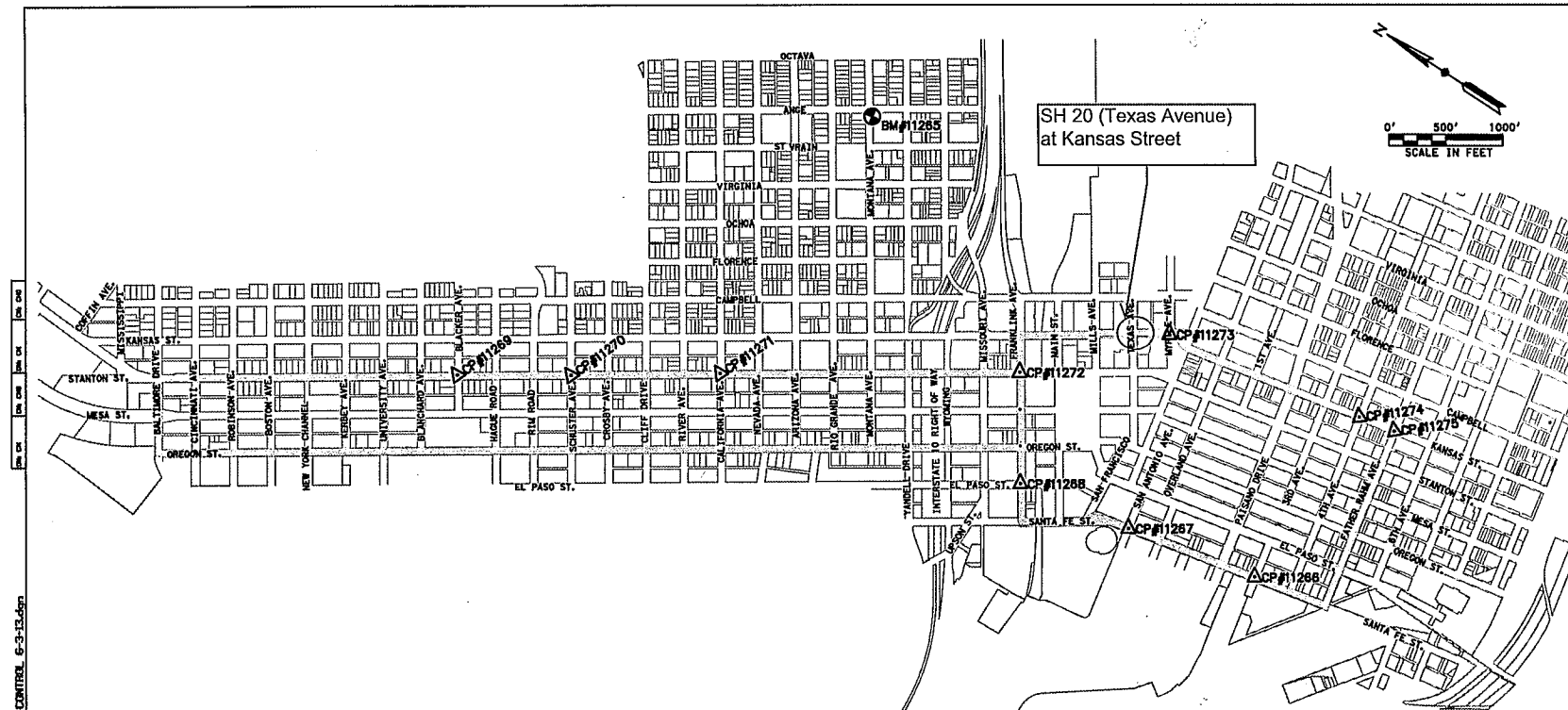

LEGEND

BENCHMARK
 CONTROL POINT

NOTE:

1. HORIZONTAL CONTROL: MAPPING COORDINATES AND BEARINGS ARE REFERENCED TO THE TEXAS COORDINATE SYSTEM, NORTH TEXAS CENTRAL ZONE 4203, NAD83. UNIT OF MEASURE: U.S. SURVEY FOOT. COORDINATES SHOWN HEREON ARE GRID (STATE PLANE).

2. VERTICAL CONTROL IS BASED ON NAVD 88 DATUM, ELEVATION RECOVERED FROM NGS MONUMENT:

BM#11265
 DESIGNATION: P 146

DESCRIPTION:
 IN EL PASO, AT THE INTERSECTION OF ANGE ST. AND MONTANA AVE., IN A CONCRETE CURB ALONG THE SOUTHEAST SIDE OF THE AVENUE, 19.2 M (63.0 FT) SOUTHWEST OF THE STREET CENTER, 7.6 M (24.9 FT) SOUTHEAST OF AND LEVEL WITH THE AVENUE CENTERLINE, AND 5.5 M (18.0 FT) SOUTHWEST OF A UTILITY POLE.

ELEVATION = 3742.24

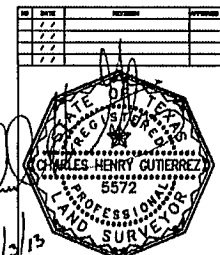

FRANK K. SPENCER & ASSOCIATES, INC.
 (Incorporated 1988) Engineers & Surveyors
 1120 MONTANA AVE.
 EL PASO, TX 79903
 PH (915) 523-4600
 FAX (915) 523-4872
 www.fksa.com

URS
 2829 Montana Suite 200
 El Paso, Texas 79903
 (915) 452-6468

TYPE REGISTRATION NO. P-2483

COEP STREETCAR

CONTROL SHEET



CONT.	MET.	JOB	1000000
DATE	COUNTY	SHEET NO.	VARIOUS
EL PASO	EL PASO	30	

BENCHMARKS

BM #	DESCRIPTION	NORTHING (Y)	EASTING (X)	ELEVATION (Z)
11265	FOUND BRASS CAP - NGS MONUMENT "P146"	18659667.26	385723.73	3742.24

CONTROL POINTS

CP #	DESCRIPTION	NORTHING (Y)	EASTING (X)	ELEVATION
11266	FOUND CITY MONUMENT AT INTERSECTION OF SANTA FE ST. & 3RD AVE.	18654632.82	384281.54	3789.92
11267	FOUND CITY MONUMENT AT INTERSECTION OF SANTA FE ST. & SAN ANTONIO AVE.	18655793.26	383949.68	3711.85
11268	FOUND CITY MONUMENT AT INTERSECTION OF EL PASO ST. & FRANKLIN AVE.	18656884.91	383757.25	3738.39
11269	FOUND CITY MONUMENT AT INTERSECTION OF STANTON ST & BLACKER AVE.	18661467.74	381826.16	3425.85
11270	FOUND CITY MONUMENT AT INTERSECTION OF STANTON ST & SCHUSTER AVE.	18668631.47	382374.88	3885.79
11271	FOUND CITY MONUMENT AT INTERSECTION OF STANTON ST & CALIFORNIA AVE.	18659548.84	383111.86	3794.98
11272	FOUND CITY MONUMENT AT INTERSECTION OF STANTON ST & FRANKLIN AVE.	18657385.27	384579.35	3732.88
11273	FOUND CITY MONUMENT AT INTERSECTION OF KANSAS ST & MYRTLE AVE.	18658442.44	385587.96	3718.28
11274	FOUND CITY MONUMENT AT INTERSECTION OF KANSAS ST & 4TH AVE.	18654649.39	385899.98	3787.83
11275	FOUND CITY MONUMENT AT INTERSECTION OF KANSAS ST & FATHER RAHM AVE.	18654326.34	385967.17	3786.88

IT'S THE LAW
 AND IT'S FREE - CALL BEFORE YOU DIG
 CALL TWO WORKING DAYS BEFORE YOU DIG IN TEXAS
 1-800-344-8377
 (1-800-DIG-TESS)

ES LA LEY
 GRATIS PARA USTED - LLAME ANTES DE EXCAVAR
 LLAME 2 DIAS DE TRABAJO ANTES DE EXCAVAR EN TEXAS
 1-800-344-8377
 (1-800-DIG-TESS)

20628

For this intersection, the "Gutter Pan" is defined as the line determined by the location of contact between the surface of pavement and the concrete curb.

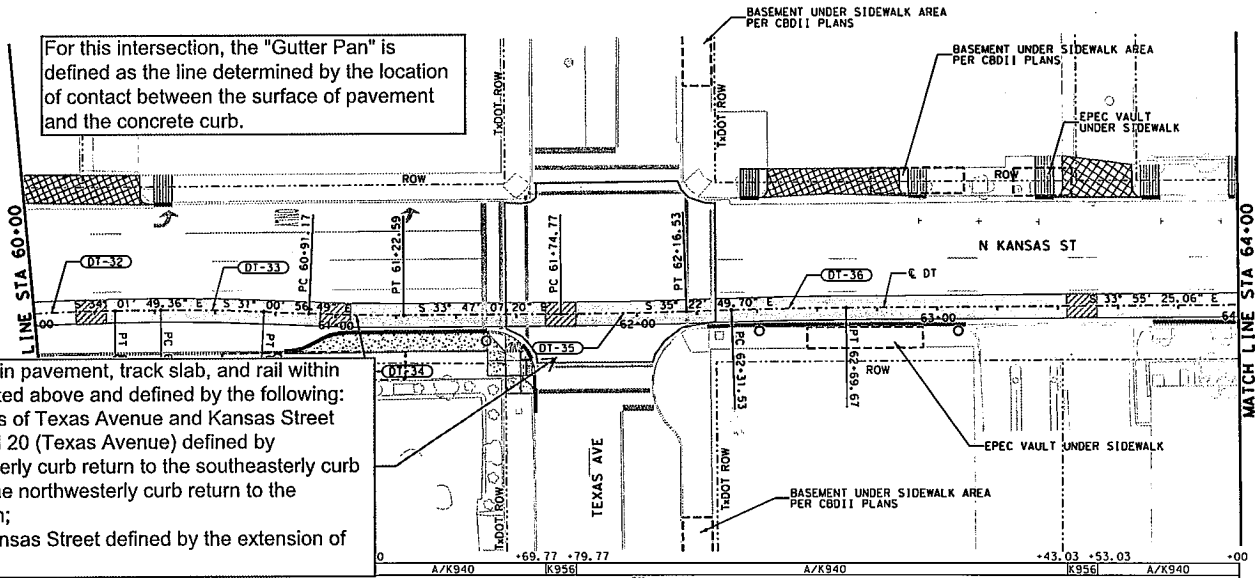

City of El Paso to maintain pavement, track slab, and rail within the intersection as depicted above and defined by the following:

- between the gutter pans of Texas Avenue and Kansas Street
- the two lines across SH 20 (Texas Avenue) defined by connecting the northeasterly curb return to the southeasterly curb return, and connecting the northwesterly curb return to the southwesterly curb return;
- the two lines across Kansas Street defined by the extension of TxDOT right of way.



LEGEND

- LIMITS OF STREET RECONSTRUCTION
- CENTERLINE STREETCAR ALIGNMENT
- TRACK SLAB
- TRACK SLAB OVER UTILITY VAULT SEE DETAIL K956
- CURVE NAME
- PROPOSED OCS POLE

- NOTES:
- SEE TRAFFIC SIGNAL SHEETS FOR TRAFFIC SIGNAL MODIFICATION.
 - SEE UTILITY SHEETS FOR EXISTING AND PROPOSED UTILITY INFORMATION.
 - REFER TO HORIZONTAL ALIGNMENT DATA SHEETS FOR CURVE DATA AND ALIGNMENT INFORMATION.
 - SEE STOP DETAIL SHEETS FOR PROPOSED STOP INFORMATION.
 - CONTRACTOR TO FIELD ADJUST TRACK SLOPE TRANSITIONS AS NECESSARY.
 - BASEMENT INFORMATION SHOWN HEREON IS APPROXIMATE AND BASED ON CBD II AND CBD III AS-BUILTS AND IDENTIFICATION OF SURFACE FEATURES ONLY.
 - EXISTING ROADWAY PROFILE MAY VARY FROM SURVEY PERFORMED SPRING 2013.
 - SEE GEOTECH REPORT FOR INFORMATION REGARDING BORE HOLES.
 - SEE STREET RECONSTRUCTION SHEETS FOR PROPOSED RECONSTRUCTION LIMITS.
 - SEE TYPICAL SECTIONS FOR WIDENED TRACK SLAB LIMITS.
 - SEE TRACK DETAIL DRAWING SERIES K940 TO K956 FOR TRACK SLAB AND SPECIAL TRACKWORK DETAILS.
 - SEE OVERHEAD CONTACT SYSTEM SHEETS FOR PROPOSED OCS POLE LAYOUT.

NO.	DATE	REVISION	APPROVED
1			
2			
3			
4			



URS
2829 Montana Suite 206
El Paso, Texas 79903
(915) 452-6068
TIME REGISTRATION NO. T-3162

COEP STREETCAR
TRACK PLAN AND PROFILE
STA 60+00 TO STA 64+00

COMP	SECT	JOB	REVISION
			VARIOUS
DIST	COUNTY	SHEET NO.	
EL PASO	EL PASO	55	

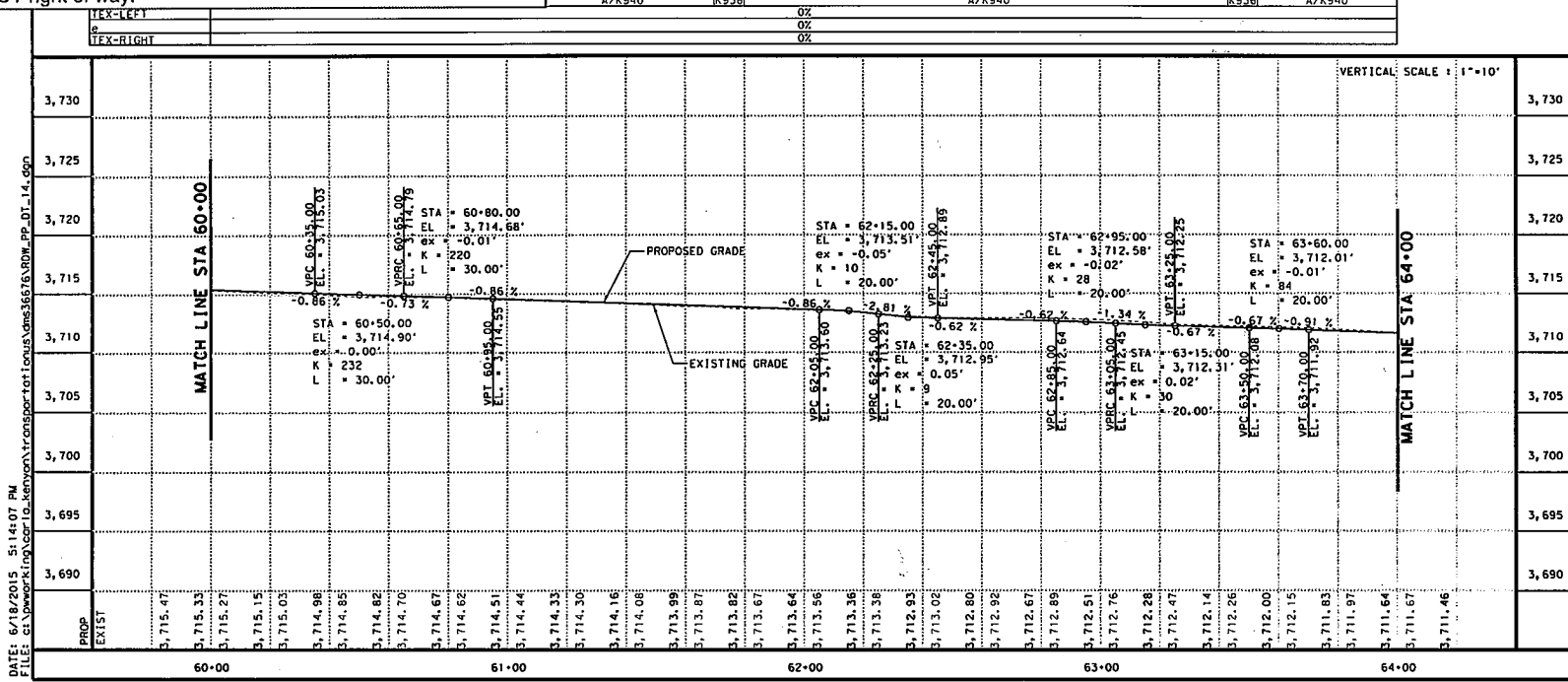

3 of 28

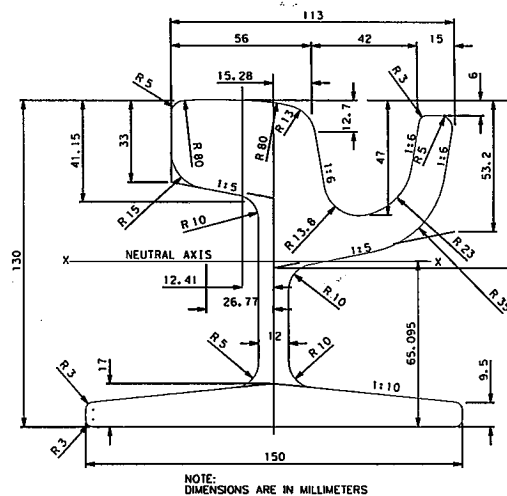
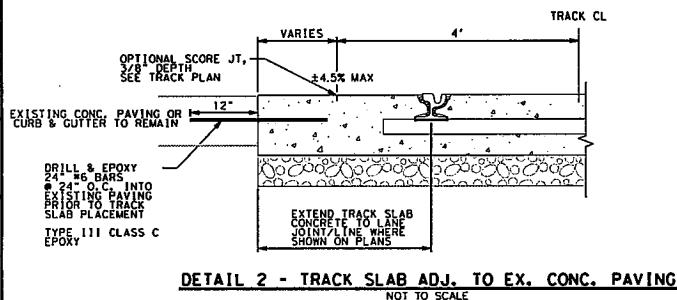
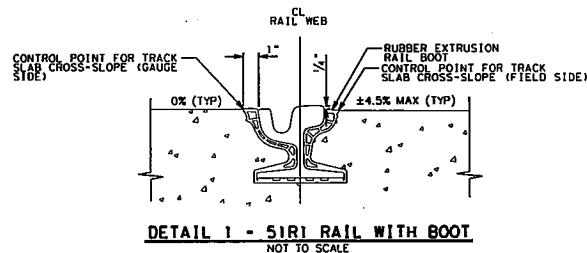
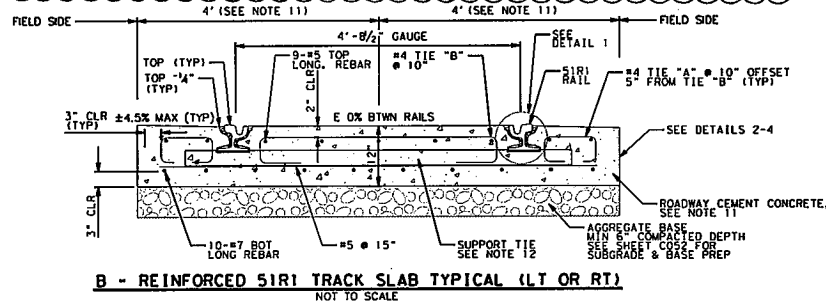

51R1 RAIL
NOT TO SCALE

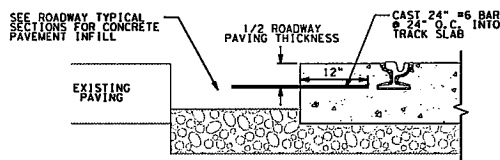
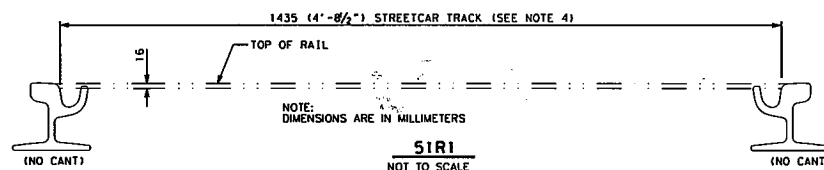

**DETAIL 3 - TRACK SLAB ADJ.
TO PROPOSED CONC. PAVING**
NOT TO SCALE

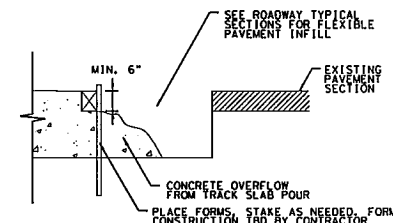

**DETAIL 4 - TRACK SLAB ADJACENT
TO PROPOSED FLEXIBLE PAVEMENT**
NOT TO SCALE

1. CONCRETE SHALL BE ROADWAY CEMENT CONCRETE UNLESS NOTED OTHERWISE.
2. REINFORCING SHALL BE UNCOATED DEFORMED BARS WITH A MINIMUM YIELD STRENGTH OF 60,000 PSI.
3. REINFORCING COVER SHALL BE 3" MINIMUM AT BASE AND SIDES OF TRACK SLAB AND 2" MINIMUM ON TOP.
4. TYPICAL TRACK GAUGE SHALL BE 4'-8 1/2".
5. AGGREGATE BASE AS REQUIRED IN SPECIFICATIONS AND AS SHOWN ON THE ROAD TYPICALS (SHEET C052)
6. JOINT GROOVES PLACED TRANSVERSELY ACROSS TRACK SLAB SHALL BE PLACED ABOVE EVERY SUPPORT TIE. GROOVE DEPTH = 3/8" MINIMUM.
7. PROPOSED PROFILE IS TOP OF LOW RAIL.
8. TOP OF CONCRETE ON FIELD SIDE OF RAIL SHALL BE 1/4" BELOW TOP OF RAIL ELEVATION.
9. TRACK PLANS INDICATE WHICH CURVES ARE SUPERELEVATED.
10. COORDINATE TRACKING POWER OR SIGNAL BOND LOCATIONS WITH SYSTEMS CONTRACTOR PRIOR TO POURING CONCRETE INFILL. SEE DWG J670 FOR BONDING BLOCKOUT DETAILS.
11. SEE TRACK PLAN FOR LIMITS OF REINFORCED TRACK SLAB, MODIFIED TRACK SLAB, AND TRANSITION RAILS, FOR VARIABLE TIES ADJACENT TO EXISTING CONCRETE PAVING SEE DETAIL B THIS SHEET
12. SUPPORT TIES SHALL BE SPACED AT 10 FOOT INTERVALS ON TANGENTS AND CURVES WITH A RADIUS LARGER THAN 500 FEET. ON CURVES WITH A RADIUS OF 500 FEET OR LESS, SUPPORT TIES SHALL BE PLACED AT 5 FOOT INTERVALS.

NO	DATE	REVISION	APPROV
	/ /		
	/ /		
	/ /		
	/ /		

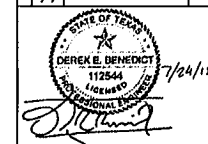

URS 2829 Montana Suite 201
El Paso, Texas 79903
(915) 493-6458

TAPE REGISTRATION NO. F-3162

COEP STREETCAR
TRACK SLAB
DETAILS



CONT	SECT	JOB	HIGHWAY
0924	06	446	VARIOUS
DIST		COUNTY	SHEET NO
EL PASO		EL PASO	122

INDEX OF SHEETS

SHEET NO.	DESCRIPTION
1	TITLE SHEET
2-10	INDEX OF SHEETS

CAMINO REAL REGIONAL MOBILITY AUTHORITY

PLANS OF PROPOSED URBAN STREETCAR

PROJECT NO. ()

CITY OF EL PASO STREETCAR EL PASO COUNTY

VOLUME 1 OF 4 - CIVIL/TRACK

FOR THE CONSTRUCTION OF AN URBAN STREETCAR SYSTEM CONSISTING OF
GRADING, STRUCTURES, SURFACE AND SUBSURFACE IMPROVEMENTS,
TRACKWORK, AND MAINTENANCE/STORAGE FACILITY

STATE PROJECT NO.			
CONT	SECT	JOB	HIGHWAY
092406		446	VARIOUS
DIST	COUNTY		SHEET NO.
EL PASO	EL PASO		1

FINAL PLANS

LETTING DATE: _____
DATE CONTRACTOR BEGAN WORK: _____
DATE WORK WAS COMPLETED & ACCEPTED: _____
FINAL CONTRACT COST: \$ _____
CONTRACTOR: _____

TxDOT MUA no. _____ - Exhibit B

SH 20 (Mesa St) at Baltimore Dr

REGISTERED ACCESSIBILITY SPECIALIST (RAS)
INSPECTION REQUIRED
TDLR No. EABPRJB5819210

REQUIRED SIGNS SHALL BE IN ACCORDANCE WITH
BC (11)-14 THRU BC (12)-14 AND THE "TEXAS
MANUAL ON UNIFORM TRAFFIC CONTROL DEVICES".

URS

2829 Montana Suite 206
El Paso, Texas 79903
(915) 493-6468

TBPE REGISTRATION NO. F-3162



CAMINO REAL
REGIONAL MOBILITY
AUTHORITY

SUBMITTED FOR LETTING: _____

PROJECT MANAGER
CAMINO REAL REGIONAL MOBILITY AUTHORITY

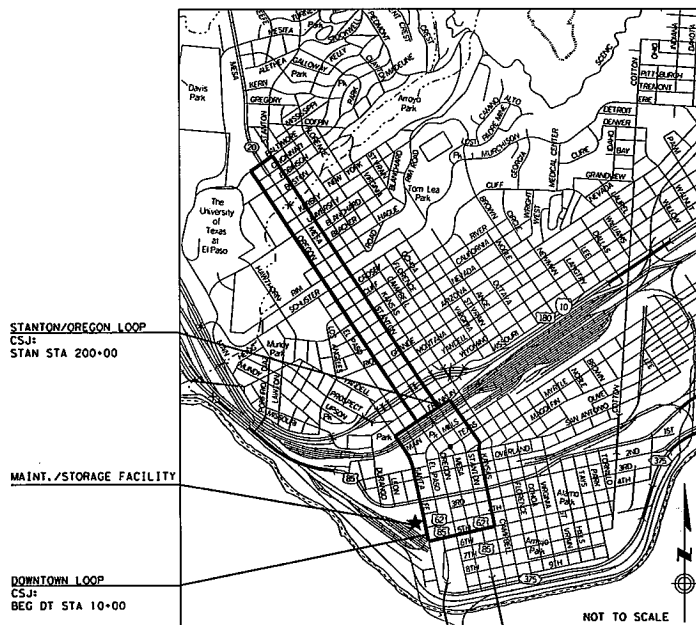

LIMITS:

DOWNTOWN LOOP LIMITS:

FROM INTERSECTION OF FATHER RAHM AVE AND SANTA FE ST, ALONG
SANTA FE ST TO FRANKLIN AVE, ALONG FRANKLIN AVE TO KANSAS ST,
ALONG KANSAS ST TO FATHER RAHM AVE, ALONG FATHER RAHM AVE TO
SANTA FE ST.

STANTON/OREGON LOOP LIMITS:

FROM INTERSECTION OF STANTON ST AND FRANKLIN AVE, ALONG
STANTON TO BALTIMORE DR, ALONG BALTIMORE DR TO OREGON ST,
ALONG OREGON ST TO FRANKLIN AVE.

COUNTY: _____ PROJ. NO.: _____
DATE: _____ LETTING DATE: _____
DATE ACCEPTED: _____

5 of 28

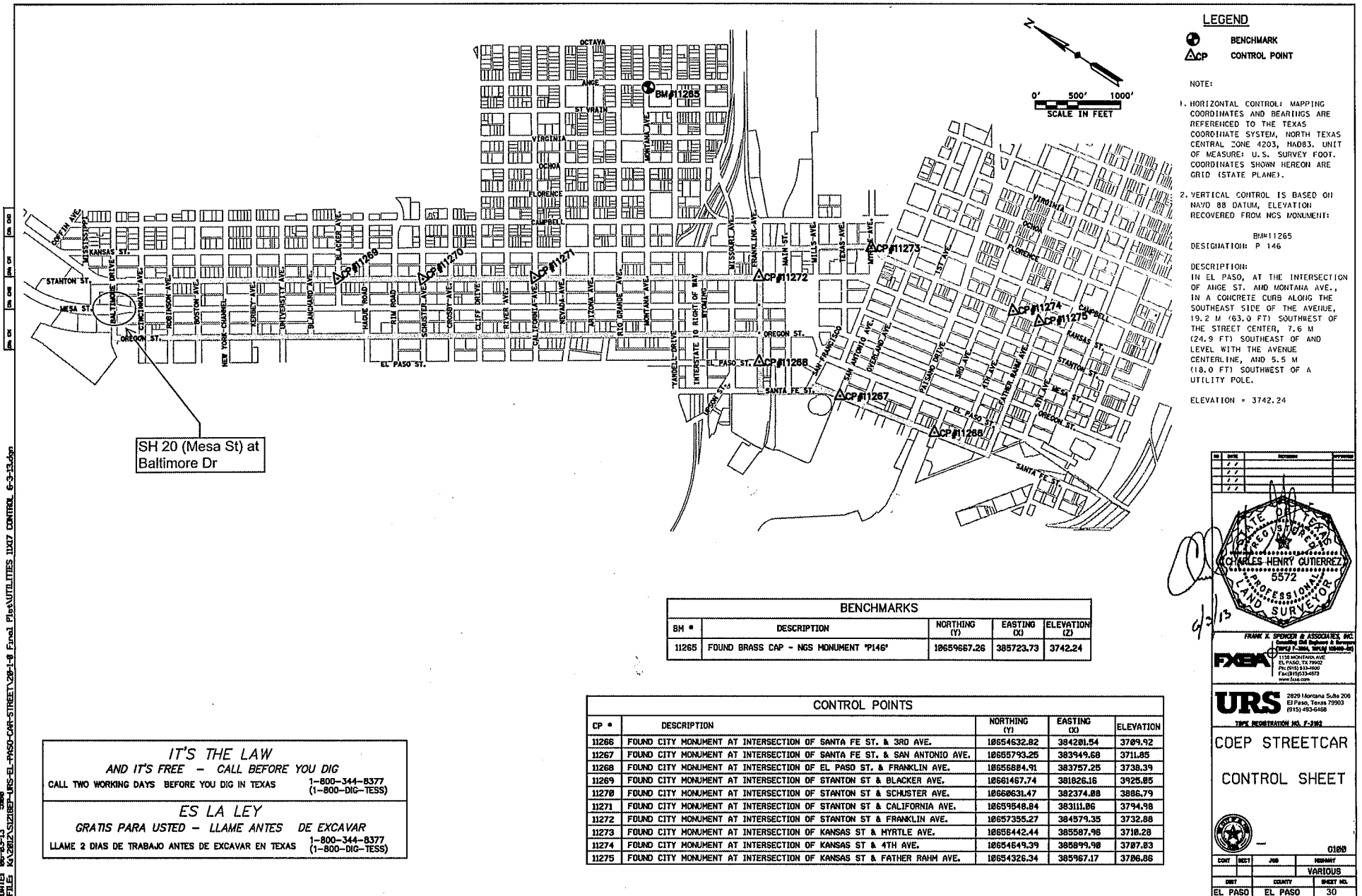

IT'S THE LAW
AND IT'S FREE - CALL BEFORE YOU DIG
 CALL TWO WORKING DAYS BEFORE YOU DIG IN TEXAS
 1-800-344-8377
 (1-800-DIG-TESS)

ES LA LEY
GRATIS PARA USTED - LLAME ANTES DE EXCAVAR
 LLAME 2 DIAS DE TRABAJO ANTES DE EXCAVAR EN TEXAS
 1-800-344-8377
 (1-800-DIG-TESS)

BENCHMARKS				
BM #	DESCRIPTION	NORTHING (Y)	EASTING (X)	ELEVATION (Z)
11265	FOUND BRASS CAP - NGS MONUMENT "P146"	10659667.26	385723.73	3742.24

CONTROL POINTS				
CP #	DESCRIPTION	NORTHING (Y)	EASTING (X)	ELEVATION
11266	FOUND CITY MONUMENT AT INTERSECTION OF SANTA FE ST. & 3RD AVE.	10654632.82	384281.54	3709.92
11267	FOUND CITY MONUMENT AT INTERSECTION OF SANTA FE ST. & SAN ANTONIO AVE.	10655793.25	383949.68	3711.85
11268	FOUND CITY MONUMENT AT INTERSECTION OF EL PASO ST. & FRANKLIN AVE.	10656884.91	383757.25	3738.39
11269	FOUND CITY MONUMENT AT INTERSECTION OF STANTON ST & BLACKER AVE.	10661467.74	381826.16	3925.05
11270	FOUND CITY MONUMENT AT INTERSECTION OF STANTON ST & SCHUSTER AVE.	10660631.47	382374.88	3886.79
11271	FOUND CITY MONUMENT AT INTERSECTION OF STANTON ST & CALIFORNIA AVE.	10659848.84	383111.86	3794.98
11272	FOUND CITY MONUMENT AT INTERSECTION OF STANTON ST & FRANKLIN AVE.	10657355.27	384579.35	3732.88
11273	FOUND CITY MONUMENT AT INTERSECTION OF KANSAS ST & MYRTLE AVE.	10656442.44	385587.96	3718.28
11274	FOUND CITY MONUMENT AT INTERSECTION OF KANSAS ST & 4TH AVE.	10654649.39	385899.98	3787.83
11275	FOUND CITY MONUMENT AT INTERSECTION OF KANSAS ST & FATHER RAHM AVE.	10654326.34	385967.17	3786.86

LEGEND

BENCHMARK
 CONTROL POINT

NOTE:

1. HORIZONTAL CONTROL: MAPPING COORDINATES AND BEARINGS ARE REFERENCED TO THE TEXAS COORDINATE SYSTEM, NORTH TEXAS CENTRAL ZONE 4203, NAD83. UNIT OF MEASURE: U.S. SURVEY FOOT. COORDINATES SHOWN HEREON ARE GRID (STATE PLANE).

2. VERTICAL CONTROL IS BASED ON NAVD 88 DATUM, ELEVATION RECOVERED FROM NGS MONUMENT:

BM#11265
 DESIGNATION: P 146

DESCRIPTION:
 IN EL PASO, AT THE INTERSECTION OF ANGE ST. AND MONTANA AVE., IN A CONCRETE CURB ALONG THE SOUTHEAST SIDE OF THE AVENUE, 19.2 M (63.0 FT) SOUTHWEST OF THE STREET CENTER, 7.6 M (24.9 FT) SOUTHEAST OF AND LEVEL WITH THE AVENUE CENTERLINE, AND 5.5 M (18.0 FT) SOUTHWEST OF A UTILITY POLE.

ELEVATION = 3742.24

6/3/13

FRANK K. SPENCER & ASSOCIATES, INC.
 Consulting Civil Engineers & Surveyors
 1715 JACKSON AVE.
 EL PASO, TX 79902
 (915) 835-6660
 Fax: (915) 833-4873
 www.fksa.com

FXEA

URS
 2829 Montana Suite 206
 El Paso, Texas 79903
 (915) 452-6660

TEXAS REGISTRATION NO. F-2482

COEP STREETCAR

CONTROL SHEET

CDMT	DECT	JOB	REVISION
			VARIOUS
UNIT	QUANTITY	SHEET NO.	
EL PASO	EL PASO	30	

0108

DATE: 6/18/2015 5:23:49 PM
 FILE: C:\Users\k145\OneDrive\Transportation\63676\SDM\PP-ST-21.dgn

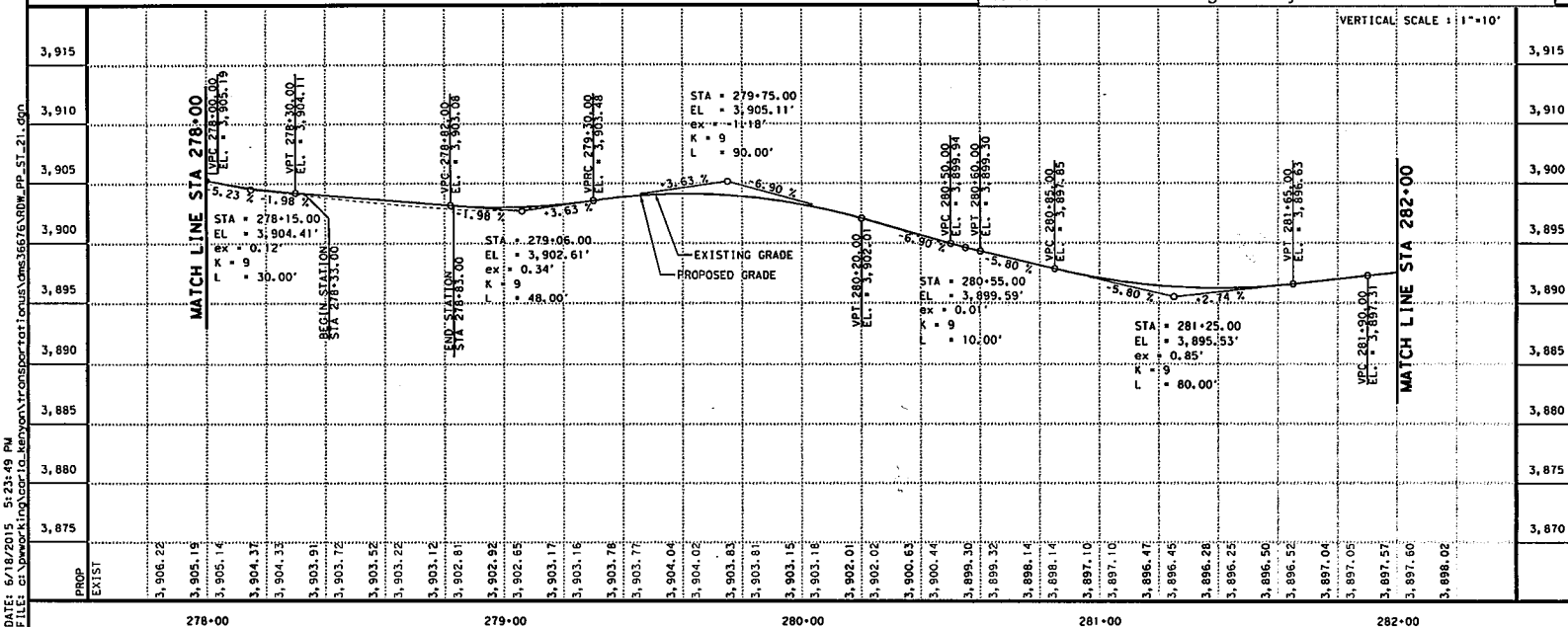
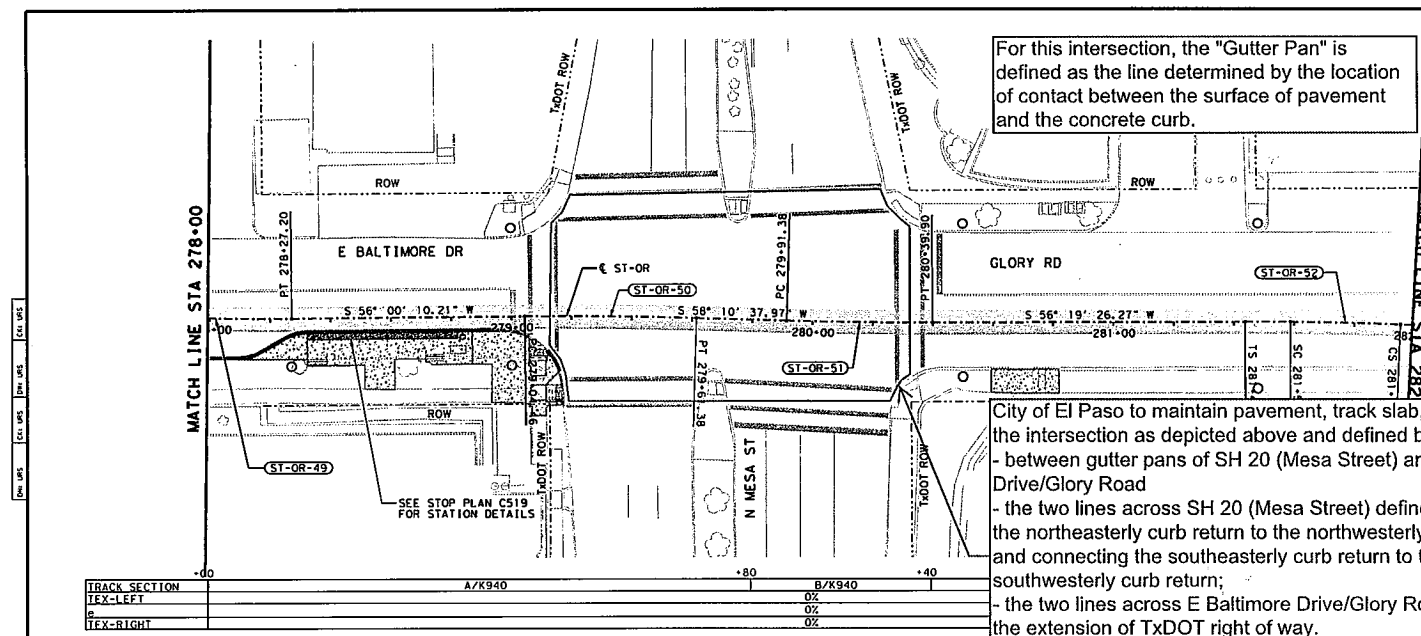

- 0' 20' 40'
 SCALE IN FEET
- LEGEND**
- LIMITS OF STREET RECONSTRUCTION
 - CENTERLINE STREETCAR ALIGNMENT
 - TRACK SLAB
 - TRACK SLAB OVER UTILITY VAULT SEE DETAIL K956
 - CURVE NAME
 - PROPOSED OCS POLE
- NOTES:**
- SEE TRAFFIC SIGNAL SHEETS FOR TRAFFIC SIGNAL MODIFICATIONS.
 - SEE UTILITY SHEETS FOR EXISTING AND PROPOSED UTILITY INFORMATION.
 - REFER TO HORIZONTAL ALIGNMENT DATA SHEETS FOR CURVE DATA AND ALIGNMENT INFORMATION.
 - SEE STOP DETAIL SHEETS FOR PROPOSED STOP INFORMATION.
 - CONTRACTOR TO FIELD ADJUST TRACK SLOPE TRANSITIONS AS NECESSARY.
 - BASEMENT INFORMATION SHOWN HEREON IS APPROXIMATE AND BASED ON CBD II AND CBD III AS-BUILTS AND IDENTIFICATION OF SURFACE FEATURES ONLY.
 - EXISTING ROADWAY PROFILE MAY VARY FROM SURVEY PERFORMED SPRING 2013.
 - SEE GEOTECH REPORT FOR INFORMATION REGARDING BORE HOLES.
 - SEE STREET RECONSTRUCTION SHEETS FOR PROPOSED RECONSTRUCTION LIMITS.
 - SEE TYPICAL SECTIONS FOR WIDENED TRACK SLAB LIMITS.
 - SEE TRACK DETAIL DRAWING SERIES K940 TO K956 FOR TRACK SLAB AND SPECIAL TRACKWORK DETAILS.
 - SEE OVERHEAD CONTACT SYSTEM SHEETS FOR PROPOSED OCS POLE LAYOUT.

NO DATE REVISION APPROVED

STATE OF TEXAS
 DEREK E. BENEDICT
 112564
 6/19/15

URS
 2829 Montoya Suite 206
 El Paso, Texas 79903
 (915) 634-6608

TBPE REGISTRATION NO. F-3162

COEP STREETCAR
TRACK PLAN
AND PROFILE
 STA 278+00 TO STA 282+00

K145

CONF	SECT	JOB	REVISION
			VARIOUS

DIST	COUNTY	SHEET NO.
EL PASO	EL PASO	87

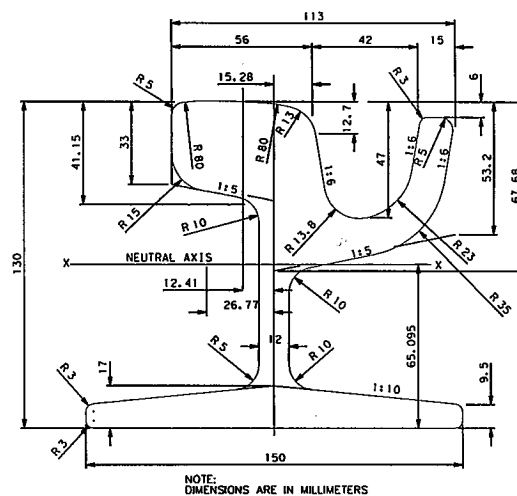
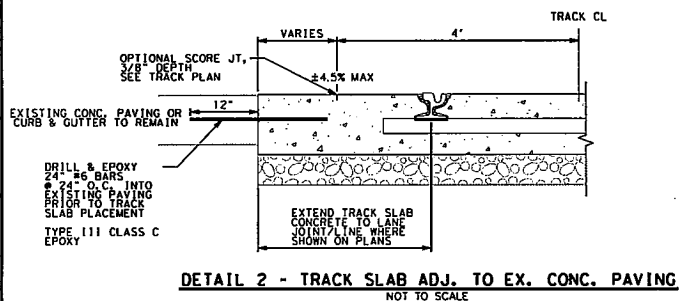
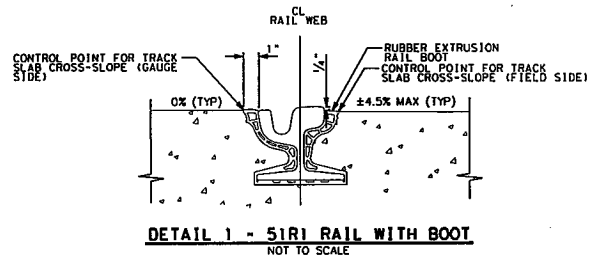
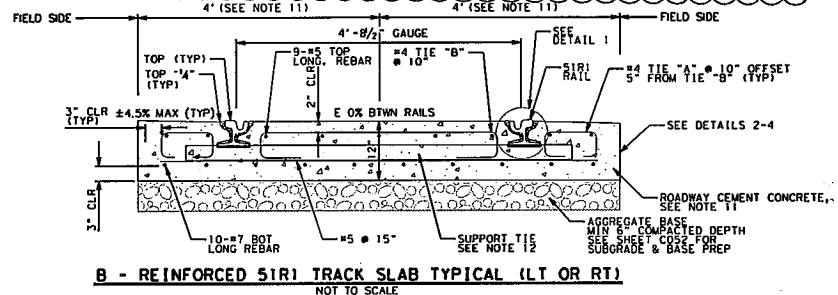

51R1 RAIL
NOT TO SCALE

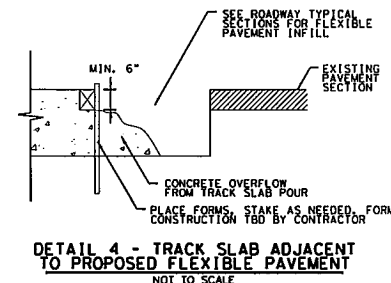
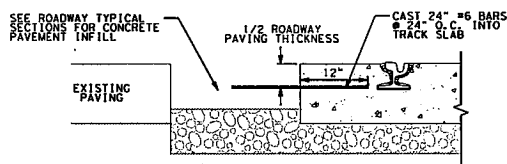
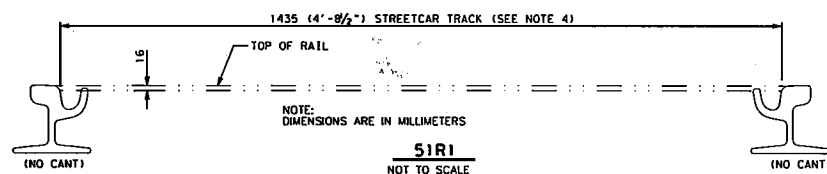

- GENERAL NOTES
1. CONCRETE SHALL BE ROADWAY CEMENT CONCRETE UNLESS NOTED OTHERWISE.
2. REINFORCING SHALL BE UNCOATED DEFORMED BARS WITH A MINIMUM YIELD STRENGTH OF 60,000 PSI.
3. REINFORCING COVER SHALL BE 3" MINIMUM AT BASE AND SIDES OF TRACK SLAB AND 2" MINIMUM ON TOP.
4. TYPICAL TRACK GAUGE SHALL BE 4'-8 1/2".
5. AGGREGATE BASE AS REQUIRED IN SPECIFICATIONS AND AS SHOWN ON THE ROAD TYPICALS (SECTION C052)
6. JOINT GROOVES PLACED TRANSVERSELY ACROSS TRACK SLAB SHALL BE PLACED ABOVE EVERY SUPPORT PIE. GROOVE DEPTH = 3/8" MINIMUM.
7. PROPOSED PROFILE IS TOP OF LOW RAIL.
8. TOP OF CONCRETE ON FIELD SIDE OF RAIL SHALL BE 1/4" BELOW TOP OF RAIL ELEVATION.
9. TRACK PLANS INDICATE WHICH CURVES ARE SUPERELEVATED.
10. COORDINATE TRACTION POWER OR SIGNAL BOND LOCATIONS WITH SYSTEMS CONTRACTOR PRIOR TO POURING CONCRETE. INFILL. SEE DWG J5670 FOR BONDING BLOCKOUT DETAILS.
11. SEE TRACK PLAN FOR LIMITS OF REINFORCED TRACK SLAB, MODIFIED TRACK SLAB, AND TRANSITION RAILS. FOR VARIABLE SLAB WIDTHS ADJACENT TO EXISTING CONCRETE PAVING SEE DETAIL B THIS SHEET
12. SUPPORT TIES SHALL BE SPACED AT 10 FOOT INTERVALS ON TANGENTS AND CURVES WITH A RADIUS RATHER THAN 500 FEET FOR CURVES WITH A RADIUS OF 500 FEET OR LESS. SUPPORT TIES SHALL BE PLACED AT 5 FOOT INTERVALS.

NO	DATE	REVISION	APPROV
	/ /		
	/ /		
	/ /		
	/ /		

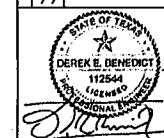
**URS**

TYPE REGISTRATION NO. E-3162

COEP STREETCAR
TRACK SLAB
DETAILS



K940

CONT	SECT	JOB	HIGHWAY
0924	06	446	VARIOUS
DIST		COUNTY	SHEET NO.
EL PASO		EL PASO	122

INDEX OF SHEETS

SHEET NO.	DESCRIPTION
1	TITLE SHEET
2-10	INDEX OF SHEETS

TxDOT MUA no. _____ - Exhibit B

SH 20 (Mesa St) at Franklin Ave

REGISTERED ACCESSIBILITY SPECIALIST (RAS)
INSPECTION REQUIRED
TDLR No. EABPRJB5819210

REQUIRED SIGNS SHALL BE IN ACCORDANCE WITH
BC (11)-14 THRU BC (12)-14 AND THE "TEXAS
MANUAL ON UNIFORM TRAFFIC CONTROL DEVICES".

COUNTY: _____ PROJ. NO.: _____
DATE ACCEPTED: _____ LETTING DATE: _____

CAMINO REAL REGIONAL MOBILITY AUTHORITY

PLANS OF PROPOSED URBAN STREETCAR

PROJECT NO. ()

CITY OF EL PASO STREETCAR EL PASO COUNTY

VOLUME 1 OF 4 - CIVIL/TRACK

FOR THE CONSTRUCTION OF AN URBAN STREETCAR SYSTEM CONSISTING OF
GRADING, STRUCTURES, SURFACE AND SUBSURFACE IMPROVEMENTS,
TRACKWORK, AND MAINTENANCE/STORAGE FACILITY

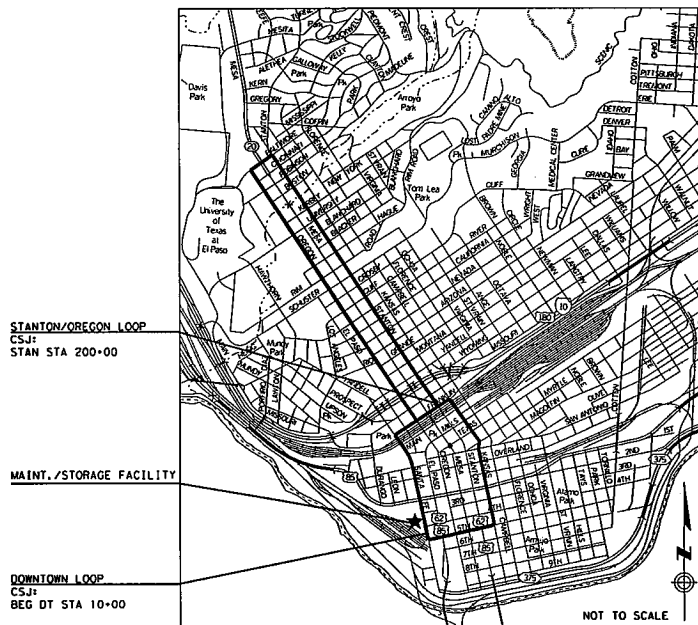

LIMITS:

DOWNTOWN LOOP LIMITS:

FROM INTERSECTION OF FATHER RAHM AVE AND SANTA FE ST, ALONG
SANTA FE ST TO FRANKLIN AVE, ALONG FRANKLIN AVE TO KANSAS ST,
ALONG KANSAS ST TO FATHER RAHM AVE, ALONG FATHER RAHM AVE TO
SANTA FE ST.

STANTON/OREGON LOOP LIMITS:

FROM INTERSECTION OF STANTON ST AND FRANKLIN AVE, ALONG
STANTON TO BALTIMORE DR, ALONG BALTIMORE DR TO OREGON ST,
ALONG OREGON ST TO FRANKLIN AVE.

STATE PROJECT NO.			
()			
CONTRACT	SECTION	JOB	HIGHWAY
092406	446	VARIOUS	
DIST	COUNTY	SHEET NO.	
EL PASO	EL PASO	1	

FINAL PLANS

LETTING DATE: _____

DATE CONTRACTOR BEGAN WORK: _____

DATE WORK WAS COMPLETED & ACCEPTED: _____

FINAL CONTRACT COST: \$ _____

CONTRACTOR: _____

URS

2829 Montana Suite 206
El Paso, Texas 79903
(915) 493-6468

TBPE REGISTRATION NO. F-3162



SUBMITTED FOR LETTING: _____

PROJECT MANAGER
CAMINO REAL REGIONAL MOBILITY AUTHORITY

9 of 28

For this intersection, the "Gutter Pan" is defined as the line determined by the location of contact between the surface of pavement and the concrete curb.

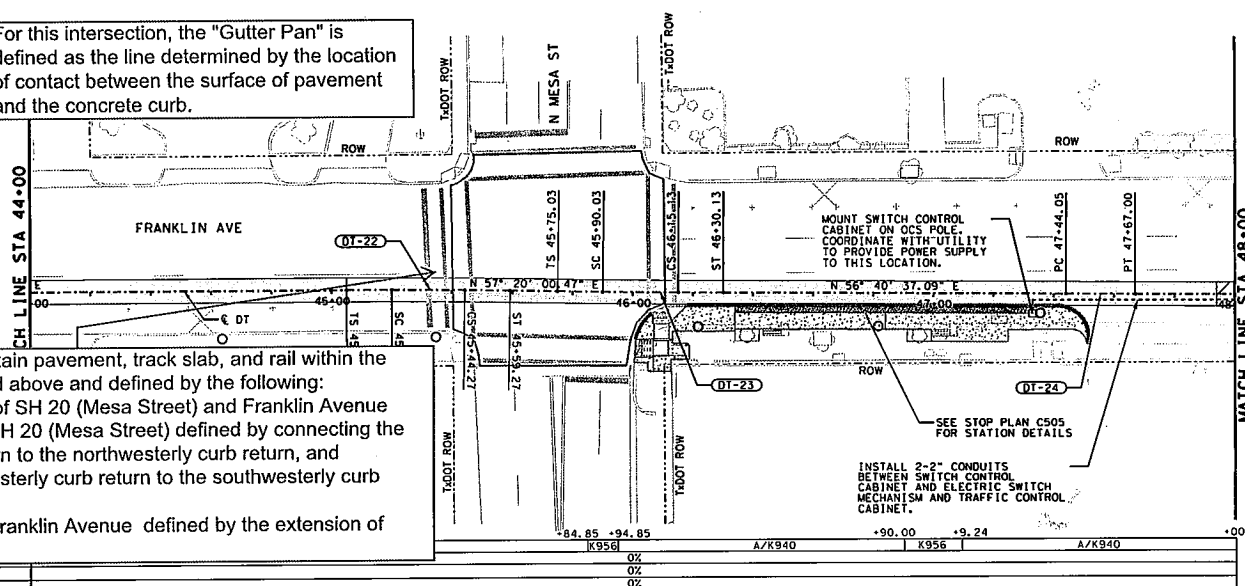





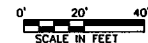

City of El Paso to maintain pavement, track slab, and rail within the intersection as depicted above and defined by the following:

- between gutter pans of SH 20 (Mesa Street) and Franklin Avenue
- the two lines across SH 20 (Mesa Street) defined by connecting the northeasterly curb return to the northwesterly curb return, and connecting the southeasterly curb return to the southwesterly curb return;
- the two lines across Franklin Avenue defined by the extension of TxDOT right of way.



LEGEND

- | | |
|---|---|
|  | LIMITS OF STREET
RECONSTRUCTION |
|  | CENTERLINE STREETCAR
ALIGNMENT |
|  | TRACK SLAB |
|  | TRACK SLAB OVER
UTILITY VAULT
SEE DETAIL K956 |
|  | CURVE NAME |
|  | PROPOSED OCS POLE |

1. SEE TRAFFIC SIGNAL SHEETS FOR TRAFFIC SIGNAL MODIFICATIONS.
2. SEE UTILITY SHEETS FOR EXISTING AND PROPOSED UTILITY INFORMATION.
3. REFER TO HORIZONTAL ALIGNMENT DATA SHEETS FOR CURVE DATA AND ALIGNMENT INFORMATION.
4. SEE TOP DETAIL SHEETS FOR PROPOSED STOP INFORMATION.
5. CONTRACTOR TO FIELD ADJUST TRACK SLOPE TRANSITIONS AS NECESSARY.
6. BENCH MARK INFORMATION SHOWN HEREON IS APPROXIMATE AND BASED ON CBD II AND CSD II 1: AS-BUILTS AND IDENTIFICATION CSD SURFACE FEATURES ONLY.
7. EXISTING ROADWAY PROFILE MAY VARY FROM SURVEY PERFORMED SPRING 2013.
8. SEE GEOTECH REPORT FOR INFORMATION REGARDING BOREHOLE DATA.
9. SEE STREET RECONSTRUCTION SHEETS FOR PROPOSED RECONSTRUCTION LIMITS.
10. SEE TYPICAL SECTIONS FOR WIDENED TRACK LIMITS.
11. SEE TRACK DETAIL DRAWING SERIES K940 TO K956 FOR TRACK SLAB AND SPECIAL TRACKWORK DETAILS.
12. SEE OVERHEAD CABLE SYSTEM SHEETS FOR PROPOSED OCS POLE LAYOUT.

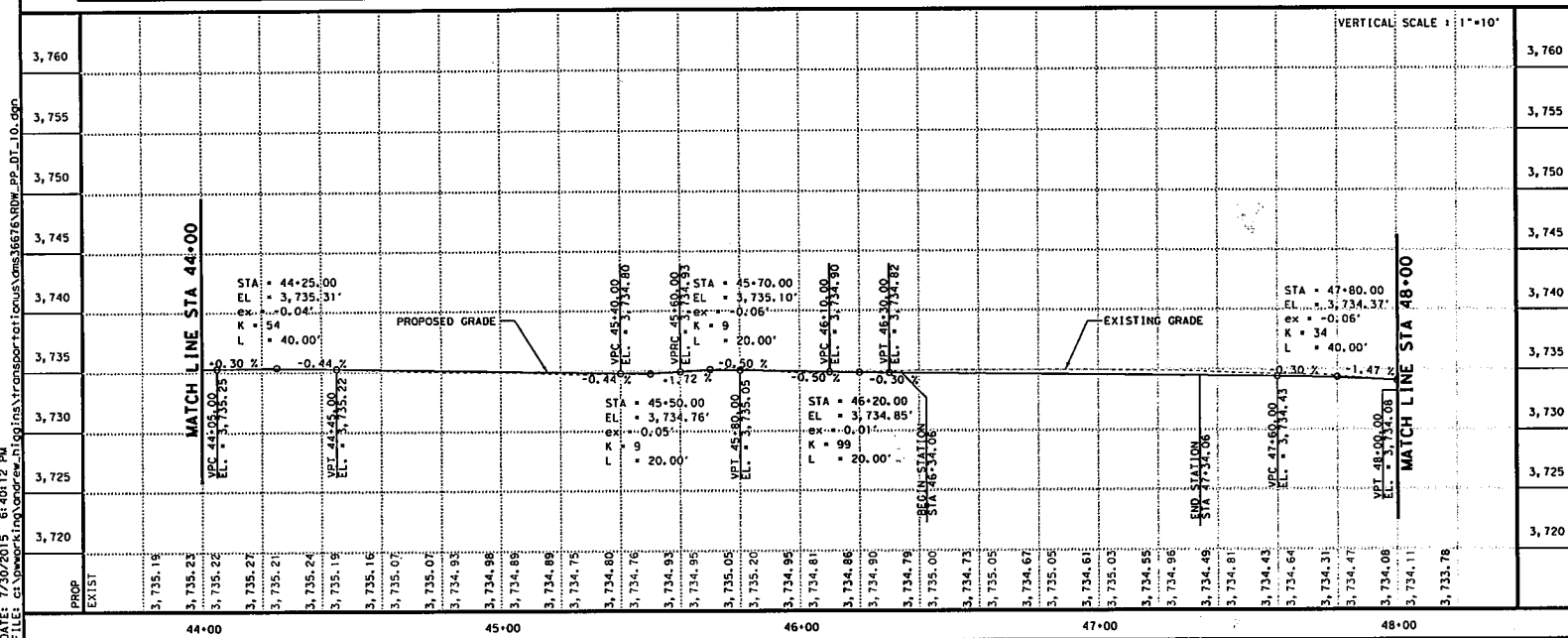

NO	DATE	REVISION	APPROVED
/ /	/ /		
/ /	/ /		
/ /	/ /		
/ /	/ /		

STATE OF TEXAS
Derek E. Benedict
112544
FHEMENT
TxDOT REGISTRATION NO.

7/24/15

[Signature]

URS						2800 Montclair Suite 205 El Paso, Texas 79903 (915) 493-6468
TPOE REGISTRATION NO. F-3162						
COEP STREETCAR						
TRACK PLAN						
AND PROFILE						
STA 44+00 TO STA 48+00						

K109

	CONT	SECT	JOB	HIGHWAY
	0924	06	446	VARIOUS
	DIST	COUNTY	SHEET NO.	
EL PASO	EL PASO		51	

11 of 28

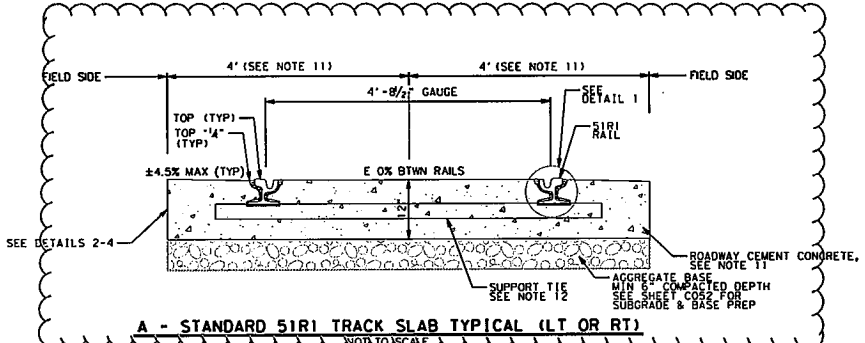

A - STANDARD 51R1 TRACK SLAB TYPICAL (LT OR RT)
NOT TO SCALE

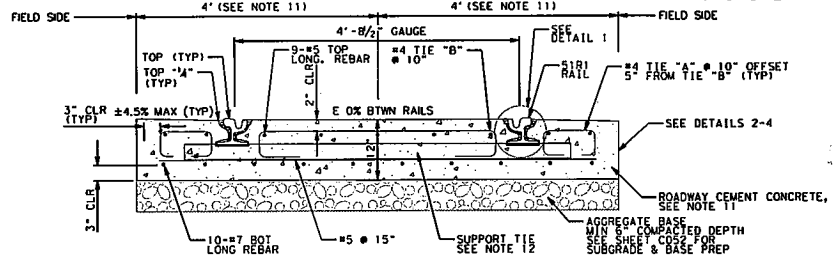

B - REINFORCED 51R1 TRACK SLAB TYPICAL (LT OR RT)
NOT TO SCALE

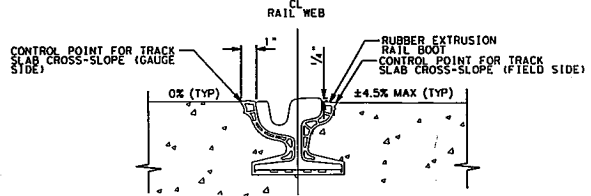

DETAIL 1 - 51R1 RAIL WITH BOOT
NOT TO SCALE

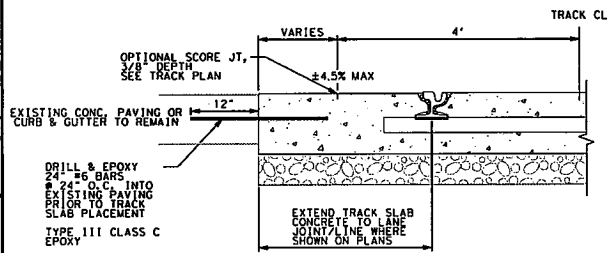

DETAIL 2 - TRACK SLAB ADJ. TO EX. CONC. PAVING
NOT TO SCALE

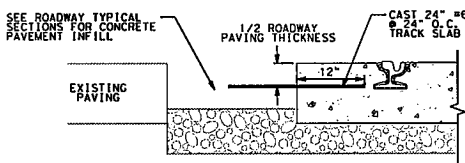

DETAIL 3 - TRACK SLAB ADJ. TO PROPOSED CONC. PAVING
NOT TO SCALE

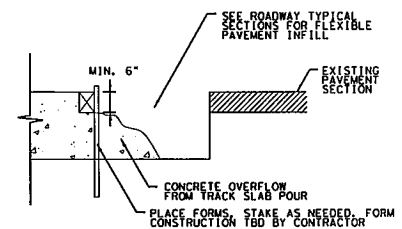

DETAIL 4 - TRACK SLAB ADJACENT TO PROPOSED FLEXIBLE PAVING
NOT TO SCALE

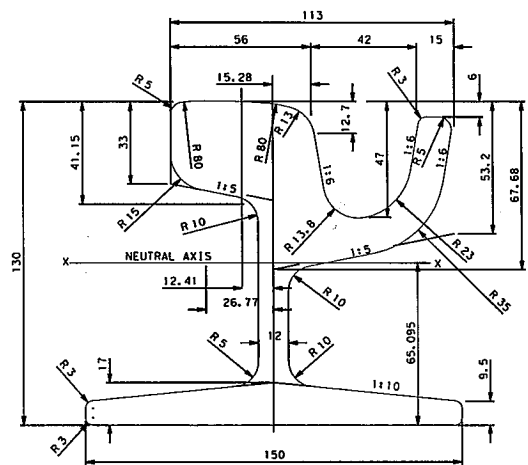

51R1 RAIL
NOT TO SCALE

- GENERAL NOTES**
1. CONCRETE SHALL BE ROADWAY CEMENT CONCRETE UNLESS NOTED OTHERWISE.
 2. REINFORCING SHALL BE UNCOATED DEFORMED BARS WITH A MINIMUM YIELD STRENGTH OF 60,000 PSI.
 3. REINFORCING COVER SHALL BE 3\"/>

DATE: 7/21/2015 3:06:40 PM
FILE: c:\pwworking\URS\10-Kernan\Transportation\06567610\DWG\T0-DT-00.dwg

NO.	DATE	REVISION	APPROVED
1			
2			
3			
4			

DEREK E. BENEDICT
112544
REGISTERED PROFESSIONAL ENGINEER
STATE OF TEXAS

7/24/15

URS
2829 Montross Suite 205
El Paso, Texas 79903
(910) 493-6468

TMP REGISTRATION NO. F-3162

**COEP STREETCAR
TRACK SLAB
DETAILS**

K940

CONT.	SECT.	JOB	REMARKS
0924	06	446	VARIOUS
EL PASO	EL PASO		122

12728

INDEX OF SHEETS

SHEET NO.	DESCRIPTION
1	TITLE SHEET
2-10	INDEX OF SHEETS

CAMINO REAL REGIONAL MOBILITY AUTHORITY

PLANS OF PROPOSED URBAN STREETCAR

PROJECT NO. ()

CITY OF EL PASO STREETCAR EL PASO COUNTY

VOLUME 1 OF 4 - CIVIL/TRACK

FOR THE CONSTRUCTION OF AN URBAN STREETCAR SYSTEM CONSISTING OF
GRADING, STRUCTURES, SURFACE AND SUBSURFACE IMPROVEMENTS,
TRACKWORK, AND MAINTENANCE/STORAGE FACILITY

STATE PROJECT NO.			
()			
CONTRACT	SECTION	JOB	HIGHWAY
092406	446	VARIOUS	
DIST	COUNTY	SHEET NO.	
EL PASO	EL PASO	1	

FINAL PLANS

LETTING DATE: _____
DATE CONTRACTOR BEGAN WORK: _____
DATE WORK WAS COMPLETED & ACCEPTED: _____
FINAL CONTRACT COST: \$ _____
CONTRACTOR: _____

TxDOT MUA no. _____ - Exhibit B

US 62 (Paisano Dr) at Santa Fe St

REGISTERED ACCESSIBILITY SPECIALIST (RAS)
INSPECTION REQUIRED
TDLR No. EABPRJB5819210

REQUIRED SIGNS SHALL BE IN ACCORDANCE WITH
BC (11)- 14 THRU BC (12)- 14 AND THE "TEXAS
MANUAL ON UNIFORM TRAFFIC CONTROL DEVICES".

URS

2829 Montana Suite 206
El Paso, Texas 79903
(915) 493-6468

TBPE REGISTRATION NO. F-3162



SUBMITTED FOR LETTING: _____

PROJECT MANAGER
CAMINO REAL REGIONAL MOBILITY AUTHORITY

STANTON/OREGON LOOP
CSJ1
STAN STA 200+00

MAINT./STORAGE FACILITY

DOWNTOWN LOOP
CSJ1
BEG DT STA 10+00

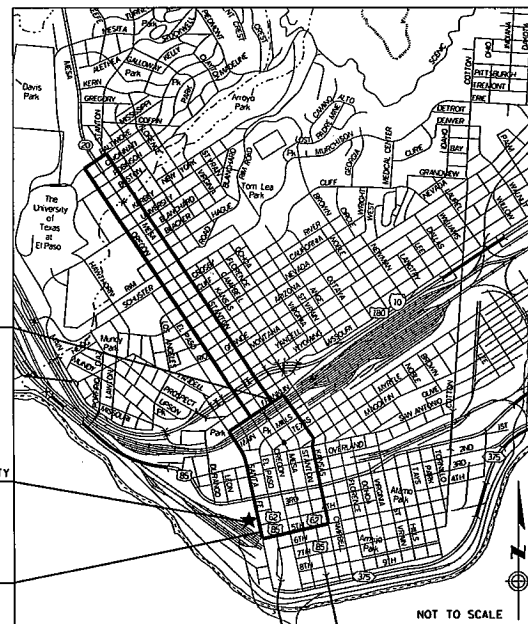

NOT TO SCALE

LIMITS:

DOWNTOWN LOOP LIMITS:

FROM INTERSECTION OF FATHER RAHM AVE AND SANTA FE ST, ALONG
SANTA FE ST TO FRANKLIN AVE, ALONG FRANKLIN AVE TO KANSAS ST,
ALONG KANSAS ST TO FATHER RAHM AVE, ALONG FATHER RAHM AVE TO
SANTA FE ST.

STANTON/OREGON LOOP LIMITS:

FROM INTERSECTION OF STANTON ST AND FRANKLIN AVE, ALONG
STANTON TO BALTIMORE DR, ALONG BALTIMORE DR TO OREGON ST,
ALONG OREGON ST TO FRANKLIN AVE.

COUNTY: _____ PROJ. NO.: _____
DATE: _____ LETTING DATE: _____
DATE ACCEPTED: _____

13428

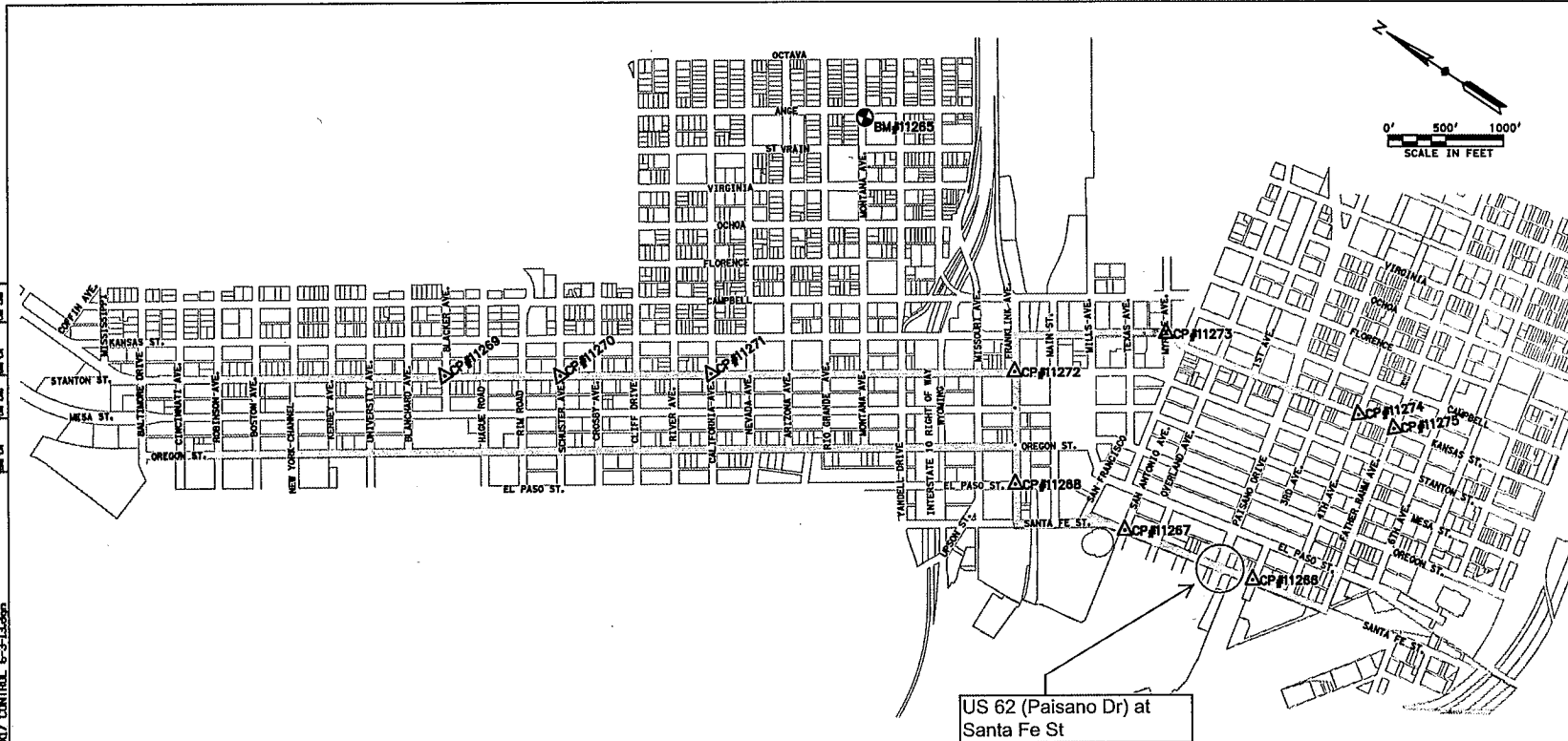

LEGEND

BENCHMARK
 CONTROL POINT

NOTE:

1. HORIZONTAL CONTROL: MAPPING COORDINATES AND BEARINGS ARE REFERENCED TO THE TEXAS COORDINATE SYSTEM, NORTH TEXAS CENTRAL ZONE 4203, NAD83. UNIT OF MEASURE: U.S. SURVEY FOOT. COORDINATES SHOWN HEREON ARE GRID (STATE PLANE).

2. VERTICAL CONTROL IS BASED ON NAVD 88 DATUM, ELEVATION RECOVERED FROM NGS MONUMENT:

BM#11265
 DESIGNATION: P 146

DESCRIPTION:
 IN EL PASO, AT THE INTERSECTION OF ANGE ST. AND MONTANA AVE., IN A CONCRETE CURB ALONG THE SOUTHWEST SIDE OF THE AVENUE, 19.2 M (63.0 FT) SOUTHWEST OF THE STREET CENTER, 7.6 M (24.9 FT) SOUTHWEST OF AND LEVEL WITH THE AVENUE CENTERLINE, AND 5.5 M (18.0 FT) SOUTHWEST OF A UTILITY POLE.

ELEVATION = 3742.24

Professional Seal of Charles Henry Gutierrez, State of Texas, License No. 5572.

FRANK E. SPENCER & ASSOCIATES, INC.
 (Incorporated in the State of Texas)
 11128 MONTANA AVE.
 EL PASO, TEXAS 79902
 (915) 493-6466
 FAX (915) 493-6473
 www.fesa.com

URS
 TYPE REGISTRATION NO. 7-3182

COEP STREETCAR
 CONTROL SHEET

CONT		MEET	JOB	ISSUED
DATE		COUNTY	SHEET NO.	
EL PASO		EL PASO	30	

BENCHMARKS				
BM #	DESCRIPTION	NORTHING (Y)	EASTING (X)	ELEVATION (Z)
11265	FOUND BRASS CAP - NGS MONUMENT "P146"	10659667.26	385723.73	3742.24

CONTROL POINTS				
CP #	DESCRIPTION	NORTHING (Y)	EASTING (X)	ELEVATION
11266	FOUND CITY MONUMENT AT INTERSECTION OF SANTA FE ST. & 3RD AVE.	10654632.82	384201.54	3789.92
11267	FOUND CITY MONUMENT AT INTERSECTION OF SANTA FE ST. & SAN ANTONIO AVE.	10655793.25	383949.88	3711.05
11268	FOUND CITY MONUMENT AT INTERSECTION OF EL PASO ST. & FRANKLIN AVE.	10656004.91	383757.25	3730.39
11269	FOUND CITY MONUMENT AT INTERSECTION OF STANTON ST & BLACKER AVE.	10661467.74	381026.16	3925.05
11270	FOUND CITY MONUMENT AT INTERSECTION OF STANTON ST & SCHUSTER AVE.	10660631.47	382374.88	3886.79
11271	FOUND CITY MONUMENT AT INTERSECTION OF STANTON ST & CALIFORNIA AVE.	10659548.84	383111.86	3794.98
11272	FOUND CITY MONUMENT AT INTERSECTION OF STANTON ST & FRANKLIN AVE.	10667355.27	384579.35	3732.88
11273	FOUND CITY MONUMENT AT INTERSECTION OF KANSAS ST & MYRTLE AVE.	10656442.44	385587.98	3710.28
11274	FOUND CITY MONUMENT AT INTERSECTION OF KANSAS ST & 4TH AVE.	10654649.39	385899.98	3787.83
11275	FOUND CITY MONUMENT AT INTERSECTION OF KANSAS ST & FATHER RAHM AVE.	10654326.34	385967.17	3786.86

IT'S THE LAW
 AND IT'S FREE - CALL BEFORE YOU DIG
 CALL TWO WORKING DAYS BEFORE YOU DIG IN TEXAS 1-800-344-8377
 (1-800-DIG-TESS)

ES LA LEY
 GRATIS PARA USTED - LLAME ANTES DE EXCAVAR
 LLAME 2 DIAS DE TRABAJO ANTES DE EXCAVAR EN TEXAS 1-800-344-8377
 (1-800-DIG-TESS)

DATE: 6/18/2015 5:11:12 PM
FILE: c:\working\cor10_kenny\transportation\usm3676\RDW_PP_DT_03.dgn

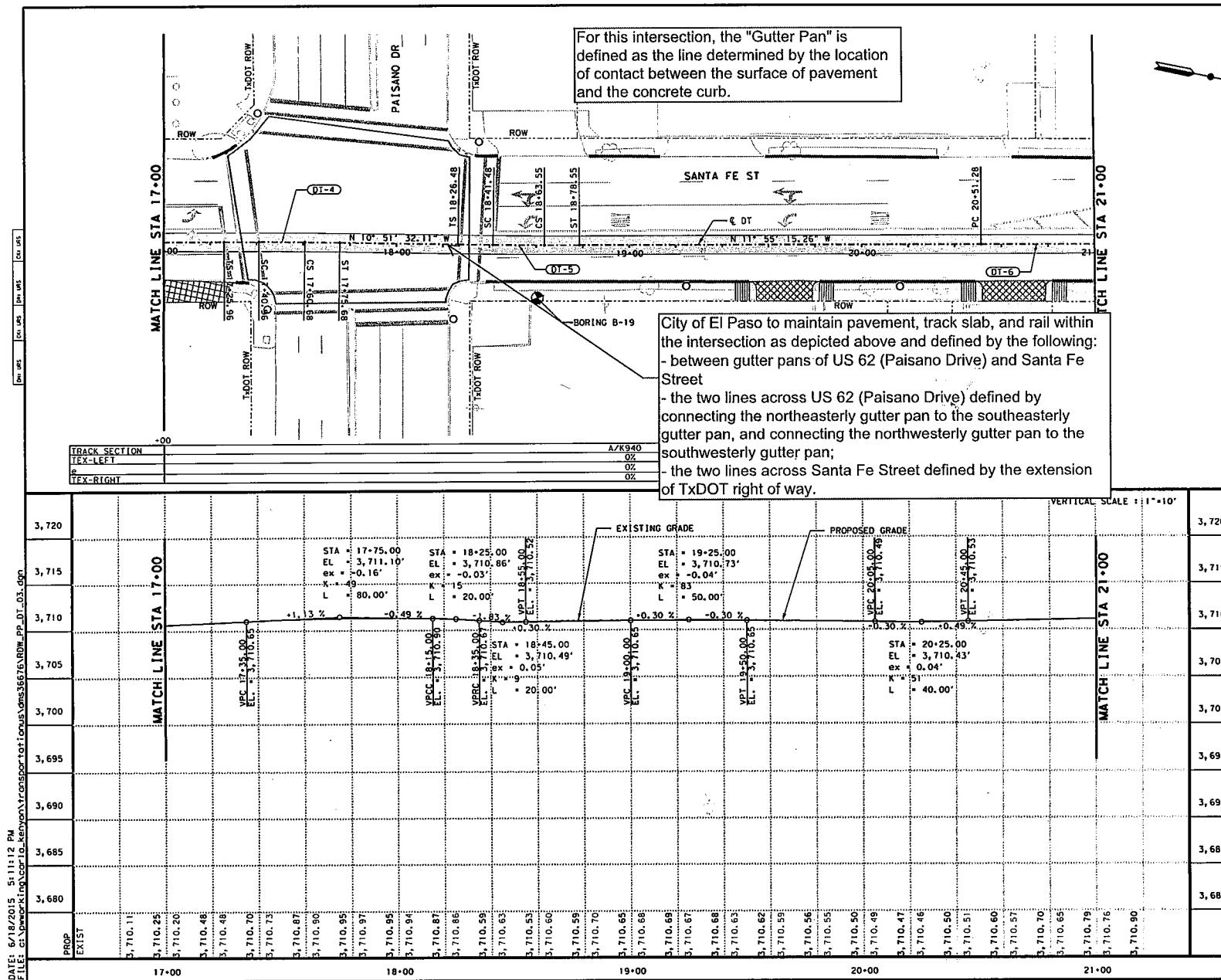

LEGEND

- LIMITS OF STREET RECONSTRUCTION
- CENTERLINE STREETCAR ALIGNMENT
- TRACK SLAB
- TRACK SLAB OVER UTILITY VAULT SEE DETAIL K956
- CURVE NAME (XX-XX)
- PROPOSED OCS POLE

- NOTES:
- SEE TRAFFIC SIGNAL SHEETS FOR TRAFFIC SIGNAL MODIFICATIONS.
 - SEE UTILITY SHEETS FOR EXISTING AND PROPOSED UTILITY INFORMATION.
 - REFER TO HORIZONTAL ALIGNMENT DATA SHEETS FOR CURVE DATA AND ALIGNMENT INFORMATION.
 - SEE STOP DETAIL SHEETS FOR PROPOSED STOP INFORMATION.
 - CONTRACTOR TO FIELD ADJUST TRACK SLOPE TRANSITIONS AS NECESSARY.
 - BASEMENT INFORMATION SHOWN HEREON IS APPROXIMATE AND BASED ON CBD II AND CBD III AS-BUILTS AND IDENTIFICATION OF SURFACE FEATURES ONLY.
 - EXISTING ROADWAY PROFILE MAY VARY FROM SURVEY PERFORMED SPRING 2013.
 - SEE GEOTECH REPORT FOR INFORMATION REGARDING BORE HOLES.
 - SEE STREET RECONSTRUCTION SHEETS FOR PROPOSED RECONSTRUCTION LIMITS.
 - SEE TYPICAL SECTIONS FOR WIDENED TRACK SLAB LIMITS.
 - SEE TRACK DETAIL DRAWING SERIES K940 TO K956 FOR TRACK SLAB AND SPECIAL TRACKWORK DETAILS.
 - SEE OVERHEAD CONTACT SYSTEM SHEETS FOR PROPOSED OCS POLE LAYOUT.

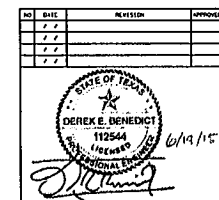

URS 2629 Montross Suite 205
El Paso, Texas 79903
(915) 493-6468

TYPE REGISTRATION NO. F-3162

COEP STREETCAR
TRACK PLAN
AND PROFILE
STA 17+00 TO STA 21+00

K102

CON	SECT	JOB	ROADWAY
D151	COUNTY	VARIOUS	
EL PASO	EL PASO	44	

150828

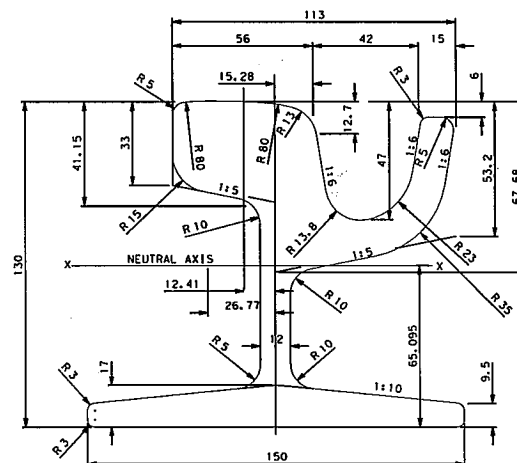
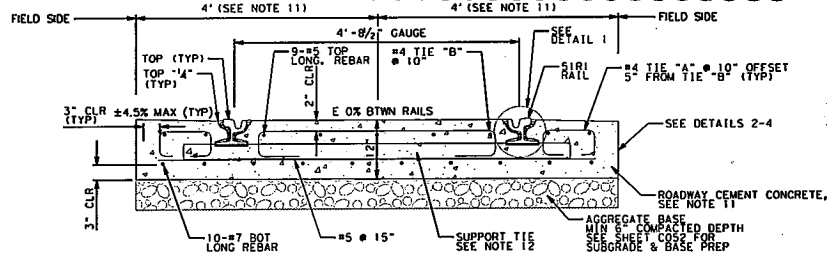

- GENERAL NOTES
1. CONCRETE SHALL BE ROADWAY CEMENT CONCRETE UNLESS NOTED OTHERWISE.
2. REINFORCING SHALL BE UNCOATED DEFORMED BARS WITH A MINIMUM YIELD STRENGTH OF 60,000 PSI.
3. REINFORCING COVER SHALL BE 3" MINIMUM AT BASE AND SIDES OF TRACK SLAB AND 2" MINIMUM ON TOP.
4. TYPICAL TRACK GAUGE SHALL BE 4'-8 1/2".
5. AGGREGATE BASE AS REQUIRED IN SPECIFICATIONS AND AS SHOWN ON THE ROAD TYPICALS (CSHEET C052)
6. JOINT GROOVES PLACED TRANSVERSELY ACROSS TRACK SLAB SHALL BE PLACED ABOVE EVERY SUPPORT TIE. GROOVE DEPTH = 3/8" MINIMUM.
7. PROPOSED PROFILE IS TOP OF LOW RAIL.
8. TOP OF CONCRETE ON FIELD SIDE OF RAIL SHALL BE 1/4" BELOW TOP OF RAIL ELEVATION.
9. TRACK PLANS INDICATE WHICH CURVES ARE SUPERELEVATED.
10. COORDINATE TRACKING POWER OR SIGNAL BOND LOCATIONS WITH SYSTEMS CONTRACTOR PRIOR TO POURING CONCRETE. SEE DWG J670 FOR BONDING BLOCKOUT DETAILS.
11. SEE TRACK PLAN FOR LIMITS OF REINFORCED TRACK SLAB. MINIMUM TRACK SLAB AND TRANSITION RAILS FOR VARIABLE SLAB WIDTHS ADJACENT TO EXISTING CONCRETE PAVING SEE DETAIL B THIS SHEET
12. SUPPORT TIES SHALL BE SPACED AT 10 FEET INTERVALS ON TANGENTS AND CURVES WITH A RADIUS LARGER THAN 500 FEET FOR CURVES WITH A RADIUS 50 FEET OR LESS. SUPPORT TIES SHALL BE PLACED AT 5 FEET INTERVALS.

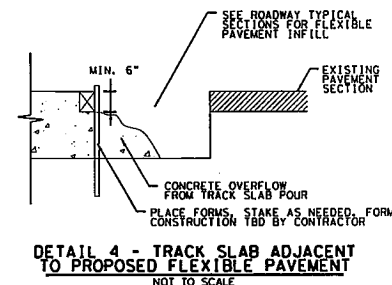
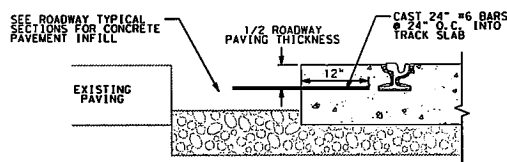
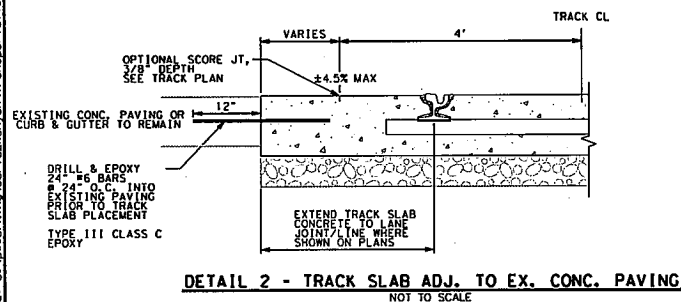
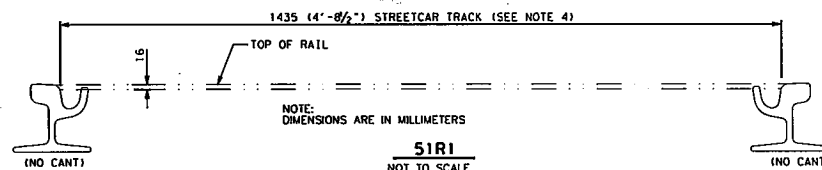
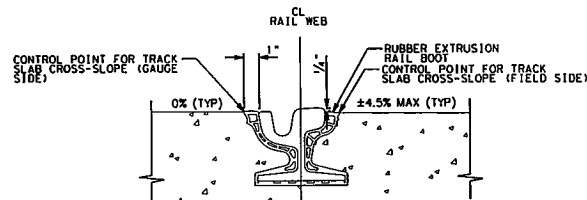

NO	DATE	REVISION	APPROV
	/ /		
	/ /		
	/ /		
	/ /		

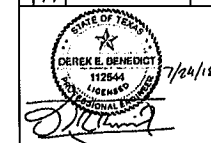

URS 2829 Montana Suite 20
El Paso, Texas 79903
(915) 493-6468
TDPF REGISTRATION NO. F-3162

**COEP STREETCAR
TRACK SLAB
DETAILS**

STATE OF TEXAS

COUNTY OF EL PASO

0924 06 446

DIST COUNTY

EL PASO EL PASO

122

SHEET NO

K94

VARIOUS

INDEX OF SHEETS

SHEET NO.	DESCRIPTION
1	TITLE SHEET
2-10	INDEX OF SHEETS

TxDOT MUA no. _____ - Exhibit B

US 62 (Paisano Drive) at Kansas Street

REGISTERED ACCESSIBILITY SPECIALIST (RAS)
INSPECTION REQUIRED
TDLR No. EABPRJB5819210

REQUIRED SIGNS SHALL BE IN ACCORDANCE WITH
BC (11)- 14 THRU BC (12)- 14 AND THE "TEXAS
MANUAL ON UNIFORM TRAFFIC CONTROL DEVICES".

CAMINO REAL REGIONAL MOBILITY AUTHORITY

PLANS OF PROPOSED URBAN STREETCAR

PROJECT NO. ()

CITY OF EL PASO STREETCAR EL PASO COUNTY

VOLUME 1 OF 4 - CIVIL/TRACK

FOR THE CONSTRUCTION OF AN URBAN STREETCAR SYSTEM CONSISTING OF
GRADING, STRUCTURES, SURFACE AND SUBSURFACE IMPROVEMENTS,
TRACKWORK, AND MAINTENANCE/STORAGE FACILITY

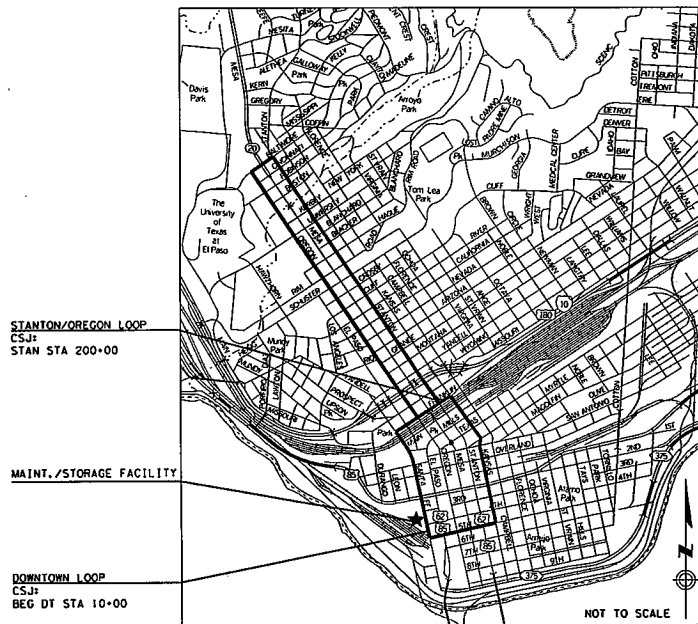

LIMITS:

DOWNTOWN LOOP LIMITS:

FROM INTERSECTION OF FATHER RAHM AVE AND SANTA FE ST. ALONG
SANTA FE ST TO FRANKLIN AVE. ALONG FRANKLIN AVE TO KANSAS ST.
ALONG KANSAS ST TO FATHER RAHM AVE. ALONG FATHER RAHM AVE TO
SANTA FE ST.

STANTON/OREGON LOOP LIMITS:

FROM INTERSECTION OF STANTON ST AND FRANKLIN AVE. ALONG
STANTON TO BALTIMORE DR. ALONG BALTIMORE DR TO OREGON ST.
ALONG OREGON ST TO FRANKLIN AVE.

STATE PROJECT NO.				
()				
CON	SECT	JOB	HIGHWAY	
0924	06	446	VARIOUS	
DIST		COUNTY	SHEET NO.	
EL PASO		EL PASO	1	

FINAL PLANS

LETTING DATE: _____
DATE CONTRACTOR BEGAN WORK: _____
DATE WORK WAS COMPLETED & ACCEPTED: _____
FINAL CONTRACT COST: \$ _____
CONTRACTOR: _____

URS

2829 Montana Suite 206
El Paso, Texas 79903
(915) 493-6468

TBPE REGISTRATION NO. F-3162



CAMINO REAL
REGIONAL MOBILITY
AUTHORITY

SUBMITTED FOR LETTING: _____

PROJECT MANAGER
CAMINO REAL REGIONAL MOBILITY AUTHORITY

COUNTY: _____ PROJ. NO.: _____
DIST. NO.: _____ LETTING DATE: _____
DATE ACCEPTED: _____

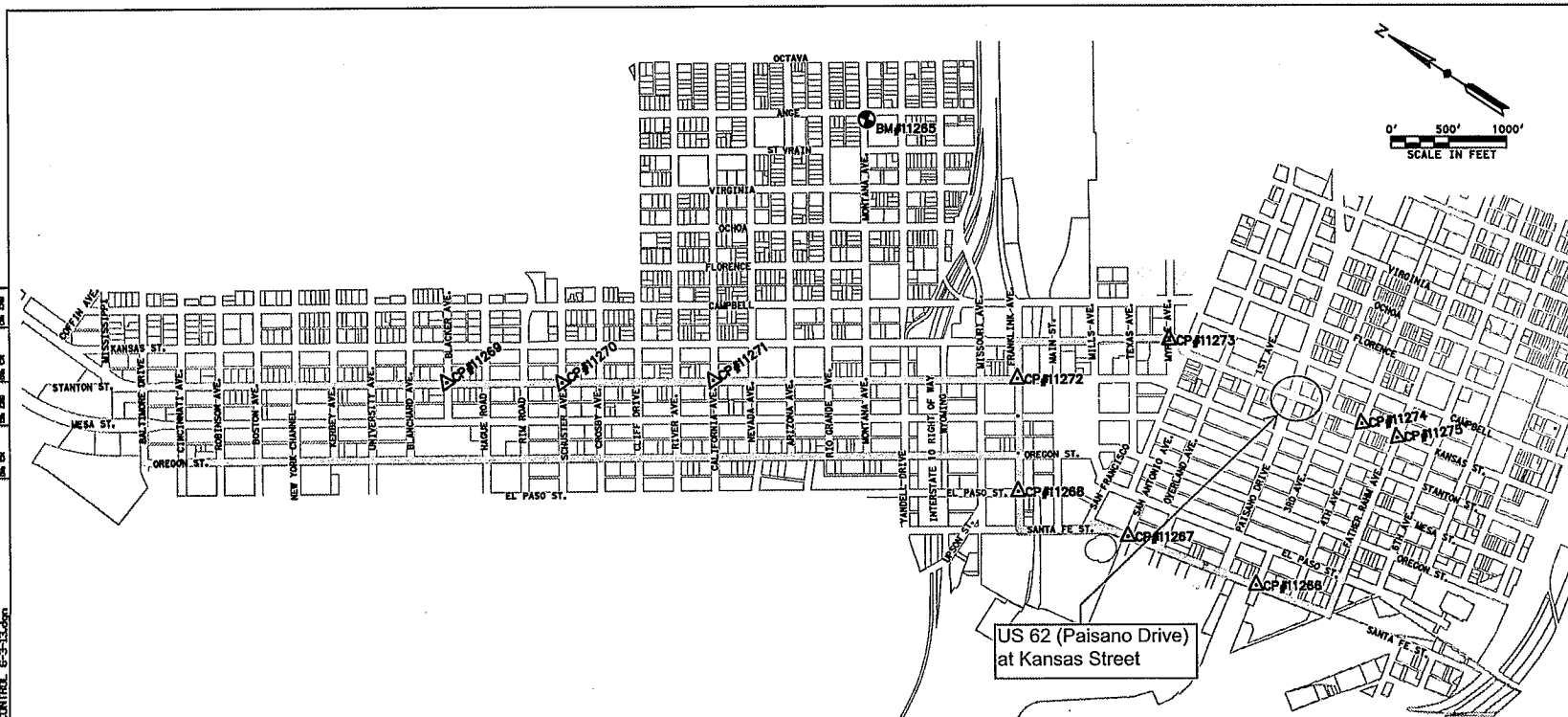

LEGEND **ACP** BENCHMARK **ACP** CONTROL POINT

NOTE:

1. HORIZONTAL CONTROL: MAPPING COORDINATES AND BEARINGS ARE REFERENCED TO THE TEXAS COORDINATE SYSTEM, NORTH TEXAS CENTRAL ZONE 4203, NAD83. UNIT OF MEASURE: U.S. SURVEY FOOT. COORDINATES SHOWN HEREON ARE GRID (STATE PLANE).
2. VERTICAL CONTROL IS BASED ON NAVD 88 DATUM. ELEVATION RECOVERED FROM NGS MONUMENT:

BM#11265
 DESIGNATION: P 146

DESCRIPTION:
 IN EL PASO, AT THE INTERSECTION OF ANGE ST. AND MONTANA AVE., IN A CONCRETE CURB ALONG THE SOUTHEAST SIDE OF THE AVENUE, 19.2 M (63.0 FT) SOUTHWEST OF THE STREET CENTER, 7.6 M (24.9 FT) SOUTHWEST OF AND LEVEL WITH THE AVENUE CENTERLINE, AND 5.5 M (18.0 FT) SOUTHWEST OF A UTILITY POLE.

ELEVATION = 3742.24

BENCHMARKS				
BM #	DESCRIPTION	NORTHING (Y)	EASTING (X)	ELEVATION (Z)
11265	FOUND BRASS CAP - NGS MONUMENT "P146"	18659667.26	385723.73	3742.24

CONTROL POINTS				
CP #	DESCRIPTION	NORTHING (Y)	EASTING (X)	ELEVATION
11266	FOUND CITY MONUMENT AT INTERSECTION OF SANTA FE ST. & 3RD AVE.	18654632.82	384281.54	3789.92
11267	FOUND CITY MONUMENT AT INTERSECTION OF SANTA FE ST. & SAN ANTONIO AVE.	18655793.25	383949.68	3711.85
11268	FOUND CITY MONUMENT AT INTERSECTION OF EL PASO ST. & FRANKLIN AVE.	18656884.91	383757.25	3738.39
11269	FOUND CITY MONUMENT AT INTERSECTION OF STANTON ST & BLACKER AVE.	18661467.74	381826.16	3925.85
11270	FOUND CITY MONUMENT AT INTERSECTION OF STANTON ST & SCHUSTER AVE.	18660631.47	382374.88	3886.79
11271	FOUND CITY MONUMENT AT INTERSECTION OF STANTON ST & CALIFORNIA AVE.	18659548.84	383111.86	3794.98
11272	FOUND CITY MONUMENT AT INTERSECTION OF STANTON ST & FRANKLIN AVE.	18657355.27	384579.35	3732.88
11273	FOUND CITY MONUMENT AT INTERSECTION OF KANSAS ST & MYRTLE AVE.	18658442.44	385587.96	3718.28
11274	FOUND CITY MONUMENT AT INTERSECTION OF KANSAS ST & 4TH AVE.	18654649.39	385899.98	3787.83
11275	FOUND CITY MONUMENT AT INTERSECTION OF KANSAS ST & FATHER RAHM AVE.	18654326.34	385967.17	3786.86

IT'S THE LAW
 AND IT'S FREE - CALL BEFORE YOU DIG
 CALL TWO WORKING DAYS BEFORE YOU DIG IN TEXAS
 1-800-344-8377
 (1-800-DIG-TESS)

ES LA LEY
 GRATIS PARA USTED - LLAME ANTES DE EXCAVAR
 LLAME 2 DIAS DE TRABAJO ANTES DE EXCAVAR EN TEXAS
 1-800-344-8377
 (1-800-DIG-TESS)

STATE OF TEXAS
 PROFESSIONAL LAND SURVEYOR
 5572

FRANK E. SPONER & ASSOCIATES, INC.
 (Including San Antonio & El Paso)
 1306 MONTANA AVE.
 EL PASO, TX 79902
 TEL: (915) 523-4400
 FAX: (915) 523-4573
 www.fesai.com

URS
 2820 Montana Suite 200
 El Paso, Texas 79903
 (915) 493-6466

TYPE REGISTRATION NO. P-7382

COEP STREETCAR
 CONTROL SHEET

0180

CONT	RECT	JOB	REMARK
VARIOUS			
DATE	COUNTY	SHEET NO.	
EL PASO	EL PASO	30	

DATE: 6/18/2015 5:15:13 PM
 FILE: c:\working\cor10\kenyon\transportation\dms3676\RDW_PP_DT-18.dgn

DATE: 6/18/2015 5:15:13 PM
 FILE: c:\working\cor10\kenyon\transportation\dms3676\RDW_PP_DT-18.dgn

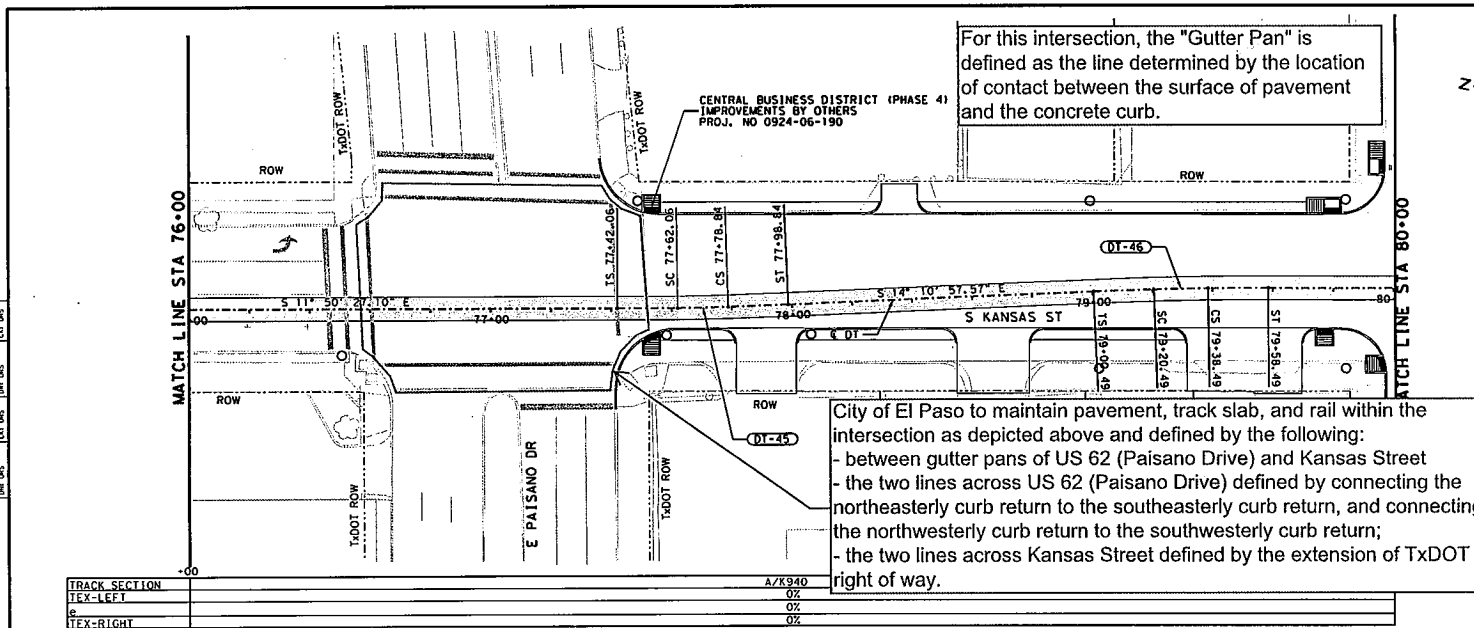

LEGEND

- LIMITS OF STREET RECONSTRUCTION
- CENTERLINE STREETCAR ALIGNMENT
- TRACK SLAB
- TRACK SLAB OVER UTILITY VAULT SEE DETAIL K956
- CURVE NAME
- PROPOSED OCS POLE

- NOTES:
- SEE TRAFFIC SIGNAL SHEETS FOR TRAFFIC SIGNAL MODIFICATIONS.
 - SEE UTILITY SHEETS FOR EXISTING AND PROPOSED UTILITY INFORMATION.
 - REFER TO HORIZONTAL ALIGNMENT DATA SHEETS FOR CURVE DATA AND ALIGNMENT INFORMATION.
 - SEE STOP DETAIL SHEETS FOR PROPOSED STOP INFORMATION.
 - CONTRACTOR TO FIELD ADJUST TRACK SLOPE TRANSITIONS AS NECESSARY.
 - BASEMENT INFORMATION SHOWN HEREON IS APPROXIMATE AND BASED ON CDD II AND CDD (I) AS-BUILTS AND IDENTIFICATION OF SURFACE FEATURES ONLY.
 - EXISTING ROADWAY PROFILE MAY VARY FROM SURVEY PERFORMED SPRING 2013.
 - SEE GEOTECH REPORT FOR INFORMATION REGARDING BORE HOLES.
 - SEE STREET RECONSTRUCTION SHEETS FOR PROPOSED RECONSTRUCTION LIMITS.
 - SEE TYPICAL SECTIONS FOR WIDENED TRACK SLAB LIMITS.
 - SEE TRACK DETAIL DRAWING SERIES K940 TO K956 FOR TRACK SLAB AND SPECIAL TRACKWORK DETAILS.
 - SEE OVERHEAD CONTACT SYSTEM SHEETS FOR PROPOSED OCS POLE LAYOUT.

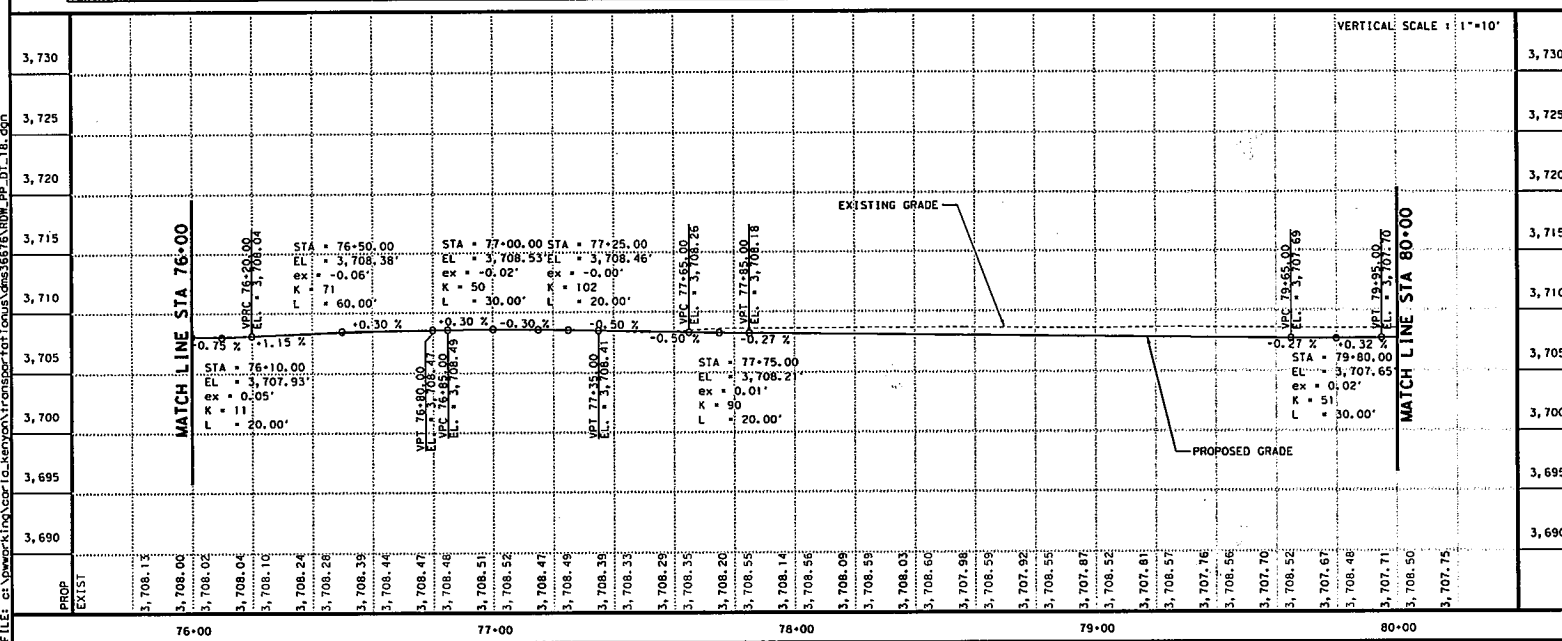

NO	DATE	REVISION	APPROVED
1	6/19/15		

DEREK E. BENEDICT
 112844
 6/19/15

2825 Montrose Suite 205
 El Paso, Texas 79903
 (915) 493-5468

TRPE REGISTRATION NO. F-3162

COEP STREETCAR
TRACK PLAN
AND PROFILE
 STA 76+00 TO STA 80+00

K117

CDMT	SECT	JOB	ROADWAY
D151	COUNTY	SHEET NO.	VARIOUS

EL PASO

EL PASO

59

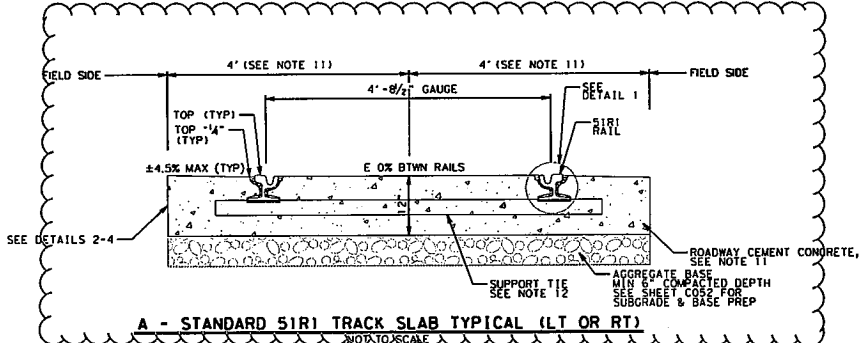

A - STANDARD 51R1 TRACK SLAB TYPICAL (LT OR RT)
NOT TO SCALE

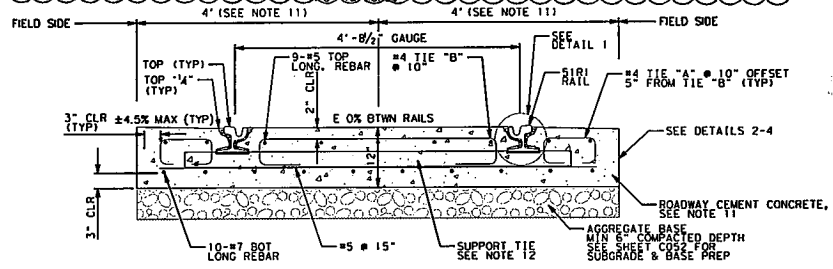

B - REINFORCED 51R1 TRACK SLAB TYPICAL (LT OR RT)
NOT TO SCALE

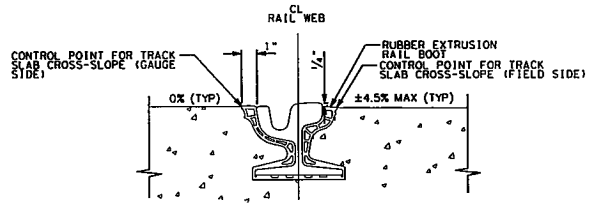

DETAIL 1 - 51R1 RAIL WITH BOOT
NOT TO SCALE

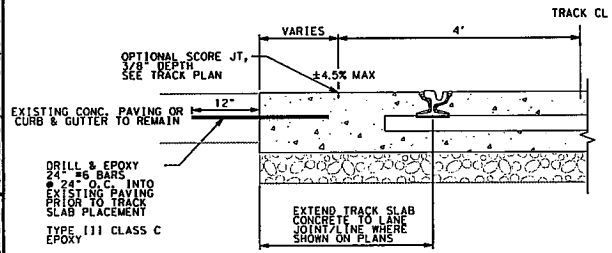

DETAIL 2 - TRACK SLAB ADJ. TO EX. CONC. PAVING
NOT TO SCALE

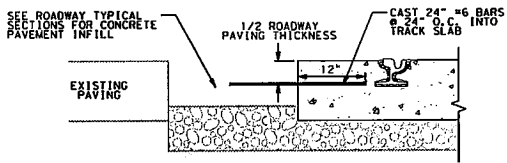

DETAIL 3 - TRACK SLAB ADJ. TO PROPOSED CONC. PAVING
NOT TO SCALE

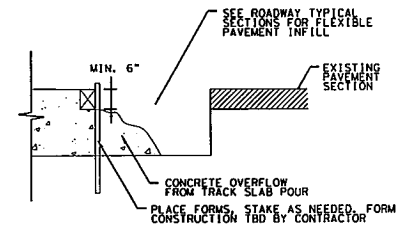

DETAIL 4 - TRACK SLAB ADJACENT TO PROPOSED FLEXIBLE PAVEMENT
NOT TO SCALE

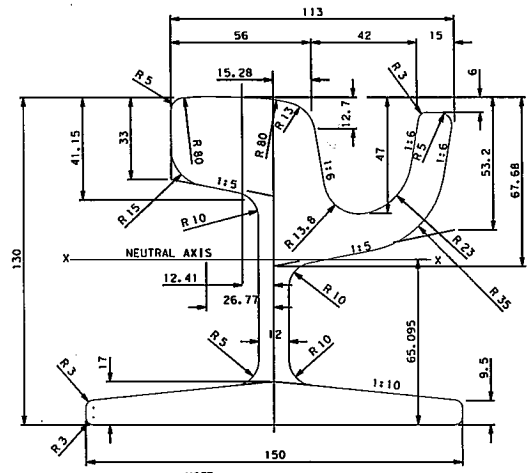

51R1 RAIL
NOT TO SCALE

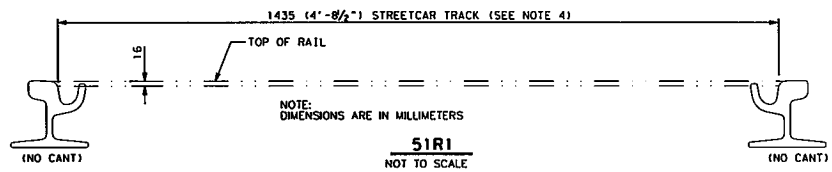

51R1
NOT TO SCALE

- GENERAL NOTES**
1. CONCRETE SHALL BE ROADWAY CEMENT CONCRETE UNLESS NOTED OTHERWISE.
 2. REINFORCING SHALL BE UNCOATED DEFORMED BARS WITH A MINIMUM YIELD STRENGTH OF 60,000 PSI.
 3. REINFORCING COVER SHALL BE 3\"/>

DATE: 7/21/2015 3:06:40 PM
FILE: c:\pwworking\URS\corporate\transportation\36676\DWG\TR_00.dwg

NO.	DATE	REVISION	APPROVED
1	7/21/15		
2			
3			
4			

7/24/15

URS

2829 Montross Suite 200
El Paso, Texas 79903
(915) 493-6468

TPT REGISTRATION NO. F-3162

COEP STREETCAR

TRACK SLAB

DETAILS

COMP	SECT	JOB	REVISION
0924	06	446	VARIOUS
0151	COUNTY		SHEET NO.
EL PASO	EL PASO		122

20 of 28

INDEX OF SHEETS

SHEET NO.	DESCRIPTION
1	TITLE SHEET
2-10	INDEX OF SHEETS

CAMINO REAL REGIONAL MOBILITY AUTHORITY

PLANS OF PROPOSED URBAN STREETCAR

PROJECT NO. ()

CITY OF EL PASO STREETCAR EL PASO COUNTY

VOLUME 1 OF 4 - CIVIL/TRACK

FOR THE CONSTRUCTION OF AN URBAN STREETCAR SYSTEM CONSISTING OF
GRADING, STRUCTURES, SURFACE AND SUBSURFACE IMPROVEMENTS,
TRACKWORK, AND MAINTENANCE/STORAGE FACILITY

STATE PROJECT NO.			
()			
CDIST	SECT	JOB	HIGHWAY
092406	446	VARIOUS	
DIST	COUNTY	SHEET NO.	
EL PASO	EL PASO	1	

FINAL PLANS

LETTING DATE: _____

DATE CONTRACTOR BEGAN WORK: _____

DATE WORK WAS COMPLETED & ACCEPTED: _____

FINAL CONTRACT COST: \$ _____

CONTRACTOR: _____

TxDOT MUA no. _____ - Exhibit B

US 62 (El Paso St) at Father Rahm Ave

REGISTERED ACCESSIBILITY SPECIALIST (RAS)
INSPECTION REQUIRED
TDLR No. EABPRJB5819210

REQUIRED SIGNS SHALL BE IN ACCORDANCE WITH
BC (11)-14 THRU BC (12)-14 AND THE "TEXAS
MANUAL ON UNIFORM TRAFFIC CONTROL DEVICES".

URS

2829 Montana Suite 206
El Paso, Texas 79903
(915) 493-6468

TBPE REGISTRATION NO. F-3162

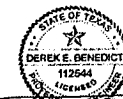

SUBMITTED FOR LETTING: _____

PROJECT MANAGER
CAMINO REAL REGIONAL MOBILITY AUTHORITY

STANTON/OREGON LOOP
CSJ:
STAN STA 200+00

MAINT./STORAGE FACILITY

DOWNTOWN LOOP
CSJ:
BEG DT STA 10+00

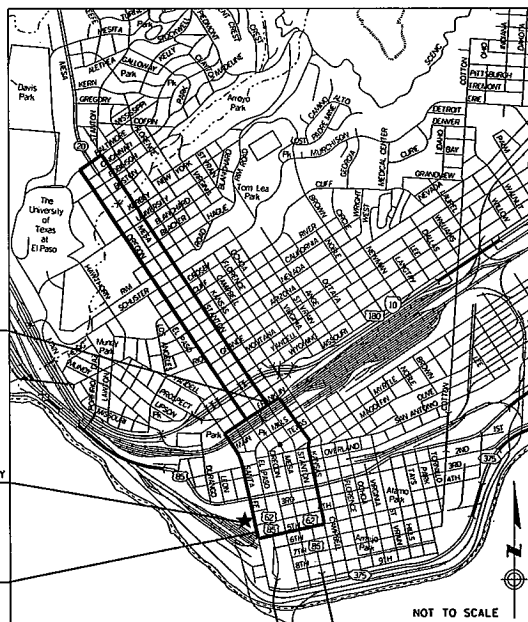

NOT TO SCALE

LIMITS:

DOWNTOWN LOOP LIMITS:

FROM INTERSECTION OF FATHER RAHM AVE AND SANTA FE ST, ALONG
SANTA FE ST TO FRANKLIN AVE, ALONG FRANKLIN AVE TO KANSAS ST,
ALONG KANSAS ST TO FATHER RAHM AVE, ALONG FATHER RAHM AVE TO
SANTA FE ST.

STANTON/OREGON LOOP LIMITS:

FROM INTERSECTION OF STANTON ST AND FRANKLIN AVE, ALONG
STANTON TO BALTIMORE DR, ALONG BALTIMORE DR TO OREGON ST,
ALONG OREGON ST TO FRANKLIN AVE.

COUNTY _____ PROJ. NO. _____
HWY. NO. _____ LETTING DATE _____
DATE ACCEPTED _____

21 of 28

IT'S THE LAW
AND IT'S FREE - CALL BEFORE YOU DIG
 CALL TWO WORKING DAYS BEFORE YOU DIG IN TEXAS 1-800-344-8377
 (1-800-DIG-TESS)

ES LA LEY
GRATIS PARA USTED - LLAME ANTES DE EXCAVAR
 LLAME 2 DIAS DE TRABAJO ANTES DE EXCAVAR EN TEXAS 1-800-344-8377
 (1-800-DIG-TESS)

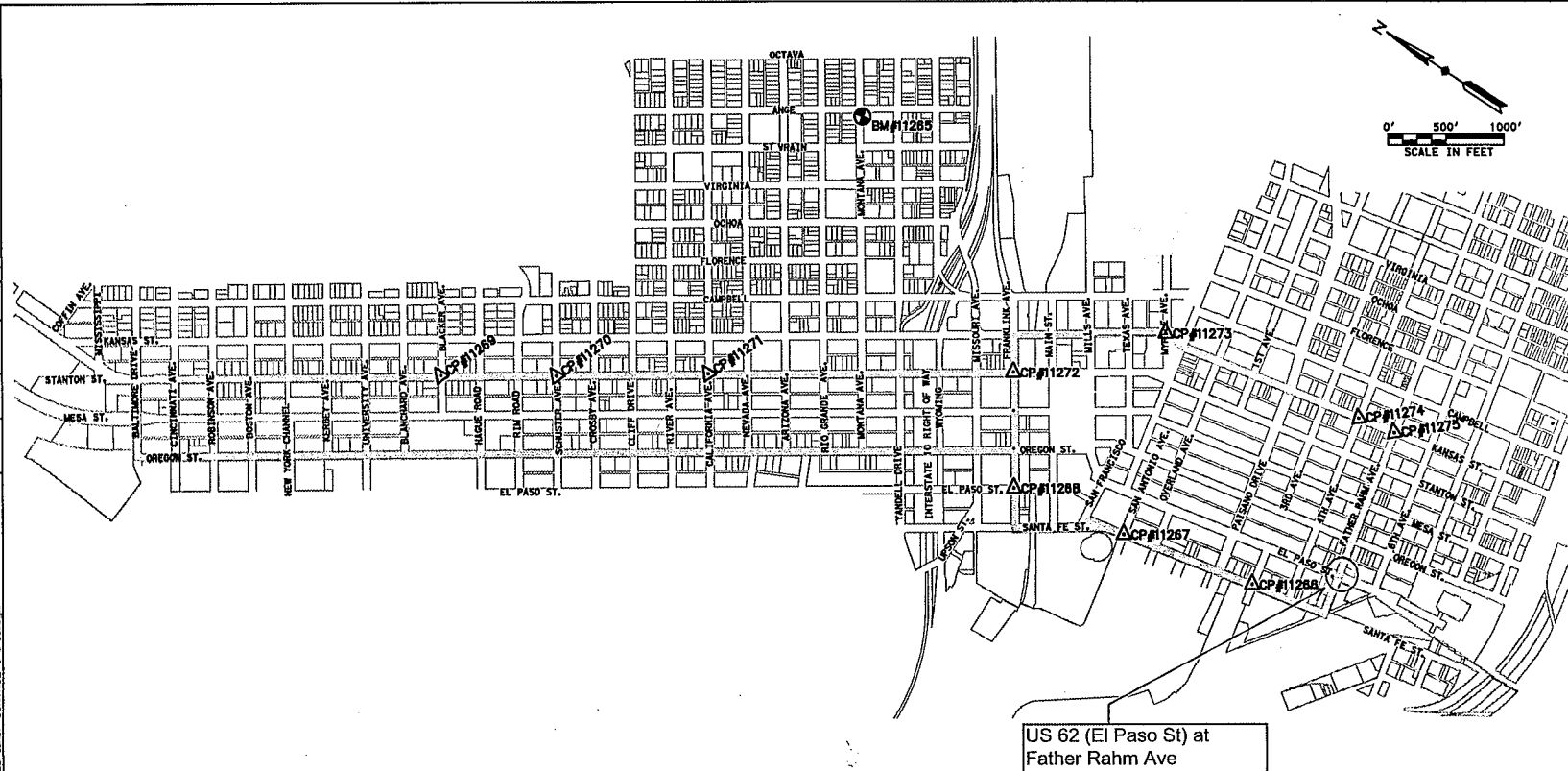

LEGEND

BENCHMARK
CONTROL POINT

NOTE:

1. HORIZONTAL CONTROL: MAPPING COORDINATES AND BEARINGS ARE REFERENCED TO THE TEXAS COORDINATE SYSTEM, NORTH TEXAS CENTRAL ZONE 4203, NAD83. UNIT OF MEASURE: U.S. SURVEY FOOT. COORDINATES SHOWN HEREON ARE GRID (STATE PLANE).

2. VERTICAL CONTROL IS BASED ON NAVD 88 DATUM, ELEVATION: RECOVERED FROM NOS MONUMENT:

BM#11265
 DESIGNATION: P 146

DESCRIPTION:
 IN EL PASO, AT THE INTERSECTION OF ANGE ST. AND MONTANA AVE., IN A CONCRETE CURB ALONG THE SOUTHEAST SIDE OF THE AVENUE, 19.2 (4' 10.0") SOUTH OF THE STREET CENTER, 7.6 (24.9') SOUTHWEST OF AND LEVEL WITH THE AVENUE CENTERLINE, AND 5.5 (18.0') SOUTHWEST OF A UTILITY POLE.

ELEVATION = 3742.24

US 62 (El Paso St) at
 Father Rahm Ave

BENCHMARKS				
BM #	DESCRIPTION	NORTHING (Y)	EASTING (X)	ELEVATION (Z)
11265	FOUND BRASS CAP - NGS MONUMENT "P146"	10659667.26	385723.73	3742.24

CONTROL POINTS				
CP #	DESCRIPTION	NORTHING (Y)	EASTING (X)	ELEVATION
11266	FOUND CITY MONUMENT AT INTERSECTION OF SANTA FE ST. & 3RD AVE.	10654632.82	384281.54	3789.92
11267	FOUND CITY MONUMENT AT INTERSECTION OF SANTA FE ST. & SAN ANTONIO AVE.	10655793.25	383949.68	3711.85
11268	FOUND CITY MONUMENT AT INTERSECTION OF EL PASO ST. & FRANKLIN AVE.	10656884.91	383757.25	3738.39
11269	FOUND CITY MONUMENT AT INTERSECTION OF STANTON ST & BLACKER AVE.	10651467.74	381826.16	3925.85
11270	FOUND CITY MONUMENT AT INTERSECTION OF STANTON ST & SCHUSTER AVE.	10658631.47	382374.88	3886.79
11271	FOUND CITY MONUMENT AT INTERSECTION OF STANTON ST & CALIFORNIA AVE.	10659548.84	383111.86	3794.98
11272	FOUND CITY MONUMENT AT INTERSECTION OF STANTON ST & FRANKLIN AVE.	10657355.27	384579.35	3732.88
11273	FOUND CITY MONUMENT AT INTERSECTION OF KANSAS ST & MYRTLE AVE.	10656442.44	385587.98	3718.28
11274	FOUND CITY MONUMENT AT INTERSECTION OF KANSAS ST & 4TH AVE.	10654649.39	385899.98	3787.83
11275	FOUND CITY MONUMENT AT INTERSECTION OF KANSAS ST & FATHER RAHM AVE.	10654326.34	385967.17	3786.86

STATE OF TEXAS
PROFESSIONAL LAND SURVEYOR
5572
CHARLES HENRY GUTIERREZ

FRANK J. SPOWELL & ASSOCIATES, INC.
 (Surveying and Engineering & Mapping)
 1100 NORTH FAYETTE AVE.
 EL PASO, TX 79902
 P: (915) 533-4800
 F: (915) 533-4573
 www.fsa.com

URS
 2829 Montana Suite 205
 El Paso, Texas 79903
 (915) 493-6168

TRIP REGISTRATION NO. F-382

COEP STREETCAR
CONTROL SHEET

0188

CONT	WEST	JOB	REMARK
CONT	COUNTY	VARIOUS	
EL PASO	EL PASO	SHEET NO.	30

DATE: 6/18/2015 5:16:45 PM
 FILE: c:\working\cor10-kenyon\transportation\ams5676\ndm-pp-dt-24.dgn

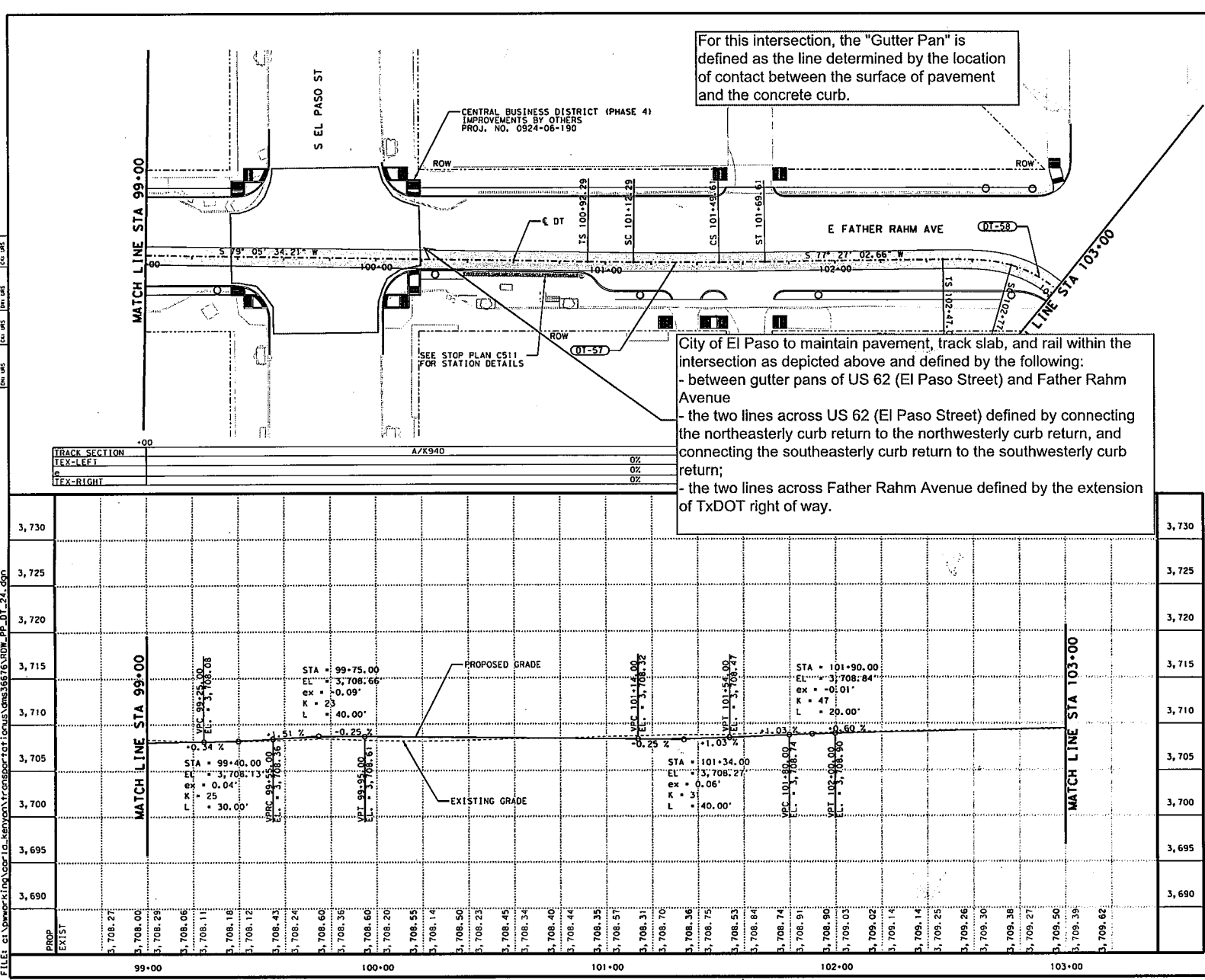

- LEGEND**
- LIMITS OF STREET RECONSTRUCTION
 - CENTERLINE STREETCAR ALIGNMENT
 - TRACK SLAB
 - TRACK SLAB OVER UTILITY VAULT SEE DETAIL K956
 - CURVE NAME
 - PROPOSED OCS POLE
- NOTES:**
1. SEE TRAFFIC SIGNAL SHEETS FOR TRAFFIC SIGNAL MODIFICATIONS.
 2. SEE UTILITY SHEETS FOR EXISTING AND PROPOSED UTILITY INFORMATION.
 3. REFER TO HORIZONTAL ALIGNMENT DATA SHEETS FOR CURVE DATA AND ALIGNMENT INFORMATION.
 4. SEE STOP DETAIL SHEETS FOR PROPOSED STOP INFORMATION.
 5. CONTRACTOR TO FIELD ADJUST TRACK SLOPE TRANSITIONS AS NECESSARY.
 6. BASEMENT INFORMATION SHOWN HEREON IS APPROXIMATE AND BASED ON CBD II AND CBD III AS-BUILTS AND IDENTIFICATION OF SURFACE FEATURES ONLY.
 7. EXISTING ROADWAY PROFILE MAY VARY FROM SURVEY PERFORMED SPRING 2013.
 8. SEE GEOTECH REPORT FOR INFORMATION REGARDING BORE HOLES.
 9. SEE STREET RECONSTRUCTION SHEETS FOR PROPOSED RECONSTRUCTION LIMITS.
 10. SEE TYPICAL SECTIONS FOR WIDENED TRACK SLAB LIMITS.
 11. SEE TRACK DETAIL DRAWING SERIES K940 TO K956 FOR TRACK SLAB AND SPECIAL TRACKWORK DETAILS.
 12. SEE OVERHEAD CONTACT SYSTEM SHEETS FOR PROPOSED OCS POLE LAYOUT.

NO.	DATE	REVISION	APPROVED
1	6/19/15		
2			
3			
4			

URS

2829 Montana Suite 206
 El Paso, Texas 79903
 (915) 833-6460

TDP REGISTRATION NO. F-3162

COEP STREETCAR

TRACK PLAN

AND PROFILE

STA 99+00 TO STA 103+00

K123

CDIST	SECT	JOB	REVISION
0151 <td></td> <td></td> <td>VARIOUS</td>			VARIOUS
EL PASO	EL PASO		SHEET NO. 65

23 of 28

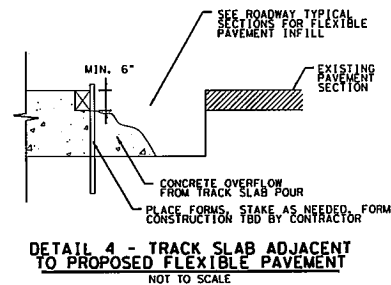
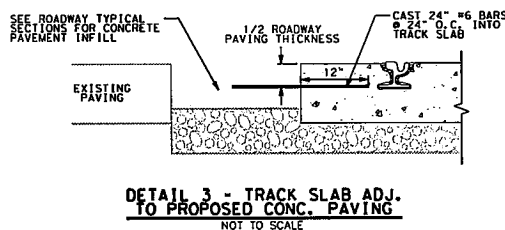
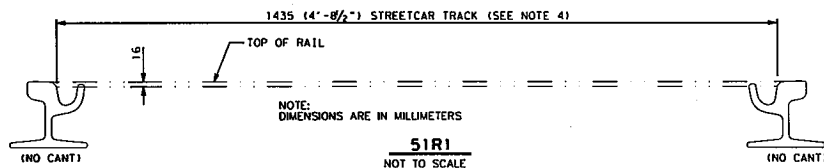
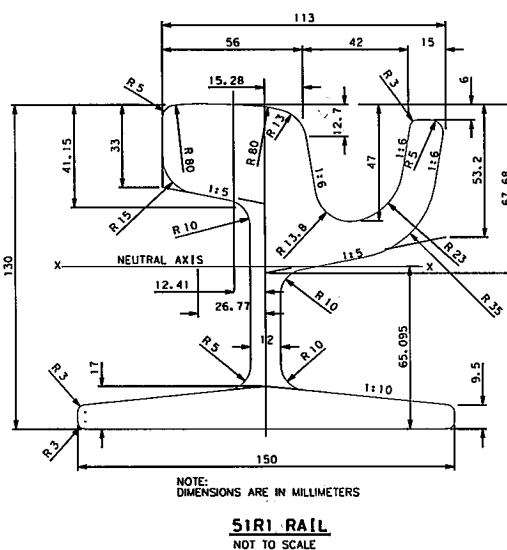
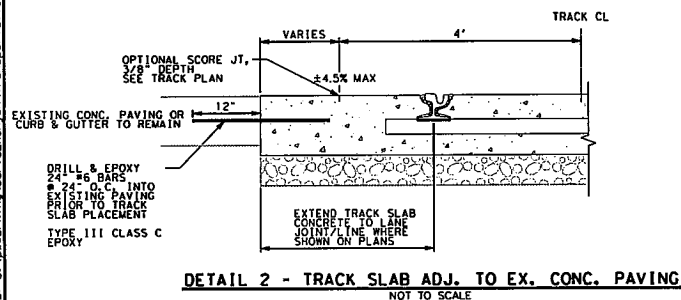
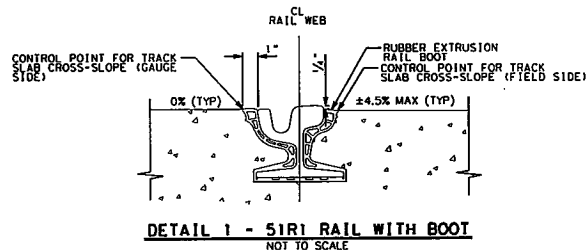
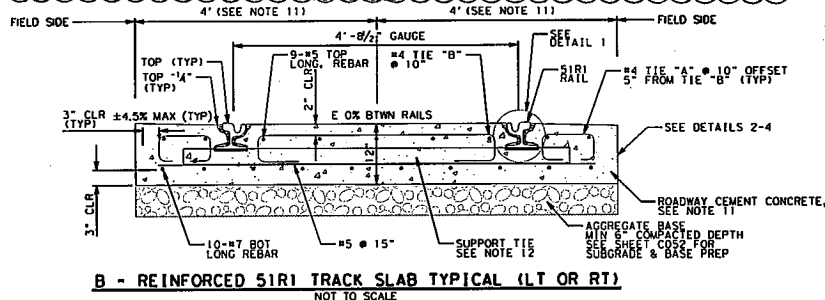

- GENERAL NOTES
1. CONCRETE SHALL BE ROADWAY CEMENT CONCRETE UNLESS NOTED OTHERWISE.
2. REINFORCING SHALL BE UNCOATED DEFORMED BARS WITH A MINIMUM YIELD STRENGTH OF 60,000 PSI.
3. REINFORCING COVER SHALL BE 3" MINIMUM AT BASE AND SIDES OF TRACK SLAB AND 2" MINIMUM ON TOP.
4. TYPICAL TRACK GAUGE SHALL BE 4'-8 1/2".
5. AGGREGATE BASE AS REQUIRED IN SPECIFICATIONS AND AS SHOWN ON THE ROAD TYPICALS (SHEET C052)
6. JOINT GROOVES PLACED TRANSVERSELY ACROSS TRACK SLAB SHALL BE PLACED ABOVE EVERY SUPPORT TIE. GROOVE DEPTH = 3/8" MINIMUM.
7. PROPOSED PROFILE IS TOP OF LOW RAIL.
8. TOP OF CONCRETE ON FIELD SIDE OF RAIL SHALL BE 1/4" BELOW TOP OF RAIL ELEVATION.
9. TRACK PLANS INDICATE WHICH CURVES ARE SUPERELEVATED.
10. COORDINATE TRACKING POWER OR SIGNAL BOND LOCATIONS WITH SYSTEMS CONTRACTOR PRIOR TO POURING CONCRETE INFILL.
SEE DWG 8670 FOR BONDING BLOCKOUT DETAILS.
11. SEE TRACK PLAN FOR LIMITS OF REINFORCED TRACK SLAB, WIDENED TRACKS AND TRANSITION RAILS. FOR VARIABLE SLAB WIDTHS ADJACENT TO EXISTING CONCRETE PAVING SEE DETAIL B THIS SHEET
12. SUPPORT TIES SHALL BE SPACED AT 10 FOOT INTERVALS ON TANGENTS AND CURVES WITH A RADIUS LARGER THAN 500 FEET. FOR CURVES WITH A RADIUS OF 500 FEET OR LESS, SUPPORT TIES SHALL BE PLACED AT 5 FOOT INTERVALS.

NO	DATE	REVISION	APPROV
1	1		
1	1		
1	1		
1	1		



DEREK E. BENEDET
112544
REGISTERED
NATIONAL ENGINEER

7/24/1

[Signature]



2829 Montblanc Suite 2
El Paso, Texas 79903
(915) 433-5469

TOPIC REGISTRATION NO. F-3162

COEP STREETCART

TRACK SLAB

DETAILS



K9-

COMP	SECT	JOB	WISDOM
0924	06	446	VARIOUS
DIST	COUNTY	SHEET	
EL PASO	EL PASO	127	

INDEX OF SHEETS

SHEET NO.	DESCRIPTION
1	TITLE SHEET
2-10	INDEX OF SHEETS

CAMINO REAL REGIONAL MOBILITY AUTHORITY

PLANS OF PROPOSED URBAN STREETCAR

PROJECT NO. ()

CITY OF EL PASO STREETCAR EL PASO COUNTY

VOLUME 1 OF 4 - CIVIL/TRACK

FOR THE CONSTRUCTION OF AN URBAN STREETCAR SYSTEM CONSISTING OF
GRADING, STRUCTURES, SURFACE AND SUBSURFACE IMPROVEMENTS,
TRACKWORK, AND MAINTENANCE/STORAGE FACILITY

STATE PROJECT NO.			
CONTRACT	SECTION	JOB	HIGHWAY
0924	06	446	VARIOUS
DIST	COUNTY	SHEET NO.	
EL PASO	EL PASO	1	

FINAL PLANS

LETTING DATE: _____
DATE CONTRACTOR BEGAN WORK: _____
DATE WORK WAS COMPLETED & ACCEPTED: _____
FINAL CONTRACT COST: \$ _____
CONTRACTOR: _____

TxDOT MUA no. _____ - Exhibit B

US 85 (Stanton Street) at Father Rahm Avenue

REGISTERED ACCESSIBILITY SPECIALIST (RAS)
INSPECTION REQUIRED
TDLR No. EABPRJB5819210

REQUIRED SIGNS SHALL BE IN ACCORDANCE WITH
BC (11)-14 THRU BC (12)-14 AND THE "TEXAS
MANUAL ON UNIFORM TRAFFIC CONTROL DEVICES".

URS

2829 Montana Suite 206
El Paso, Texas 79903
(915) 493-6468

TBPE REGISTRATION NO. F-3162



SUBMITTED FOR LETTING: _____

PROJECT MANAGER
CAMINO REAL REGIONAL MOBILITY AUTHORITY

STANTON/OREGON LOOP
CSJ
STAN STA 200+00

MAINT./STORAGE FACILITY

DOWNTOWN LOOP
CSJ
BEG DT STA 10+00

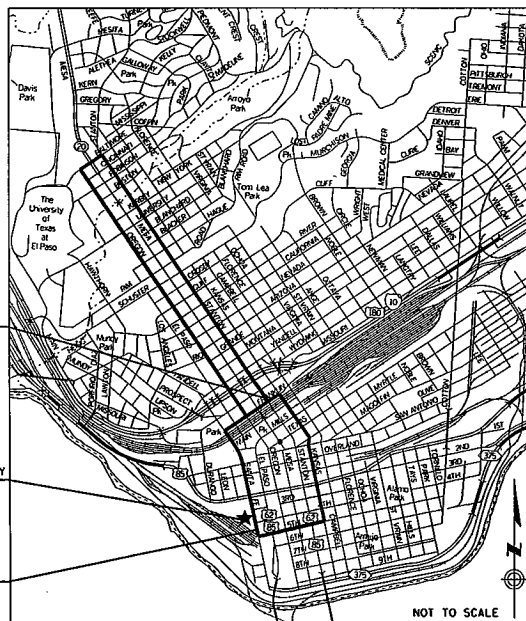

NOT TO SCALE

LIMITS:

DOWNTOWN LOOP LIMITS:

FROM INTERSECTION OF FATHER RAHM AVE AND SANTA FE ST. ALONG
SANTA FE ST TO FRANKLIN AVE, ALONG FRANKLIN AVE TO KANSAS ST.
ALONG KANSAS ST TO FATHER RAHM AVE, ALONG FATHER RAHM AVE TO
SANTA FE ST.

STANTON/OREGON LOOP LIMITS:



FROM INTERSECTION OF STANTON ST AND FRANKLIN AVE, ALONG
STANTON TO BALTIMORE DR, ALONG BALTIMORE DR TO OREGON ST,
ALONG OREGON ST TO FRANKLIN AVE.

COUNTY: _____ PROJ. NO.: _____
Hwy. No.: _____ LETTING DATE: _____
DATE ACCEPTED: _____

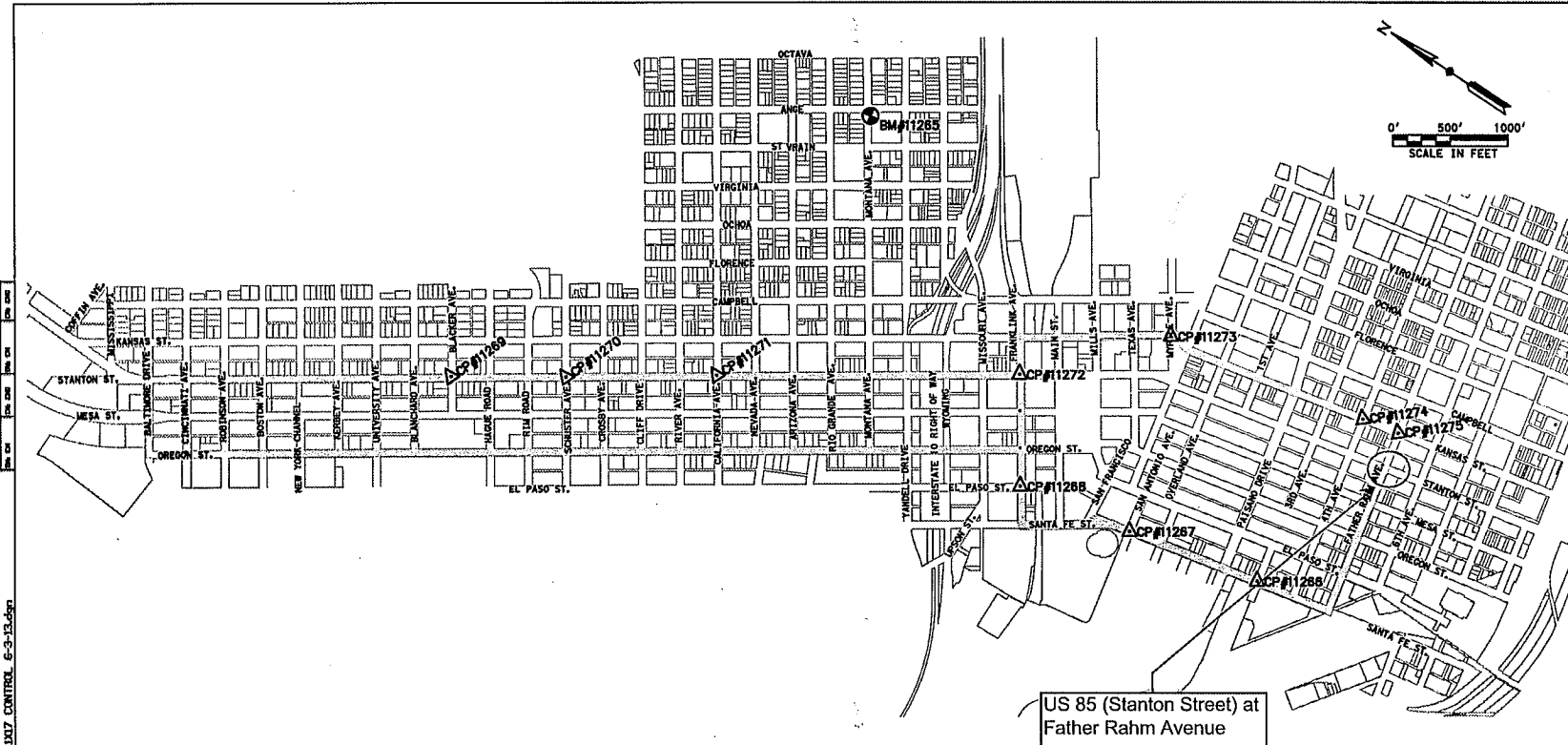
25 of 28



LEGEND

 BENCHMARK
 CONTROL POINT

NOTE:

1. HORIZONTAL CONTROL: MAPPING COORDINATES AND BEARINGS ARE REFERENCED TO THE TEXAS COORDINATE SYSTEM, NORTH TEXAS CENTRAL ZONE 4203, NAD83. UNIT OF MEASURE: U.S. SURVEY FOOT. COORDINATES SHOWN HEREON ARE GRID (STATE PLANE).

2. VERTICAL CONTROL IS BASED ON NAVD 88 DATUM, ELEVATION: RECOVERED FROM NGS MONUMENT:

BM#11265
 DESIGNATION: P 146

DESCRIPTION:
 IN EL PASO, AT THE INTERSECTION OF ANGE ST. AND MONTANA AVE., IN A CONCRETE CURB ALONG THE SOUTHEAST SIDE OF THE AVENUE, 19.2 M (63.0 FT) SOUTHWEST OF THE STREET CENTERLINE, 7.6 M (24.9 FT) SOUTHWEST OF AND LEVEL WITH THE AVENUE CENTERLINE, AND 5.5 M (18.0 FT) SOUTHWEST OF A UTILITY POLE.

ELEVATION = 3742.24

US 85 (Stanton Street) at
 Father Rahm Avenue

BENCHMARKS

BM #	DESCRIPTION	NORTHING (Y)	EASTING (X)	ELEVATION (Z)
11265	FOUND BRASS CAP - NGS MONUMENT "P146"	18659667.26	385723.73	3742.24

CONTROL POINTS

CP #	DESCRIPTION	NORTHING (Y)	EASTING (X)	ELEVATION
11266	FOUND CITY MONUMENT AT INTERSECTION OF SANTA FE ST. & 3RD AVE.	18654632.82	384281.54	3789.92
11267	FOUND CITY MONUMENT AT INTERSECTION OF SANTA FE ST. & SAN ANTONIO AVE.	18655793.25	383949.68	3711.85
11268	FOUND CITY MONUMENT AT INTERSECTION OF EL PASO ST. & FRANKLIN AVE.	18656804.91	383757.25	3738.39
11269	FOUND CITY MONUMENT AT INTERSECTION OF STANTON ST & BLACKER AVE.	18661467.74	381826.16	3925.85
11270	FOUND CITY MONUMENT AT INTERSECTION OF STANTON ST & SCHUSTER AVE.	18668631.47	382374.88	3888.79
11271	FOUND CITY MONUMENT AT INTERSECTION OF STANTON ST & CALIFORNIA AVE.	18659548.84	383111.86	3794.98
11272	FOUND CITY MONUMENT AT INTERSECTION OF STANTON ST & FRANKLIN AVE.	18657355.27	384579.35	3732.88
11273	FOUND CITY MONUMENT AT INTERSECTION OF KANSAS ST & MYRTLE AVE.	18656442.44	385587.98	3718.28
11274	FOUND CITY MONUMENT AT INTERSECTION OF KANSAS ST & 4TH AVE.	18654649.39	385899.98	3787.83
11275	FOUND CITY MONUMENT AT INTERSECTION OF KANSAS ST & FATHER RAHM AVE.	18654326.34	385967.17	3786.86

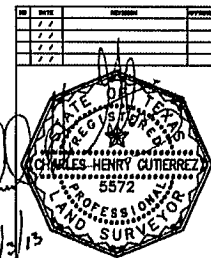

FRANK L. SPENCER & ASSOCIATES, INC.
 1100 MONTANA AVE
 EL PASO, TEXAS 79903
 (915) 472-5400
 FAX (915) 472-5402
 www.flsa.com

URS
 2829 Montana Suite 200
 El Paso, Texas 79903
 (915) 472-5400

TYPE RECONSTRUCTION NO. P-388

COEP STREETCAR

CONTROL SHEET

			
DATE	REVISION	JOB	REMARK
08/23/13			VARIOUS
CITY	COUNTY	SHEET NO.	
EL PASO	EL PASO	30	

IT'S THE LAW
 AND IT'S FREE - CALL BEFORE YOU DIG
 CALL TWO WORKING DAYS BEFORE YOU DIG IN TEXAS 1-800-344-8377
 (1-800-DIG-TESS)

ES LA LEY
 GRATIS PARA USTED - LLAME ANTES DE EXCAVAR
 LLAME 2 DIAS DE TRABAJO ANTES DE EXCAVAR EN TEXAS 1-800-344-8377
 (1-800-DIG-TESS)

26 of 28

For this intersection, the "Gutter Pan" is defined as the line determined by the location of contact between the surface of pavement and the concrete curb.

CENTRAL BUSINESS DISTRICT (PHASE 4)
IMPROVEMENTS BY OTHERS
PROJ. NO. 0924-06-190

0' 20' 40'
SCALE IN FEET

LEGEND

- LIMITS OF STREET RECONSTRUCTION
- CENTERLINE STREETCAR ALIGNMENT
- TRACK SLAB
- TRACK SLAB OVER UTILITY VAULT SEE DETAIL K956
- CX-CX CURVE NAME
- O PROPOSED OCS POLE

- NOTES:
- SEE TRAFFIC SIGNAL SHEETS FOR TRAFFIC SIGNAL MODIFICATIONS.
 - SEE UTILITY SHEETS FOR EXISTING AND PROPOSED UTILITY INFORMATION.
 - REFER TO HORIZONTAL ALIGNMENT DATA SHEETS FOR CURVE DATA AND ALIGNMENT INFORMATION.
 - SEE STOP DETAIL SHEETS FOR PROPOSED STOP INFORMATION.
 - CONTRACTOR TO FIELD ADJUST TRACK SLOPE TRANSITIONS AS NECESSARY.
 - BASEMENT INFORMATION SHOWN HEREON IS APPROXIMATE AND BASED ON CBD II AND CBD III AS-BUILTS AND IDENTIFICATION OF SURFACE FEATURES ONLY.
 - EXISTING ROADWAY PROFILE MAY VARY FROM SURVEY PERFORMED SPRING 2013.
 - SEE GEOTECH REPORT FOR INFORMATION REGARDING BORE HOLES.
 - SEE STREET RECONSTRUCTION SHEETS FOR PROPOSED RECONSTRUCTION LIMITS.
 - SEE TYPICAL SECTIONS FOR WIDENED TRACK SLAB LIMITS.
 - SEE TRACK DETAIL DRAWING SERIES K940 TO K956 FOR TRACK SLAB AND SPECIAL TRACKWORK DETAILS.
 - SEE OVERHEAD CONTACT SYSTEM SHEETS FOR PROPOSED OCS POLE LAYOUT.

City of El Paso to maintain pavement, track slab, and rail within the intersection as depicted above and defined by the following:

- between gutter pans of US 85 (Stanton Street) and Father Rahm Avenue
- the two lines across US 85 (Stanton Street) defined by connecting the northeasterly curb return to the northwesterly curb return, and connecting the southeasterly curb return to the southwesterly curb return;
- the two lines across Father Rahm Avenue defined by the extension of TxDOT right of way.

TRACK SECTION	A/K940	B/K940	A/K940
TEX-LEFT			0%
TEX-RIGHT			0%

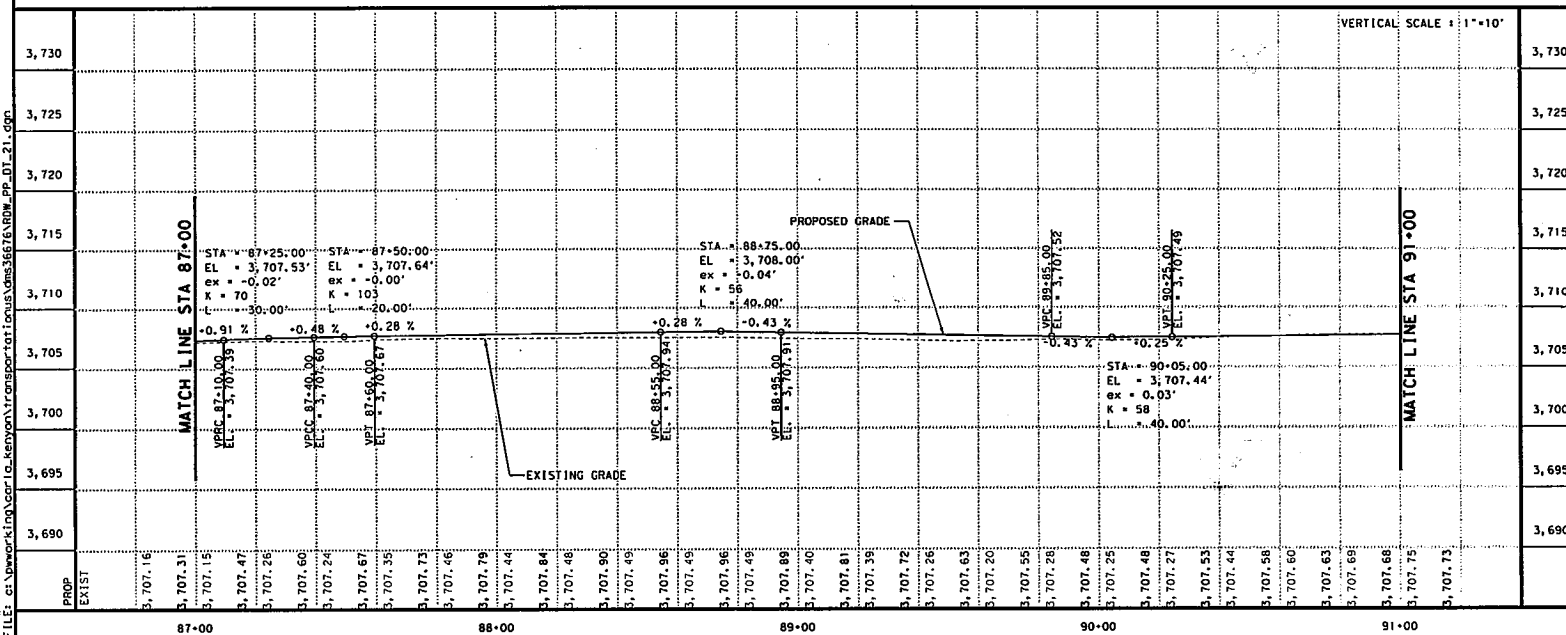

NO	DATE	REVISION	APPROVED
1	6/18/2015		
2			
3			
4			

DEREK E. BENEDICT
112544
6/19/15

URS

2029 Montana Suite 206
El Paso, Texas 79903
(915) 493-6468

TEPE REGISTRATION NO. F-3162

**COEP STREETCAR
TRACK PLAN
AND PROFILE**

STA 87+00 TO STA 91+00

CONT	SECT	JOB	REVISION
			VARIOUS
DIST	COUNTY	SHEET NO.	
EL PASO	EL PASO	62	

27828

DATE: 7/21/2015 3:06:40 PM
 FILE: c:\pwworking\kenyon\transport\locus\ans36676\RDW-TR-DT-00.dgn

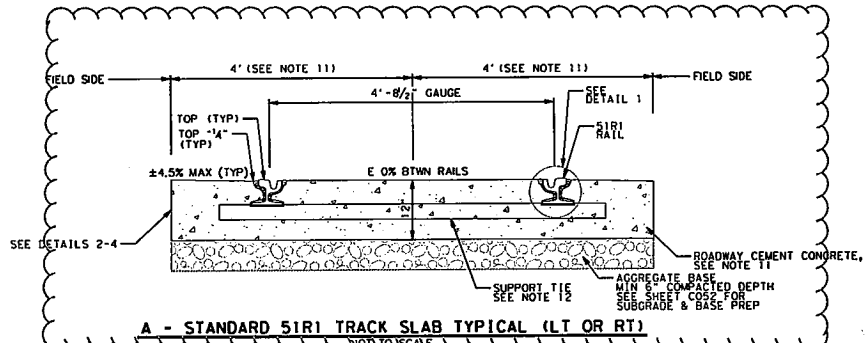

A - STANDARD 51R1 TRACK SLAB TYPICAL (LT OR RT)
 NOT TO SCALE

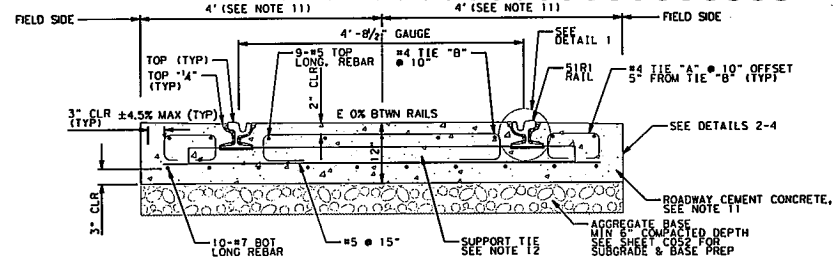

B - REINFORCED 51R1 TRACK SLAB TYPICAL (LT OR RT)
 NOT TO SCALE

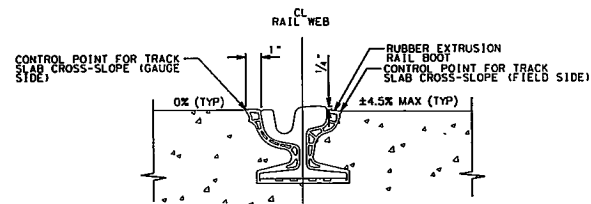

DETAIL 1 - 51R1 RAIL WITH BOOT
 NOT TO SCALE

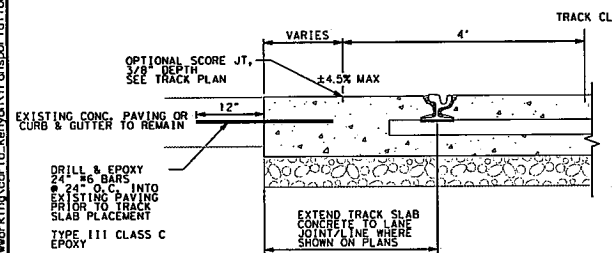

DETAIL 2 - TRACK SLAB ADJ. TO EX. CONC. PAVING
 NOT TO SCALE

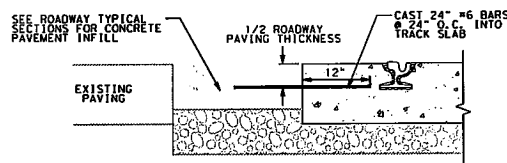

DETAIL 3 - TRACK SLAB ADJ. TO PROPOSED CONC. PAVING
 NOT TO SCALE

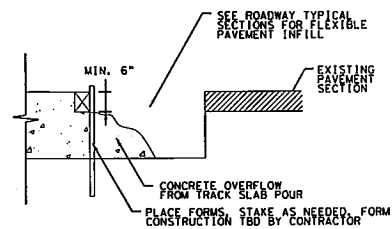

DETAIL 4 - TRACK SLAB ADJACENT TO PROPOSED FLEXIBLE PAVEMENT
 NOT TO SCALE

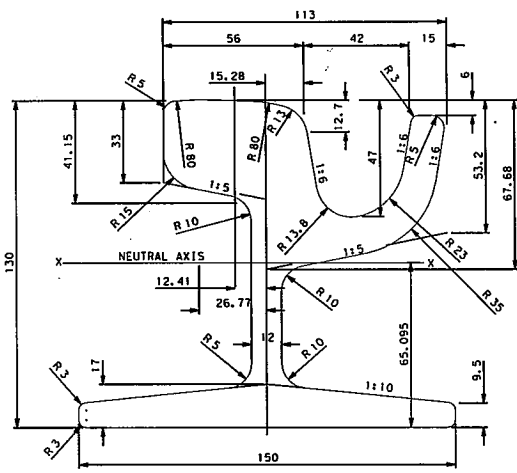

51R1 RAIL
 NOT TO SCALE

- GENERAL NOTES**
1. CONCRETE SHALL BE ROADWAY CEMENT CONCRETE UNLESS NOTED OTHERWISE.
 2. REINFORCING SHALL BE UNCOATED DEFORMED BARS WITH A MINIMUM YIELD STRENGTH OF 60,000 PSI.
 3. REINFORCING COVER SHALL BE 3" MINIMUM AT BASE AND SIDES OF TRACK SLAB AND 2" MINIMUM ON TOP.
 4. TYPICAL TRACK GAUGE SHALL BE 4'-8 1/2".
 5. AGGREGATE BASE AS REQUIRED IN SPECIFICATIONS AND AS SHOWN ON THE ROAD TYPICALS (SHEET C052)
 6. JOINT GROOVES PLACED TRANSVERSELY ACROSS TRACK SLAB SHALL BE PLACED ABOVE EVERY SUPPORT TIE. GROOVE DEPTH = 3/8" MINIMUM.
 7. PROPOSED PROFILE IS TOP OF LOW RAIL.
 8. TOP OF CONCRETE ON FIELD SIDE OF RAIL SHALL BE 1/4" BELOW TOP OF RAIL ELEVATION.
 9. TRACK PLANS INDICATE WHICH CURVES ARE SUPERELEVATED.
 10. COORDINATE TRACTION POWER OR SIGNAL BOND LOCATIONS WITH SYSTEMS CONTRACTOR PRIOR TO POURING CONCRETE INFILL. SEE DWG J670 FOR BONDING BLOCKOUT DETAILS.
 11. SEE TRACK PLAN FOR LIMITS OF REINFORCED TRACK SLAB, WIDENED TRACK SLAB, AND TRANSITION RAILS. FOR VARIABLE SLAB WIDTHS ADJACENT TO EXISTING CONCRETE PAVING SEE DETAIL B THIS SHEET.
 12. SUPPORT TIES SHALL BE SPACED AT 10 FOOT INTERVALS ON TANGENTS AND CURVES WITH A RADIUS LARGER THAN 500 FEET. FOR CURVES WITH A RADIUS OF 500 FEET OR LESS, SUPPORT TIES SHALL BE PLACED AT 5 FOOT INTERVALS.

NO.	DATE	REVISION	APPROVED
1	7/24/15		

DEREK E. BENEVOLO
 112544
 LICENSED PROFESSIONAL ENGINEER

URS 2829 Montrose Suite 206
 13100 Texas 75063
 (915) 493-6468

TPC REGISTRATION NO. T-3162

COEP STREETCAR
TRACK SLAB
DETAILS

K940

DATE	REV.	BY	CHKD.	DESCRIPTION
09/24/06	446			VARIOUS

DIST. COUNTY SHEET NO.
 EL PASO EL PASO 122

28 of 28

EXHIBIT C

APPROVED CONSTRUCTION PLANS

Plans will be delivered electronically by CD via standard mail and a copy of the CD will be filed with the fully executed Agreement.

EXHIBIT D
CERTIFICATE OF INSURANCE (TXDOT
FORM 1560)



CERTIFICATE OF INSURANCE

Form 15
(Rev. 07/92)
Previous editions of this form may not be used.
Page 1 of 2

Agents should complete the form providing all requested information then either fax or mail this form directly to the address listed on page two of this form. Copies of endorsement listed below are not required as attachments to this certificate.

This certificate is issued as a matter of information only and confers no rights upon the certificate holder. This certificate does not confer any rights or obligation other than the rights and obligations conveyed by the policies referenced on this certificate. The terms of the policies referenced in this certificate control over the terms of the certificate.

Insured: _____

Street/Mailing Address: _____

City/State/Zip: _____

Phone Number: () - _____

WORKERS' COMPENSATION INSURANCE COVERAGE:

Endorsed with a Waiver of Subrogation in favor of TxDOT.

Carrier Name:			Carrier Phone #: () -		
Address:			City, State, Zip:		
Type of Insurance	Policy Number	Effective Date	Expiration Date	Limits of Liability:	
Workers' Compensation				Not Less Than: Statutory - Texas	

COMMERCIAL GENERAL LIABILITY INSURANCE:

Carrier Name:			Carrier Phone #: () -		
Address:			City, State, Zip:		
Type of Insurance:	Policy Number:	Effective Date:	Expiration Date:	Limits of Liability:	
Commercial General Liability Insurance				Not Less Than: \$ 600,000 each occurrence	

SELF-INSURED

BUSINESS AUTOMOBILE POLICY:

Carrier Name:			Carrier Phone #: () -		
Address:			City, State, Zip:		
Type of Insurance:	Policy Number:	Effective Date:	Expiration Date:	Limits of Liability:	
Business Automobile Policy				Not Less Than: \$ 600,000 combined single limit	

UMBRELLA POLICY (if applicable):

Carrier Name:			Carrier Phone #: () -		
Address:			City, State, Zip:		
Type of Insurance:	Policy Number:	Effective Date:	Expiration Date:	Limits of Liability:	
Umbrella Policy					

Should any of the above described policies be cancelled before the expiration date thereof, notice will be delivered in accordance with the policy provisions.

THIS IS TO CERTIFY to the Texas Department of Transportation acting on behalf of the State of Texas that the insurance policies named are in full force and effect. If this form is sent by facsimile machine (fax), the sender adopts the document received by TxDOT as a duplicate original and adopts the signature produced by the receiving fax machine as the sender's original signature.

Agency Name Address City, State, Zip Code

() -
Authorized Agent's Phone Number Authorized Agent Original Signature Date

The Texas Department of Transportation maintains the information collected through this form. With few exceptions, you are entitled on request to be informed about the information that we collect about you. Under §§552.021 and 552.023 of the Texas Government Code, you also are entitled to receive and review the information. Under §559.004 of the Government Code, you are also entitled to have us correct information about you that is incorrect.

Fax completed form to: 512/416-2536

NOTES TO AGENTS:

Agents must provide all requested information then either fax or mail this form directly to the address listed below.

Pre-printed limits are the minimum required; if higher limits are provided by the policy, enter the higher limit amount and strike-through or cross-out the pre-printed limit.

To avoid work suspension, an updated insurance form must reach the address listed below one business day prior to the expiration date. Insurance must be in force in order to perform any work.

Binder numbers are not acceptable for policy numbers.

The certificate of insurance, once on file with the department, is adequate for subsequent department contracts provided adequate coverage is still in effect. Do not refer to specific projects/contracts on this form.

List the contractor's legal company name, including the DBA (doing business as) name as the insured. If a staff leasing service is providing insurance to the contractor/client company, list the staff leasing service as the insured and show the contractor/client company in parenthesis.

The TxDOT certificate of insurance form is the only acceptable proof of insurance for department contracts.

List the contractor's legal company name, including the DBA (doing business as) name as the insured or list both the contractor and staff leasing service as insured when a staff leasing service is providing insurance.

Over-stamping and/or over-typing entries on the certificate of insurance are not acceptable if such entries change the provisions of the certificate in any manner.

This form may be reproduced.

DO NOT COMPLETE THIS FORM UNLESS THE WORKERS' COMPENSATION POLICY IS ENDORSED WITH A WAIVER OF SUBROGATION IN FAVOR OF TxDOT.

The **SIGNATURE** of the agent is required.

CERTIFICATE OF INSURANCE REQUIREMENTS:

WORKERS' COMPENSATION INSURANCE:

SELF-INSURED

The contractor is required to have Workers' Compensation Insurance if the contractor has any employees including relatives.

The word STATUTORY, under limits of liability, means that the insurer would pay benefits allowed under the Texas Workers' Compensation Law.

GROUP HEALTH or ACCIDENT INSURANCE is not an acceptable substitute for Workers' Compensation.

COMMERCIAL GENERAL LIABILITY INSURANCE:

MANUFACTURERS' or CONTRACTOR LIABILITY INSURANCE is not an acceptable substitute for Comprehensive General Liability Insurance or Commercial General Liability Insurance.

BUSINESS AUTOMOBILE POLICY:

If coverages are specified separately, they must be at least these amounts:

Bodily Injury	\$500,000 each occurrence
	\$100,000 each occurrence
Property Damage	\$100,000 for aggregate

PRIVATE AUTOMOBILE LIABILITY INSURANCE is not an acceptable substitute for a Business Automobile Policy.

MAIL ALL CERTIFICATES TO:

Texas Department of Transportation
CST — Contract Processing Unit (RA/200 — 1st Fl.)
125 E. 11th Street
Austin, TX 78701-2483
512/416-2540 (Voice), 512/416-2536 (Fax)

EXHIBIT E
ATTACHMENT A (FHWA ADDITIONAL
REQUIREMENTS)

ATTACHMENT A

Inasmuch as this project is on the Federal-Aid highway system, the following additional requirements as applicable with the Federal Highway Administration's Title 23, Code of Federal Regulations, § 710.

1. Any significant revision in the design or construction of the facility shall receive prior approval by the Texas Department of Transportation subject to concurrence by the FHWA.
2. Any change in the authorized use of airspace shall receive prior approval by the Texas Department of Transportation subject to concurrence by the FHWA.
3. The airspace shall not be transferred, assigned or conveyed to another party without prior Texas Department of Transportation approval subject to concurrence by the FHWA.
4. This agreement will be revocable in the event that the airspace facility ceases to be used or is abandoned.