

I T E M 2 6 . 2

# Special Privilege





# Recommendation | Public Input

2

**DCC/Planning Division recommendation:**  
**Approval**

**Public Input:**  
**N/A**

## **Strategic Goal #3 Promote the Visual Image of El Paso**

- 3.1 Provide business friendly permitting and inspection processes
- 3.2 Improve the visual impression of the community





# License Details

## Applicant:

- Mills Plaza Parking II, LP

## Location:

- 104 S. El Paso

## Type of Encroachment

- Proposed aerial encroachment is for a aerial span across San Antonio St. which will serve as a pathway linking two new parking garages, for the Plaza Hotel. The area of encroachment is 8,400 sq. ft.

## Term

- Fifteen years with the option of one fifteen-year renewal;
- Renewals are administrative (do not require Council approval)

## Fees

- \$10,500.00 per year

## Staff Recommendation

- Approval



NESV2019-00005



This map is designed for illustrative purposes only. The features depicted here are approximate and more site-specific studies may be required to draw accurate conclusions. Enlargements of the map to scales greater than its original can introduce errors and may lead to misinterpretations of the data. The Planning & Inspections Department Planning Division makes no claim to its accuracy or completeness.

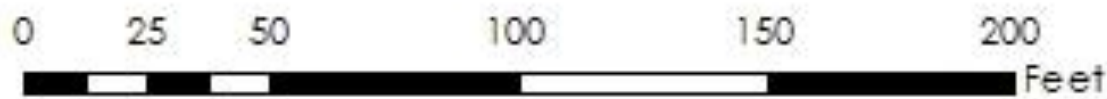



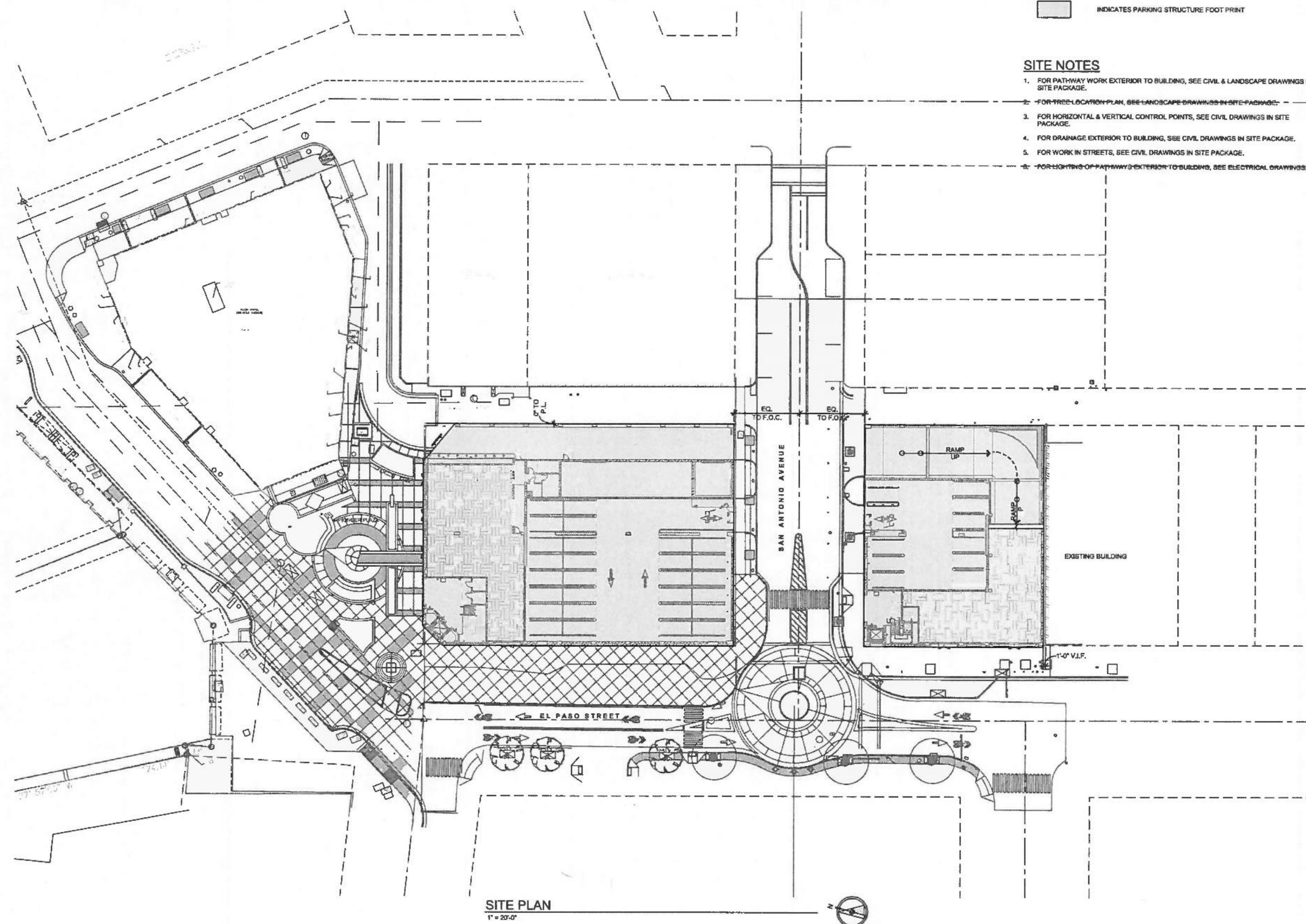

### LEGEND

 INDICATES PARKING STRUCTURE FOOT PRINT

## SITE NOTES

1. FOR PATHWAY WORK EXTERIOR TO BUILDING, SEE CIVIL & LANDSCAPE DRAWINGS IN SITE PACKAGE.
2. FOR TREE LOCATION PLAN, SEE LANDSCAPE DRAWINGS IN SITE PACKAGE.
3. FOR HORIZONTAL & VERTICAL CONTROL POINTS, SEE CIVIL DRAWINGS IN SITE PACKAGE.
4. FOR DRAINAGE EXTERIOR TO BUILDING, SEE CIVIL DRAWINGS IN SITE PACKAGE.
5. FOR WORK IN STREETS, SEE CIVIL DRAWINGS IN SITE PACKAGE.
6. FOR LIGHTING OF PATHWAYS EXTERIOR TO BUILDING, SEE ELECTRICAL DRAWINGS.

Architects • Engineers • Planning Professionals

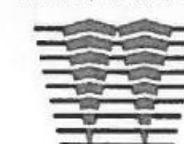

**WATRY DESIGN, INC.**

San Jose, California  
Irvine, California  
Dallas, Texas

[watrydesign.com](http://watrydesign.com)

## SITE PLAN

**PLAZA HOTEL  
PARKING STRUCTURE**  
EL PASO, TEXAS

[illegible]

### PLAN CHECK SUBMITTAL

JOB NO.: 17-090

DATE : 06/08/2018

DESIGN: M. NIELSON

DRAWN: E. TY

CHK. BY: M. PENDERGRASS

SCALE : 1" = 20'-0"

\_\_\_\_\_

SHEET:

A11

### AI.1

\_\_\_\_\_

\_\_\_\_\_

---



**VIEW 3****12.05.2018****Plaza Hotel Parking Structure El Paso, Texas**digital imaging studio 







THANK YOU

