



Community Recreation Centers Chamizal/Alameda/Lomaland

Request for Approval Construction Manager GMP Amendment

Strategic Plan Goal:

4) Enhance El Paso's Quality of Life through Recreational, Cultural and Educational Environments



Community Recreation Centers Chamizal/Alameda/Lomaland

General Scope of Work

- ☐ Design Multi Generational Community Recreation Center
- ☐ Three Locations District 3 (Alameda), District 7 (Lomaland) and District 8 (Chamizal)
- ☐ Two Projects are designated to have public library spaces – Alameda and Chamizal
- ☐ Green Globe Certification all three projects
- ☐ Public Art Component is included



Community Recreation Centers

Alameda/Chamizal/Lomaland

General Scope of Work

- ☐ **Alameda to include Flat Field with Site Amenities and Parking**
- ☐ **Chamizal will have adjacent Spray Park and Park Amenities**
- ☐ **Lomaland will have renovated Flat Field/Storm Water Retention,
New Bridge access to Residential Area and Improved Parking**



Community Recreation Centers

Alameda/Chamizal/Lomaland

General Scope of Work

Basic Program

- Gymnasium Space
- Multi Purpose Area
- Small Support Kitchen
- Fitness Areas
- Locker Room and Storage Support Areas
- Lobby/Wi Fi Lounge Area
- Two Centers – Alameda & Chamizal
with Community Libraries





Community Recreation Centers Chamizal/Alameda/Lomaland

Alameda Recreation Center/Library with Flat Field Project Location

7380 Alameda 4.49 acres



Alameda Projects Location
District 3

"Delivering Outstanding Services"



Community Recreation Centers Chamizal/Alameda/Lomaland

Alameda Recreation Center/Library Site Layout





Alameda Recreation Center/Library Floor Plan





Community Recreation Centers Chamizal/Alameda/Lomaland

Alameda Recreation Center Front View





Community Recreation Centers Chamizal/Alameda/Lomaland

Alameda Recreation Center South Entrance





Community Recreation Centers Chamizal/Alameda/Lomaland

Alameda Recreation Center/Library Public Art Concept

wide angle view of the building



Horizontal sections of the forms are made of laser cut acrylic. The number of sections is based on the desired curvature of the surface. Optical fibers are threaded through the horizontal sections and return back to the top of the forms where they attach to the light boxes.

The forms will continue all the way to the ceiling. When they are flushed to the ceiling, they appear as if they are extensions of the architecture of the library that turn to sculptural volumes.





Community Recreation Centers Chamizal/Alameda/Lomaland

Alameda Recreation Center/Library Public Art Concept

alternative forms



More vibrant colors of lights for daytime





Community Recreation Centers Chamizal/Alameda/Lomaland

Chamizal Recreation Center/Library Project Site

2119 Cypress



Chamizal Location



Existing Structures



Community Recreation Centers Chamizal/Alameda/Lomaland

Chamizal Recreation Center/Library and Park Site Layout

**New Rec Ctr
and Library**



**New
Neighborhood
Park**



Community Recreation Centers

Chamizal/Alameda/Lomaland

Chamizal Recreation Center/Library Combo Floor Plan

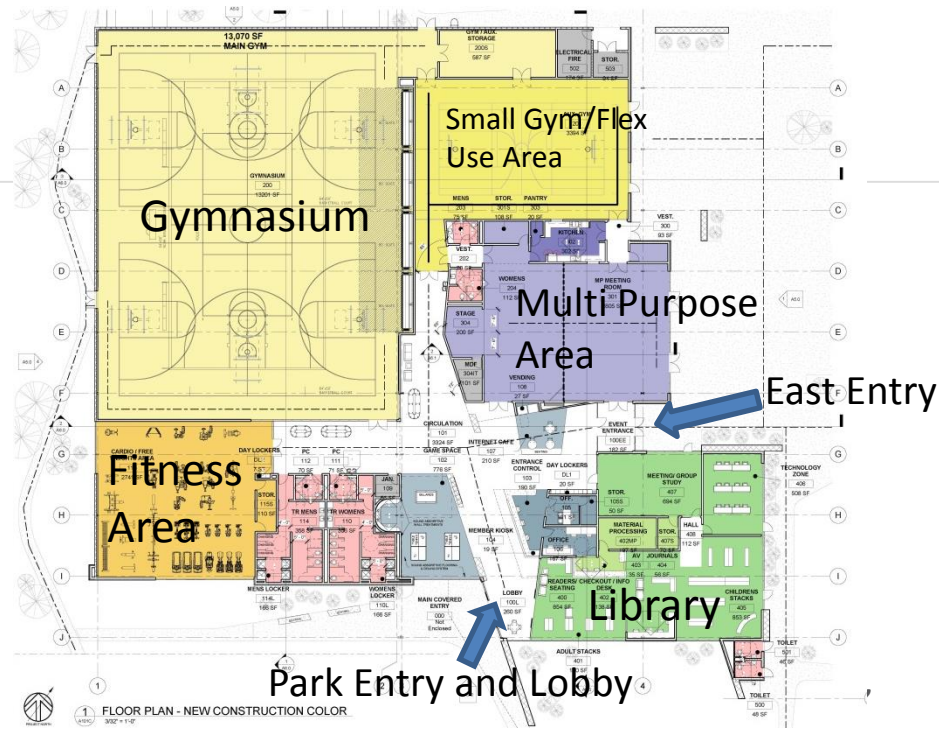



Community Recreation Centers

Chamizal/Alameda/Lomaland

Chamizal Recreation Center/Library Parking Area East Entrance View





Community Recreation Centers

Chamizal/Alameda/Lomaland

Chamizal Recreation Center/Library Cypress Street View





Community Recreation Centers

Chamizal/Alameda/Lomaland

Chamizal Recreation Center/Library Public Art Mural View



"Delivering Outstanding Services"



Lomaland Park 10.9 acres



"Delivering Outstanding Services"



Lomaland Recreation Center Site Layout





Community Recreation Centers

Chamizal/Alameda/Lomaland

Lomaland Recreation Center First Floor Plan

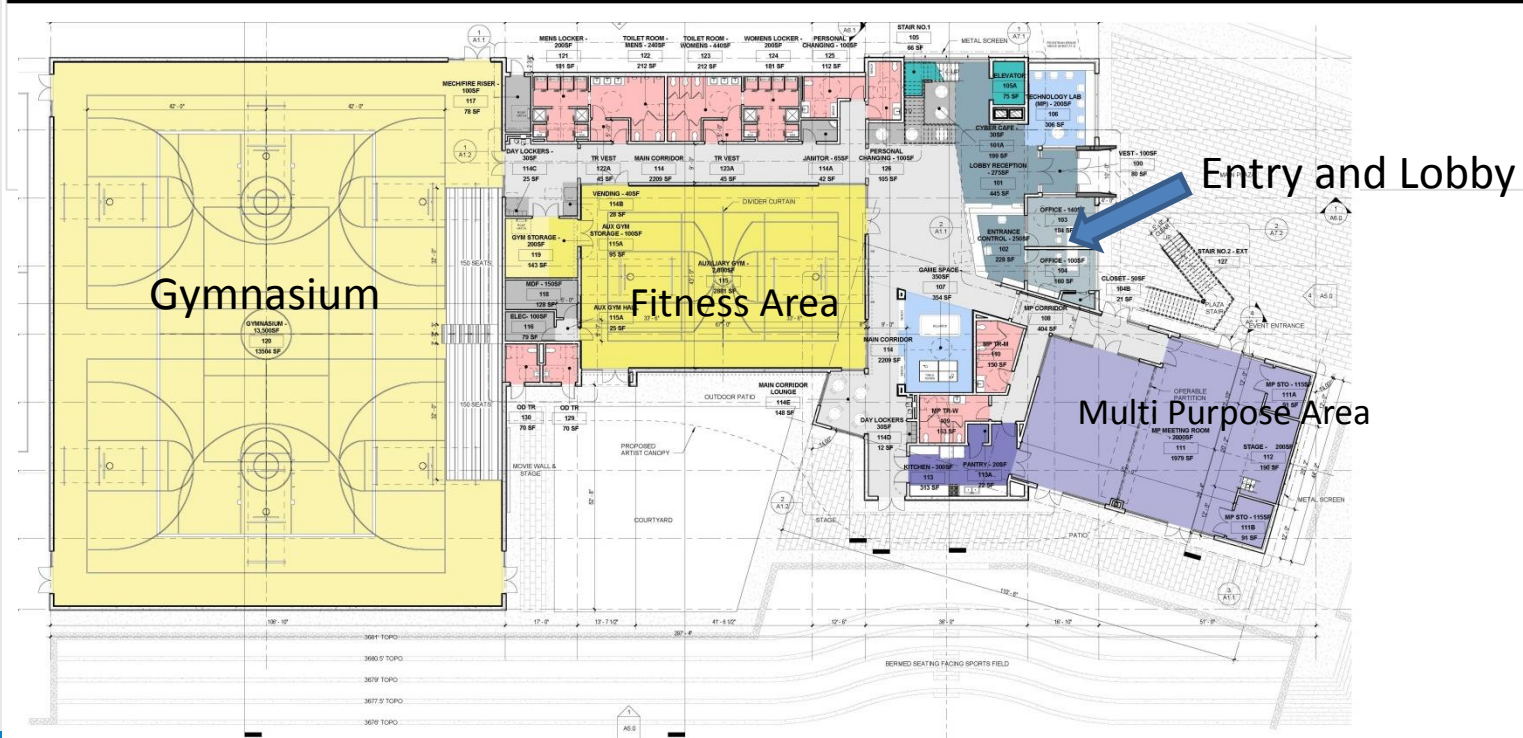



Community Recreation Centers Chamizal/Alameda/Lomaland

Lomaland Second Level Terrace Deck Plan

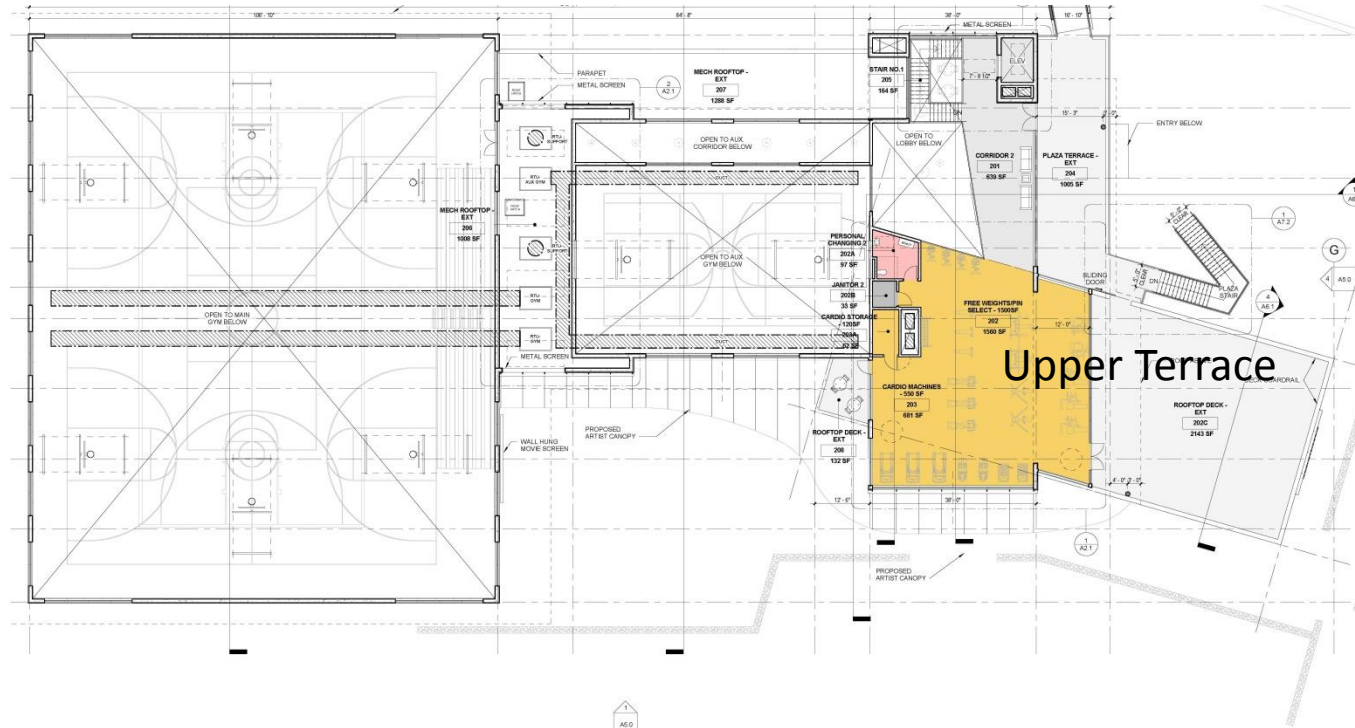



Community Recreation Centers

Chamizal/Alameda/Lomaland

Lomaland Recreation Center Main Entrance View





Community Recreation Centers

Chamizal/Alameda/Lomaland

Lomaland Recreation Center General View From Park





Community Recreation Centers Chamizal/Alameda/Lomaland

Lomaland Recreation Center Public Art Concept Plan

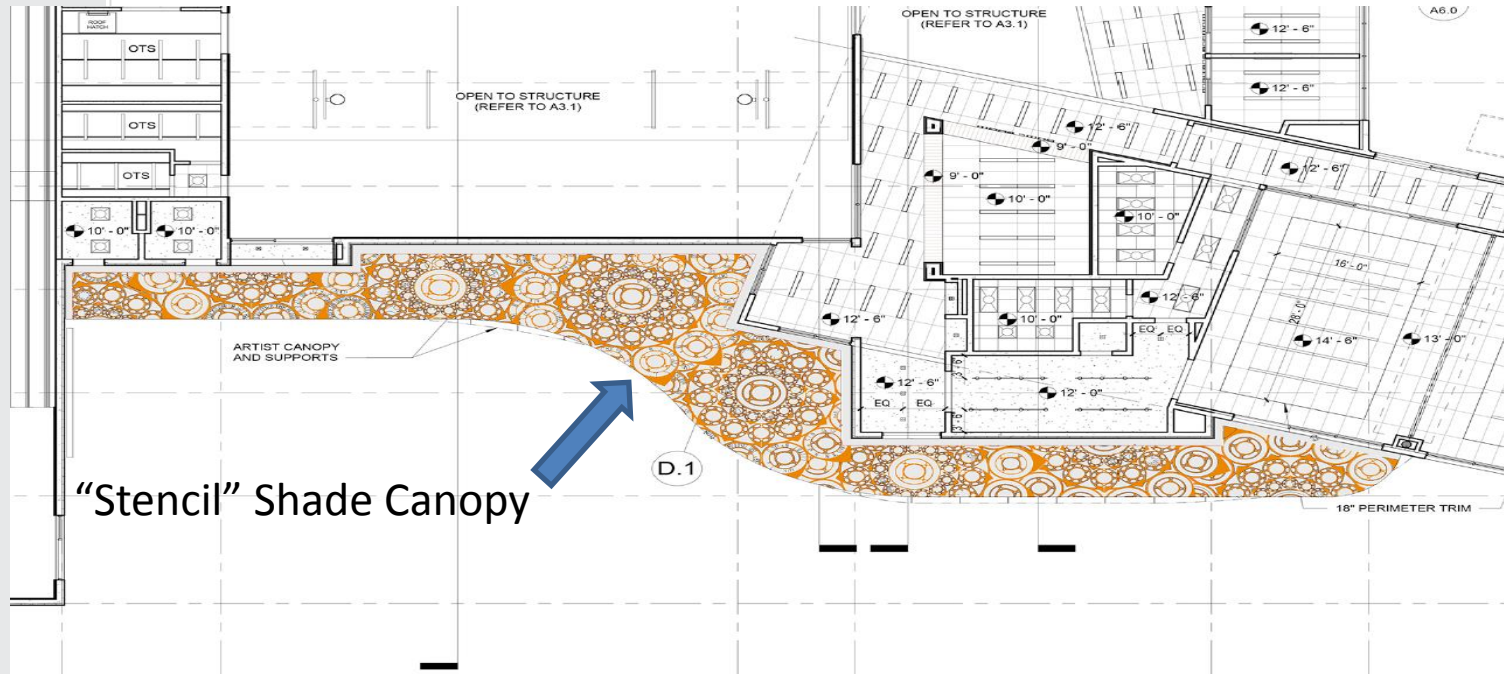

"Delivering Outstanding Services"



Community Recreation Centers

Alameda/Chamizal/Lomaland

General Schedule

- ☐ **Chamizal Asbestos Abatement, Demolition and Preparation**

Project Start –

June 2018

- ☐ **Pre-Final Design all Projects -**

February 2018

- ☐ **Final Design and Estimating –**

June - July 2018

- ☐ **Bidding and Construction Start -**

September 2018

- ☐ **Commissioning and Occupancy -** **End of 2019/Spring 2020**

Meets the “20 in 20” Goal



Community Recreation Centers

Alameda/Chamizal/Lomaland

Budget – Upfront Costs

<input type="checkbox"/> A/E, Admin and Mangm't Costs	\$ 6,091,694.00
<input type="checkbox"/> Site Acquisition and Preparation	\$ 4,475,689.00
<input type="checkbox"/> <u>FF&E, IT</u>	<u>\$ 1,586,737.00</u>
 Subtotal	 \$ 12,154,120.00



Community Recreation Centers

Alameda/Chamizal/Lomaland

Budget – Construction Costs and Total

<input type="checkbox"/> CM Admin (Bonds, Insurance)	\$ 1,346,884.00
<input type="checkbox"/> Construction	\$ 19,264,410.00
<input type="checkbox"/> <u>CMAR Contingency/Allowances</u>	<u>\$ 1,924,259.00</u>
GMP (CMAR Construction Maximum Amount)	<u>\$ 22,535,553.00</u>
PROJECT TOTAL (Upfront and Const. Costs)	\$ 34,689,672.00



Community Recreation Centers Alameda/Chamizal/Lomaland

Budget – Construction Costs and Total

PROJECT TOTAL (Upfront and Const. Costs)	\$ 34,689,672.00
Available Budget	<u>\$ 34,862,360.00</u>
Remaining Budget	\$ 172,688.00



Community Recreation Centers Chamizal/Alameda/Lomaland

Request for Approval Construction Manager GMP Amendment

Comments