

I T E M

# Detailed Site Development Plan

Boxwood Circle and Bois D'Arc Drive



# Recommendation | Public Input

2

## **Planning Division and DCC recommendation:**

Approval

## **CPC Vote:**

Approval (7-0)

## **Public Input:**

- The Planning Division has not received communication support or opposition to the detailed site development plan.

### **Strategic Goal #3 Promote the Visual Image of El Paso**

3.1 Provide business friendly permitting and inspection processes

3.2 Improve the visual impression of the community



# PZDS19-00025

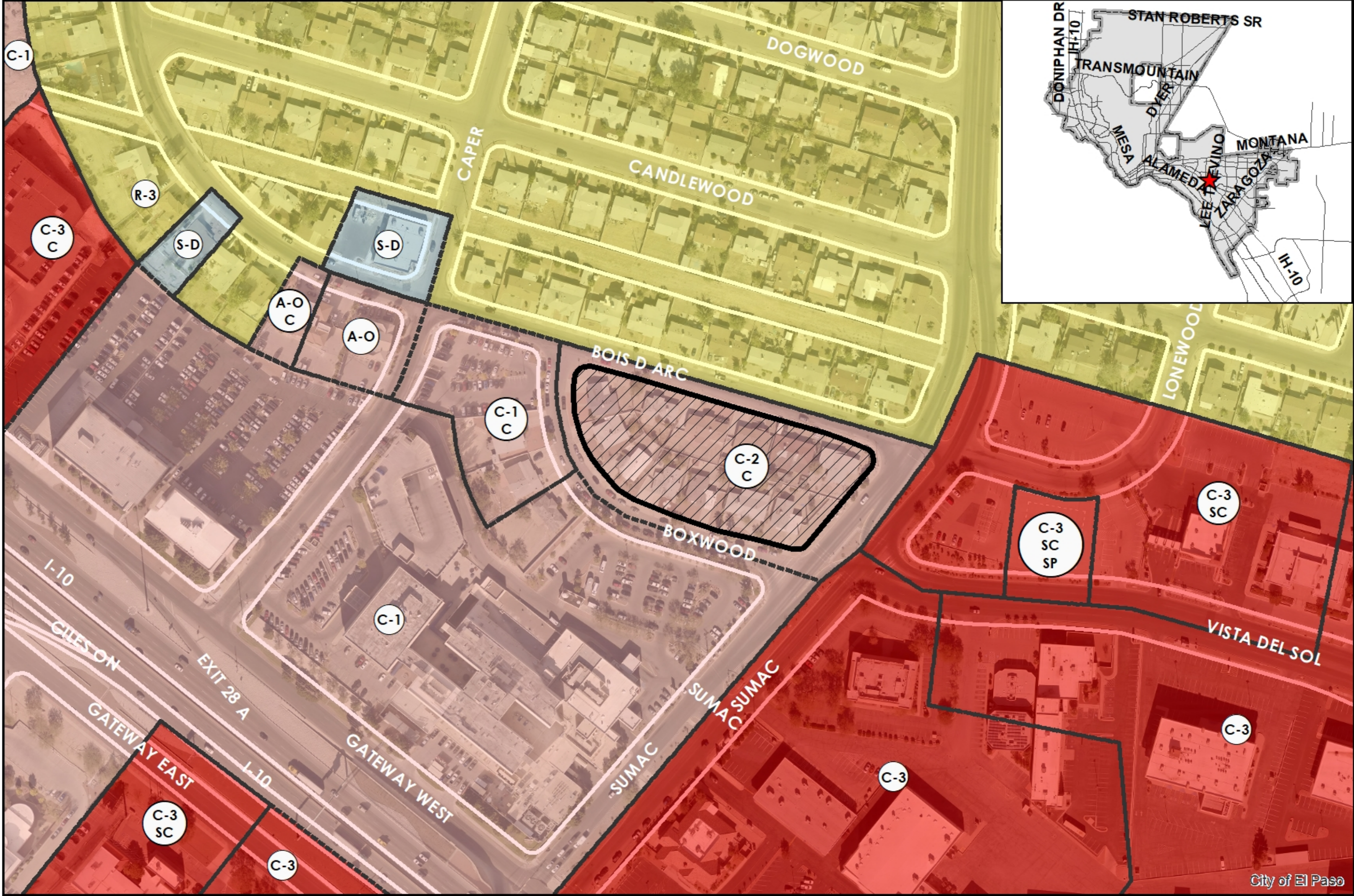

This map is designed for illustrative purposes only. The features depicted here are approximate and more site-specific studies may be required to draw accurate conclusions. Enlargements of this map to scales greater than its original can induce errors and may lead to misinterpretations of the data. The Planning & Inspections Department Planning Division makes no claim to its accuracy or completeness.



 Subject Property

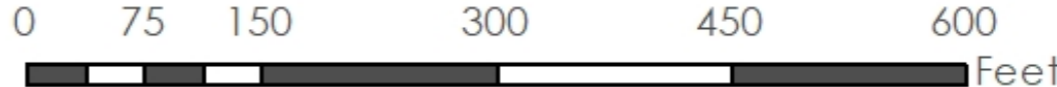

# PZDS19-00025

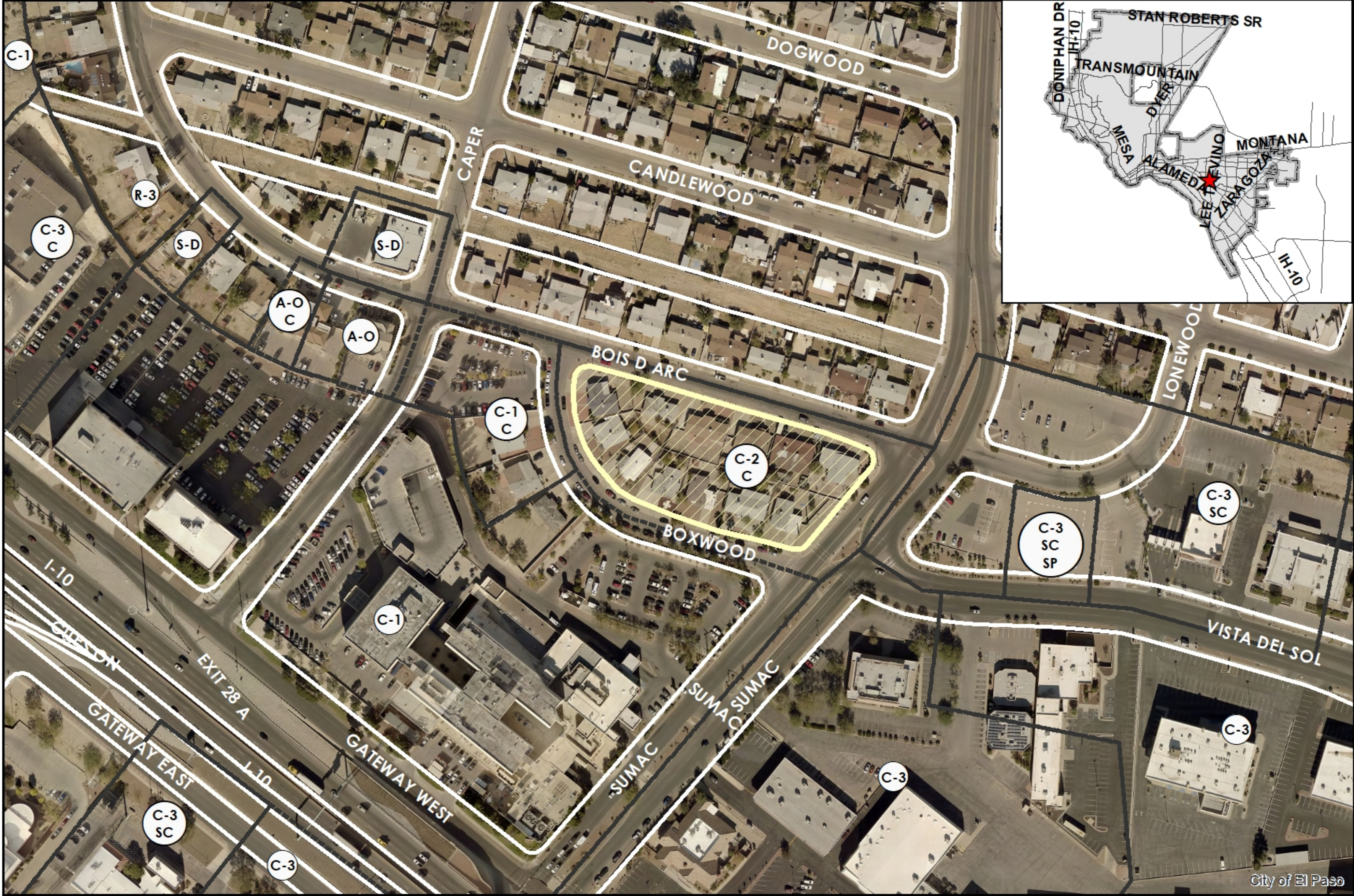

This map is designed for illustrative purposes only. The features depicted here are approximate and more site-specific studies may be required to draw accurate conclusions. Enlargements of this map to scales greater than its original can induce errors and may lead to misinterpretations of the data. The Planning & Inspections Department Planning Division makes no claim to its accuracy or completeness.



 Subject Property

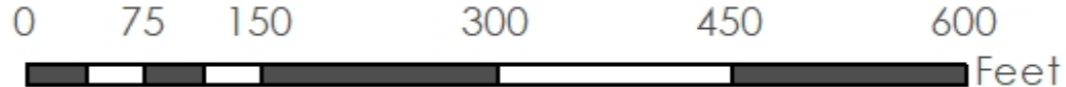

ALL LOTS 1-12 OF BLOCK-8, EASTWOOD SECTION-1,  
AN ADDITION TO THE CITY OF EL PASO,  
EL PASO COUNTY TEXAS  
89,229.09 SQ.FT  
2.0484 AC

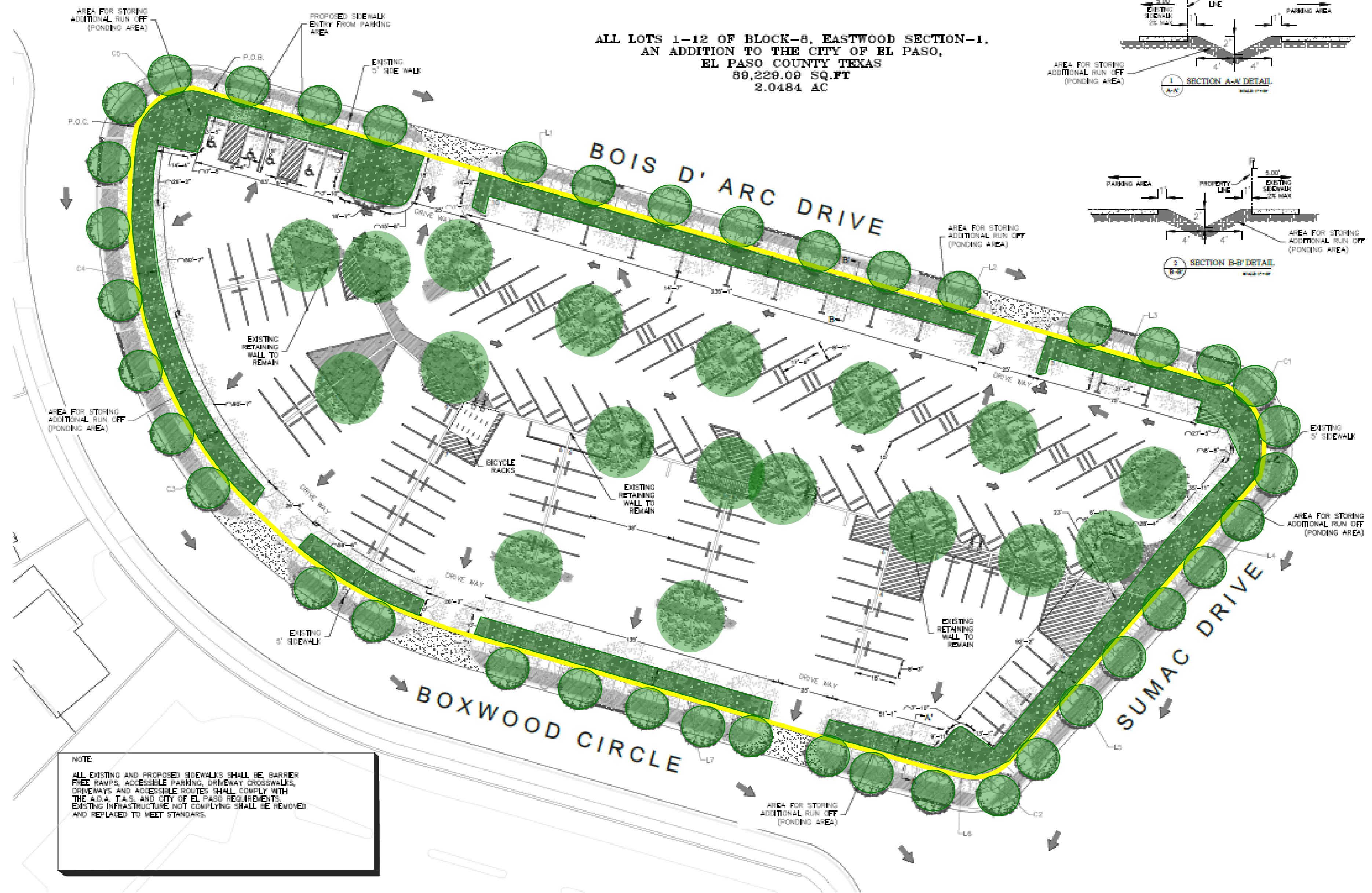
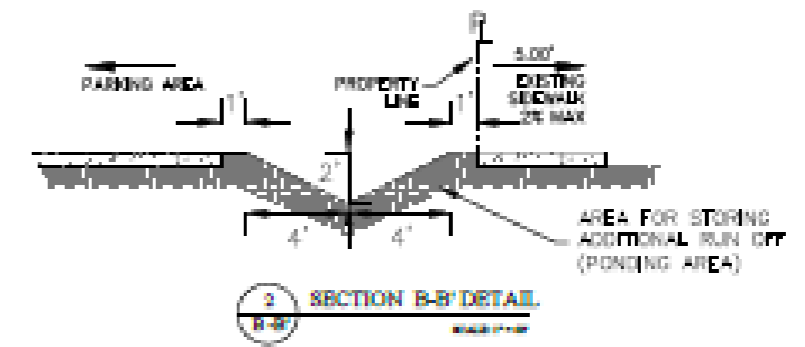
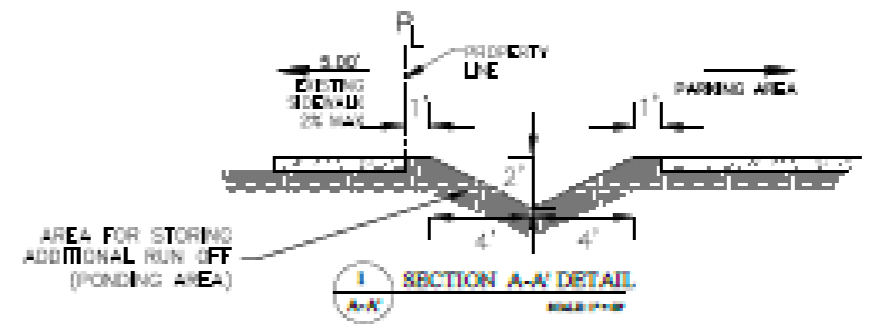

NOTE  
ALL EXISTING AND PROPOSED SIDEWALKS SHALL BE BARRIER FREE RAMPS. ACCESSIBLE PARKING, DRIVEWAY CROSSWALKS, DRIVEWAYS AND ACCESSIBLE ROUTES SHALL COMPLY WITH THE A.D.A., T.A.S. AND CITY OF EL PASO REQUIREMENTS. EXISTING INFRASTRUCTURE NOT COMPLYING SHALL BE REMOVED AND REPLACED TO MEET STANDARDS.

# PZDS19-00025



This map is designed for illustrative purposes only. The features depicted here are approximate and more site-specific studies may be required to draw accurate conclusions. Enlargements of this map to scales greater than its original can induce errors and may lead to misinterpretations of the data. The Planning & Inspections Department Planning Division makes no claim to its accuracy or completeness.

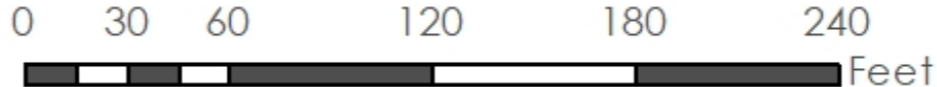

City of El Paso





# PZDS19-00025



This map is designed for illustrative purposes only. The features depicted here are approximate and more site-specific studies may be required to draw accurate conclusions. Enlargements of this map to scales greater than its original can induce errors and may lead to misinterpretations of the data. The Planning & Inspections Department Planning Division makes no claim to its accuracy or completeness.

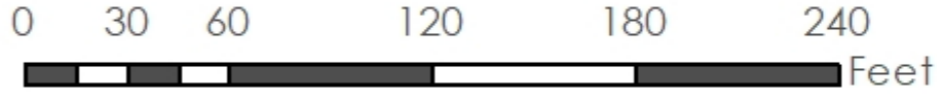

THANK YOU

